

Charisma



Concorde

REISEMOBILE AUS LEIDENSCHAFT

The Concorde Charisma – the Motorhome of the Year.

A motorhome must be something quite out of the ordinary for the readers of Europe's largest motorhome magazine to decide that it has earned the title "Motorhome of the Year" - particularly when it comes to top-of-the range "A" class motorhomes valued at 100,000 euros and more. And the Concorde Charisma is something truly extraordinary because it heralds the beginning of a completely new motorhome concept. A concept that is no longer adapted to the technical features of the basic vehicle, but is exclusively oriented to the most important component of all - you. Furthermore, it is packed with a multitude of as yet virtually inconceivable technical innovations. The Charisma also offers something as yet unparalleled in terms of appearance: the perfect synthesis of technology and design. The Concorde Charisma - truly a motorhome born of passion.







01 **DESIGN**

Motorhomes and design – a more than exciting liaison in the new Concorde Charisma.

The Charisma is probably the first motorhome that is a great deal more than just a vehicle. The Charisma is the manifestation of its owner's style consciousness. Not only on the outside, where the modern bus design with large-format glass panels, the front section with its friendly smile and optional bi-xenon headlamps and the decidedly elegant body contours provide a welcome change from the colourless monotony of conventional "A" class motorhomes. On the contrary: the stylish elegance is seamlessly carried over to the interior. Stylish - sensuous - Charisma.



DESIGN PERFECTION RIGHT DOWN TO THE FINEST DETAIL

Can a motorhome be beautiful? It not only can be, it must be. In this respect Concorde goes a great deal further with the new Charisma: the designers did not merely focus their attention on such eye-catching elements as the fine cherry-wood furniture, the inviting bright microfibre upholstery or real glass cabinet doors. No, the true beauty of the Charisma goes much deeper than that. It is evident in the meticulously designed details – in the perfect craftsmanship to the same extent as the uncompromisingly exclusive use of top-quality components and materials. After all, why compromise here when only the best is good enough at home.







The image shows the interior of a motorhome. In the foreground, a polished wooden dining table is set with a stack of white bowls, a glass of water, and a plate of sliced watermelon. Two tall, slender wooden vases with orange flowers stand on the table. Behind the table is a white leather-upholstered seat. To the left, a window with light-colored curtains is visible. In the background, a glass display cabinet filled with wine glasses is illuminated with blue light. The overall atmosphere is warm and luxurious.

DREAMS COME TRUE

The new Charisma offers room for much more than just two, three or four people. It offers you space to enjoy your life, your hobbies and your dreams. All you have to do is decide on one of the 16 possible layouts and at least one of your dreams will soon come true.







MUCH MORE THAN JUST SOMEWHERE TO COOK

That Concorde owners know how to enjoy life is already made obvious by the fact that they own Concordes. One of the good reasons behind the Concorde developers' decision to assign a central role to the kitchen in the new Charisma. The cooking area opens out towards the seating elements, creating a unique feeling of spaciousness; stainless steel combines with synthetic stone to generate enthusiasm in even the most technologically minded gourmets. The Charisma - don't just cook, enjoy.



02 EQUIPMENT

There's no such word as
“impossible” when it comes
to the new Charisma.

Every person has different ideas and wishes – relating to clothes, food, holidays and, of course, to motorhomes. A situation to which Concorde responds with such a variety of equipment options that is hard to match, even in vehicles that are much more expensive. Apart from the standard features and diverse interior packages, a number of optional features, such as air suspension for the rear axle, a differential lock, bi-xenon headlights and an automated six-speed transmission are just waiting to be of assistance to you. The Charisma – as individual as you are.



YOU NEED REST TO GATHER YOUR STRENGTH

Even the most alert motorhome travellers spend most of their time in bed. This is why the beds in the Charisma are dimensioned in such way as to put even some of their counterparts at home in the shade. And all beds are fitted out with Lattoflex slatted frames and mattresses because compromises are unacceptable to Concorde. So goodnight and sweet dreams!









WASHING IS A THING OF THE PAST

Nothing but the best for our customers - a principle that was first and foremost in the development of the Charisma. It also applies, and by no means least, to the facilities in the bathroom, an area which is frequently given too little attention. Concorde adopts a different attitude: the spacious luxury bathroom in the Charisma pampers you with dimensions that are a match for any "normal" bathroom. And the parallels between mobile and permanent homes don't stop there: the elegant household corner shower cubicle and Corisan washbasin would be an asset to any home. The Concorde Charisma - unreserved relaxation.





WELCOME HOME

The Bar suite with rotating, microfibre-covered individual seats and highly polished tabletop generate an atmosphere of well-being that you would otherwise only find within your own four walls at home. So be careful: you might find that your Charisma soon becomes much more than just a substitute home.



CONCORDE. REISEMOBILE AUS LEIDENSCHAFT

READY, STEADY, GO!

Comfortable spaciousness is indisputably one of the particularly strong points in the Charisma's favour. But room alone is not everything. Optimum adaptation of available space to suit your specific needs and wishes is almost more important. This is why the Charisma offers a Lounge version with lengthwise table in addition to the Bar suite. After all, your Charisma should adapt to you, not the other way round.





**TURNING COOKING INTO A
TRULY ENJOYABLE EXPERIENCE**

The modern, ergonomically designed kitchenette demonstrates the harmony that can be achieved between perfect function and design. The fully extendable drawers with "cushion close" function, the wall cupboard with glass front and the built-in refrigerator leave nothing to be desired.





03 TECHNOLOGY

The new Charisma – a veritable bombardment of technical innovations.

A genuine motorhome experience can only be achieved with perfected technology working discretely in the background to ensure that driver and passengers are able to concentrate completely on enjoying their journey. The Concorde developers have therefore packed numerous technological innovations into the Charisma. Innovations which do exactly what they should and make your life easier without you even noticing them. After all, you'd much rather be thinking about your holiday than about your motorhome, wouldn't you?



SPACIOUS REAR GARAGE WITH 4.4 M³ LOADING VOLUME



BEIDSEITIG ZUGÄNGIGER STAURAUM IM DOPPELBODEN

BIG FLAPS WITH LOTS OF SPACE BEHIND THEM

The combination of what you see and what you don't is what makes the Charisma so fascinating: powder-coated flaps with welded frames, finished off with hard-wearing locks and aluminium fasteners. Behind these, vast storage areas that allow you to carry as much luggage with you as you like while ensuring that everything stays where it belongs.

PANORAMIC ROOF HATCH WITH LIGHTING



CONCORDE. REISEMOBILE AUS LEIDENSCHAFT

CHECK CONTROL PANEL WITH LCD PANEL TO DISPLAY SUCH INFORMATION AS TANK LEVELS, BATTERY VOLTAGES AND GAS LEVEL



ELECTRICALLY RETRACTABLE 20" FLAT PANEL DISPLAY



175 L REFRIGERATOR



HIGH END EVERYWHERE YOU LOOK

The good thing about it is the goodness that's in it - a well-known advertising slogan that certainly applies to the Concorde Charisma as well. Packed with the best products from front to rear, the Charisma is a convincing motorhome whichever way you look at it. Concorde customers are not willing to accept compromises either. After all, if they were, they wouldn't have decided in favour of driving a Concorde. The new Charisma - no room for compromises.

A photograph of the interior of a Concorde motorhome at night. The view is from the passenger side looking towards the driver's seat. Two cream-colored leather seats with black accents are visible. The dashboard is illuminated with a warm orange glow, featuring several analog gauges and a digital display. The steering wheel is black with a silver center. The floor is a light-colored wood or laminate. The large front window shows a dark night sky with stars.

DRIVER-ACTIVE DASHBOARD,
SPECIALLY DEVELOPED FOR THE
CHARISMA

CONCORDE. REISEMOBILE AUS LEIDENSCHAFT



ROBUST, OFF-CENTRE FASTENING BOLTS



USER-PROGRAMMABLE COMBINATION LOCK

ALWAYS A FEW STEPS AHEAD

Enjoy ergonomic perfection in the Charisma - the self-contained dashboard ensures optimum readability, the gear lever is within easy reach and the handbrake has been moved over to the left. It goes without saying that the high technical standard is maintained by the door to the living area of the Charisma. The electromagnetic interlocking facility, the car door lock with sensor technology, the insulated windows made of safety glass and, of course, the highlight - the user-programmable safe-type combination lock - all attest to an as yet unparalleled safety standard.



INSULATED WINDOWS MADE OF SAFETY GLASS



"SECURITY PLUS" DOOR TO THE LIVING AREA



YOU ARE THE CENTRE OF ATTENTION IN THE CHARISMA

The Charisma is the first motorhome in its class to offer a single-level floor throughout. The result: a completely insulated driving cab and a virtually unique feeling of spaciousness. Everything is just a little bit better in the Charisma. Better vision, for example. The idea is as easy as it is ingenious - if you sit higher, you can see more. How much more can be shown by a simple comparison: driving a conventional "A" class motorhome, the road is only visible 7.5 to 11 metres ahead, whereas the driver of the new Charisma can already see the road 2.8 metres ahead.





04 UPHOLSTERY AND FABRICS



DOVE BLUE



MINT GREEN

* All colours also available in leather



05 LAYOUTS

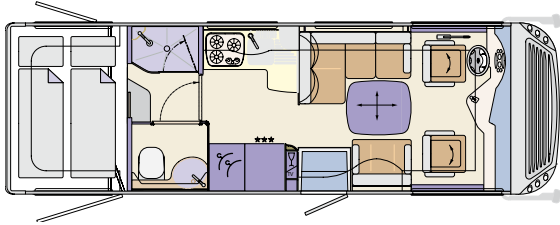

CHARISMA 741H
Iveco Daily: 7480 x
2380 x 3290 mm

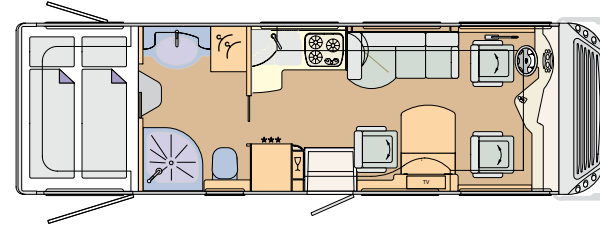

CHARISMA 790H
Iveco Daily: 7980 x
2380 x 3290 mm,
MAN: 8120 x 2380
x 3460 mm

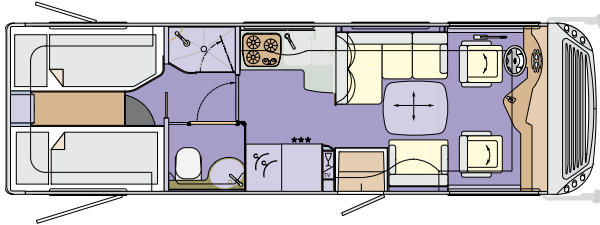

CHARISMA 791L
Iveco Daily: 7980 x
2380 x 3290 mm,
MAN: 8120 x 2380
x 3460 mm

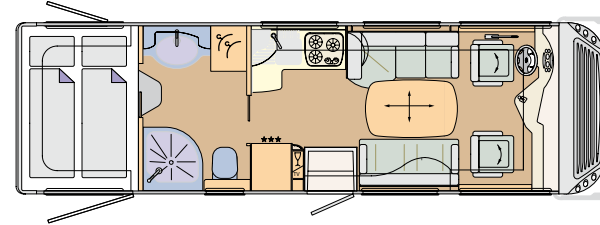

**CHARISMA 790H
LOUNGE** Iveco Daily:
7980 x 2380 x 3290
mm, MAN: 8120 x
2380 x 3460 mm

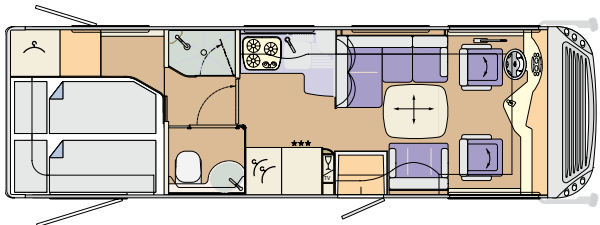

CHARISMA 791F
Iveco Daily: 7980 x
2380 x 3290 mm,
MAN: 8120 x 2380
x 3460 mm

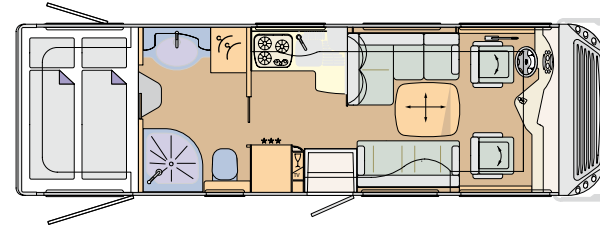

**CHARISMA 790H
C-LOUNGE** Iveco
Daily: 7980 x 2380 x
3290, MAN: 8120 x
2380 x 3460 mm

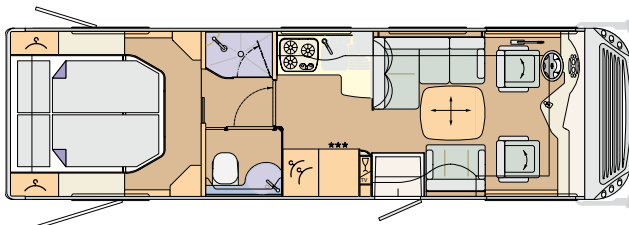

CHARISMA 841M
Iveco Daily: 8480 x
2380 x 3290 mm,
MAN: 8620 x 2380
x 3460 mm

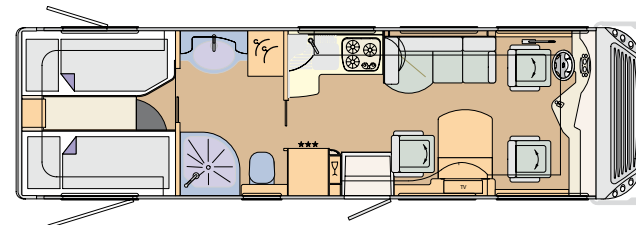

CHARISMA 840L
Iveco Daily: 8480 x
2380 x 3290 mm,
MAN: 8620 x 2380
x 3460 mm

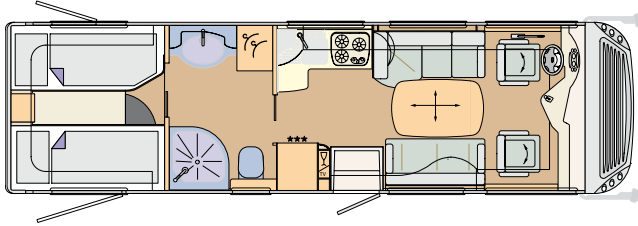

**CHARISMA 840L
LOUNGE** Iveco Daily:
8480 x 2380 x 3290
mm, MAN: 8620 x
2380 x 3460 mm

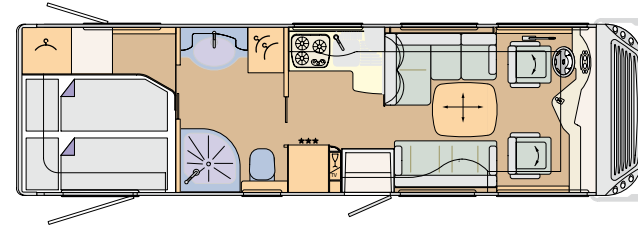

**CHARISMA 840F
C-LOUNGE** Iveco
Daily: 8480 x 2380 x
3290, MAN: 8620 x
2380 x 3460 mm

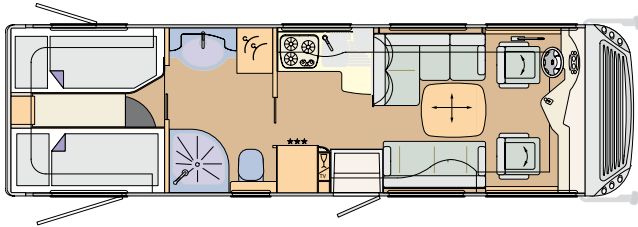

**CHARISMA 840L
C-LOUNGE** Iveco
Daily: 8480 x 2380 x
3290, MAN: 8620 x
2380 x 3460 mm

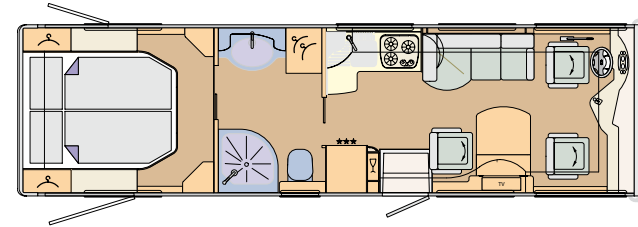

CHARISMA 890M
Iveco Daily: 8980 x
2380 x 3290 mm,
MAN: 9120 x 2380
x 3460 mm

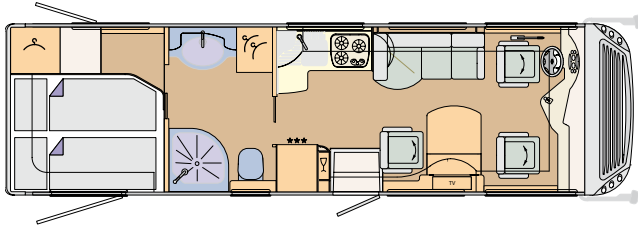

CHARISMA 840F
Iveco Daily: 8480 x
2380 x 3290 mm,
MAN: 8620 x 2380
x 3460 mm

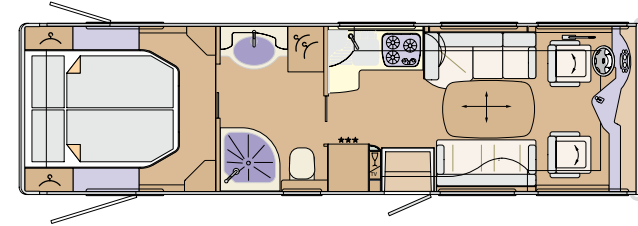

**CHARISMA 890M
LOUNGE** Iveco Daily:
8980 x 2380 x 3290
mm, MAN: 9120 x
2380 x 3460 mm

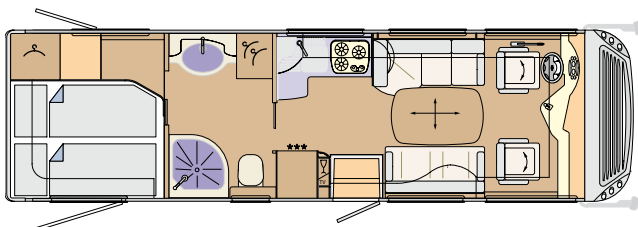

**CHARISMA 840F
LOUNGE** Iveco Daily:
8480 x 2380 x 3290
mm, MAN: 8620 x
2380 x 3460 mm

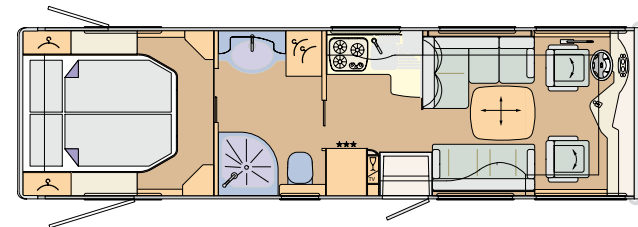

**CHARISMA 890M
C-LOUNGE** Iveco
Daily: 8980 x 2380 x
3290, MAN: 9120 x
2380 x 3460 mm

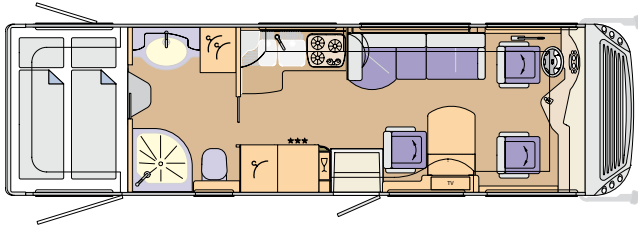

CHARISMA 840H
Iveco Daily: 8480 x
2380 x 3290 mm,
MAN: 8620 x 2380
x 3460 mm

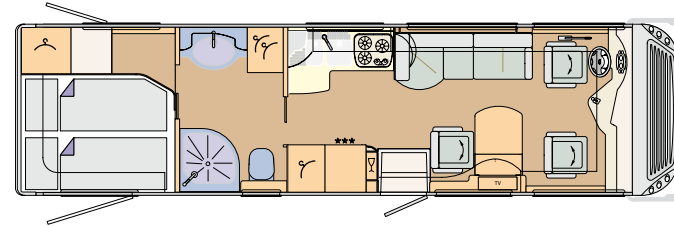

CHARISMA 890F
Iveco Daily: 8980 x
2380 x 3290 mm,
MAN: 9120 x 2380
x 3460 mm

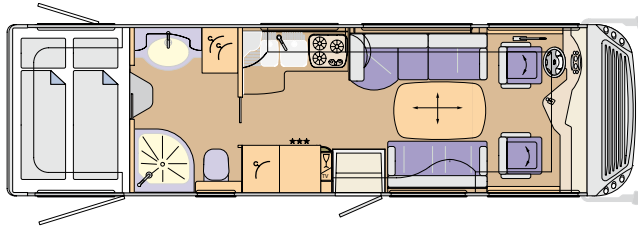

**CHARISMA 840H
LOUNGE** Iveco Daily:
8480 x 2380 x 3290
mm, MAN: 8620 x
2380 x 3460 mm

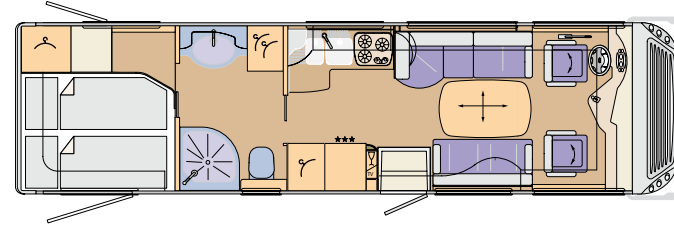

**CHARISMA 890F
LOUNGE** Iveco Daily:
8980 x 2380 x 3290
mm, MAN: 9120 x
2380 x 3460 mm

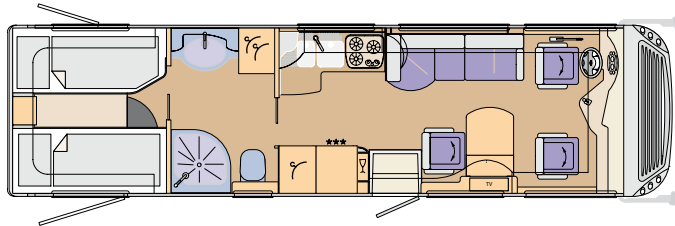

CHARISMA 890L
Iveco Daily: 8980 x
2380 x 3290 mm,
MAN: 9120 x 2380
x 3460 mm

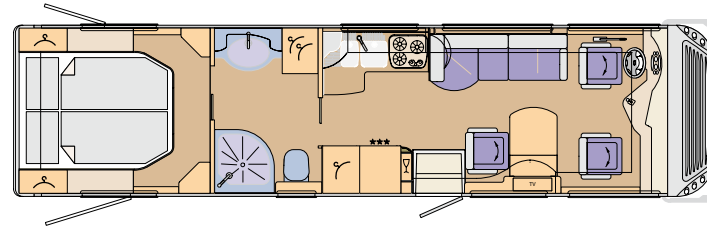

CHARISMA 940M
Iveco Daily: 9480 x
2380 x 3290 mm,
MAN: 9620 x 2380
x 3460 mm

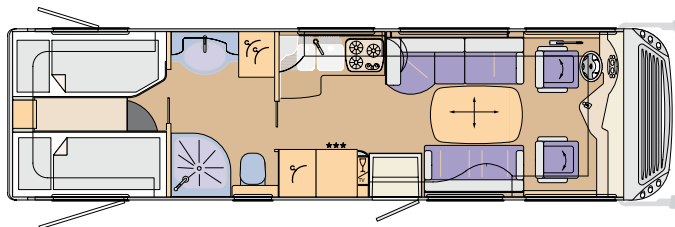

**CHARISMA 890L
LOUNGE** Iveco Daily:
8980 x 2380 x 3290
mm, MAN: 9120 x
2380 x 3460 mm

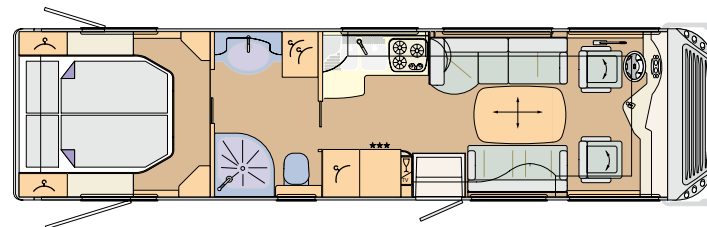

**CHARISMA 940M
LOUNGE** Iveco Daily:
9480 x 2380 x 3290
mm, MAN: 9620 x
2380 x 3460 mm

PUBLISHED BY

Concorde Reisemobile GmbH
Concorde Strasse 2–4
D-96132 Schlüsselfeld-Aschbach
Phone ++49(0) 95 55 / 92 25–0
Fax ++49(0) 95 55 / 92 25–44
Web site: www.concorde-reisemobile.de
eMail: zentrale@concorde-reisemobile.de

CONCEPT AND EDITORIAL

Medienagentur Punktgenau
Altenbergweg 9
D-74360 Ilsfeld
Phone ++49(0) 70 62 / 6 75 39 70
Fax ++49(0) 70 62 / 6 75 39 71
Web site: www.medienagentur-punktgenau.de
eMail: info@medienagentur-punktgenau.de

PHOTOGRAPHS

Elmar Hahn Studios, Veitshöchheim

COPYRIGHTS

All of the text passages and photographs, drawings and illustrations contained in this brochure are protected by copyright. All rights reserved. May only be reprinted with the publisher's prior consent in writing.

DISCLAIMER

All of the information in this brochure is in accordance with the status of series production at the time of going to press. Deviations in structure and colour compared with the furnishings shown in the photographs are reserved to the extent that these are due to the nature of the materials used and are customary in the trade. The same applies to technical modifications to the vehicle, as long as the quality of the product remains the same or is improved, and the intended purpose is not adversely affected. Some photographs contain special options available at an extra charge.



Concorde

REISEMOBILE AUS LEIDENSCHAFT

Concorde Reisemobile GmbH

Concorde-Strasse 2-4, 96132 Aschbach, Germany

Phone ++49(0) 95 55 / 92 25-0 - Fax ++49(0) 95 55 / 92 25-44

Web site: www.concorde-reisemobile.de

eMail: zentrale@concorde-reisemobile.de