



Concorde
REISEMOBILE AUS LEIDENSCHAFT

The Concorde Carver — a new class is born.

It's sometimes necessary to tear old ideas apart in order to create something new. Prejudice is just one example. Some people maintain that the term luxury motorhome cannot be used to describe any vehicle measuring less than eight metres in length. Concorde has now come up with a weighty argument to the contrary: the new Carver, which combines the benefits of a compact, manoeuvrable exterior with the outstanding technology inside the Motorhome of the Year 2006 - the Concorde Charisma. The single-level floor throughout the living area, raised sitting position, driver-active dashboard, elegant cherry-wood furniture and colour-coordinated upholstery are just a few of the features shared by Carver and Charisma. But the Carver appears very self-sufficient in spite of this, and much more than just a little brother. See for yourself ...





01 DESIGN

Style is not a question of size, but of taste. And the Carver is the answer.

A smiling face makes a person likeable. Why shouldn't the same apply to a motorhome? Particularly when the face is accompanied by elegant, almost sensual body contours like that of the new Concorde Carver. Harmonious concord that, far from being restricted to the exterior, continues inside without any break in style, where precious cherry-wood, soft warm-coloured microfibre and leather upholstery, sparkling glass fronts and chrome fittings are not only a pleasure to look at. The Carver – a new style in a new format.







DECIDE FOR YOURSELF

Beauty is always in the eye of the beholder and the same is true when it comes to luxury motorhomes. You should therefore take a particularly close look at the Carver: it combines exquisite materials and harmoniously coordinated colour schemes, stylish contours and perfect craftsmanship, top-quality components and perfected details in an as yet unparalleled manner. True beauty really does come from within in the case of the Carver.





A photograph of the interior of a Concorde motorhome. The space is compact and well-furnished. In the foreground, a light-colored leather sofa with tufted cushions is visible. To the left of the sofa, a small table holds a bottle of wine and a glass. Above the sofa, a television is mounted on the wood-paneled wall. To the right, a window with white curtains allows natural light into the space. A dark-colored leather chair is positioned in the foreground on the right side. The overall atmosphere is cozy and comfortable.

A PLACE TO FEEL AT HOME

A Concorde has one primary objective, and that is to meet your expectations. The Carver therefore offers plenty of room to live and enjoy life, and does it so well that you will only find one way that describes how you feel: "at home".



A close-up photograph of a motorhome's interior control panel. The focus is on a blue, rectangular button with a yellow padlock icon, indicating a lock function. The button is set into a light-colored, textured plastic panel. Below the button, a green LED light strip is visible, which is currently turned on. The background is a blurred view of the motorhome's interior, showing a window and other structural elements. The overall lighting is soft and blue-toned.

UNUSUAL PERSPECTIVES

Not everyone regards a motorhome in the same way. And a lot of people take a really close look. It's nice to know that the Carver sets new standards from every point of view, and right down to the finest detail. The Carver – simply beautiful.



THE BATHROOM – YOUR OWN OASIS OF WELLBEING

The term “luxury bathroom” goes without saying for the Carver. The spacious shower cubicle, generously dimensioned Corisan washbasin and abundance of shelves and compartments are a match for every household bathroom. Wood-panelled walls and shiny chrome fittings underline Concorde’s credo in this area as well: uncompromising relaxation.

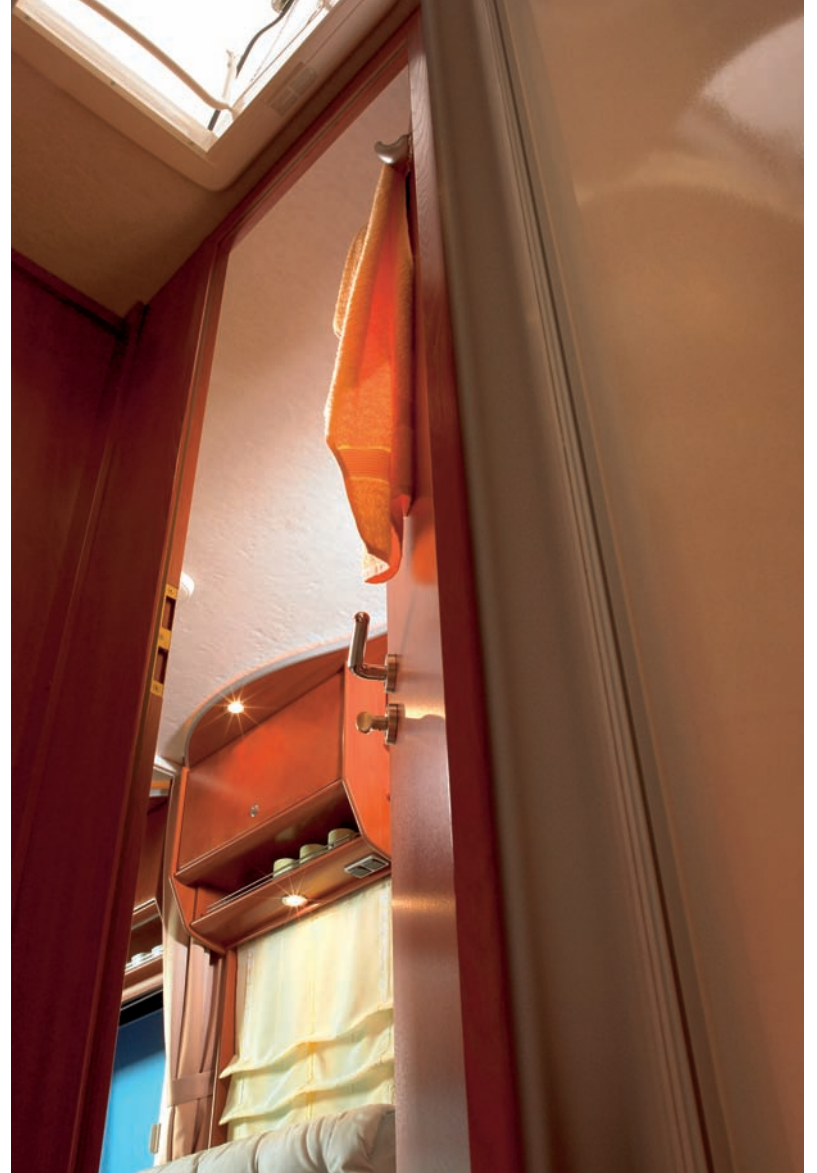



Concorde

CONCORDE. REISEMOBILE AUS LEIDENSCHAFT



02 EQUIPMENT

The Carver simply offers everything: packed with gadgets but enough room for customising.

Would you really buy something off the peg if you could have something tailored to suit your own individual wishes instead? The truth of the matter is that motorhome travellers are individualists. Apart from an as yet unparalleled spectrum of features as standard equipment, Concorde therefore offers you a great deal of freedom to put together a dream machine that has been tailored to suit your exact requirements. Various interior packages are available, as well as a 177 HP engine upgrade, automatic transmission, bi-xenon headlights and air suspension. Customise to your heart's content!



SOME PEOPLE BUY IT JUST TO USE THE KITCHEN

It's not unusual for the kitchen to be the central focal point of life at home, where the family meets up to cook, eat and celebrate together. Why should a motorhome be any different? The modern, ergonomically designed kitchen area in the Carver has not been positioned in the centre of the vehicle for nothing. The finest materials, such as stainless steel, chrome and genuine glass also ensure that cooking is a real experience in the Carver.





The image shows the interior of a motorhome. On the left, there is a kitchenette with a white countertop, a chrome faucet, and a potted plant. Above the counter, there are shelves with glassware. To the right of the kitchenette is a built-in unit containing a Dometic oven and a refrigerator. The unit has a silver control panel with three knobs. The interior walls are a warm, reddish-brown color. In the foreground, a portion of a bed with a light-colored coverlet is visible.

RELAX AND TAKES THINGS EASY

Single beds lengthwise or a double bed crosswise – the new Carver gives you a choice of overnight accommodation. Whatever you decide, you will enjoy sleeping in a bed that is certainly a match for its counterpart at home in terms of both size and comfort.







ENOUGH ROOM FOR YOUR DREAMS

How much storage space does a motorhome need? Concorde answers this question with “enough” in the Carver. But it is not just a question of the number and size of wardrobes, cupboards, compartments and lockers. The more convincing solution presented by the Carver is that it always offers the space you need where you need it. After all, you should be the one to decide how much luggage you take with you.



PURE ENTERTAINMENT

Mobile radio, radio with CD and MP3 player, Bluetooth and hands-free talking facility, digital satellite reception with Twin LNB and 20" flat panel displays: combine the multimedia devices of your choice in the new Carver. Enjoy the entertainment!





CONCORDE. REISEMOBILE AUS LEIDENSCHAFT

03 TECHNOLOGY

The technology in the new Carver is much more than a means to an end. Fascinating.

One of the Carver's most outstanding features is that its technology puts all other motorhomes of its class in the shade. This is not just because the Concorde development engineers have packed a well-nigh incredible number of technical innovations into this vehicle. No, it is even more convincing by virtue of the fact that all of these innovative features work discretely and unobtrusively to ensure that you can concentrate your attention on your holiday and enjoy your journey. After all, there are much more relaxing things to do than think about engineering.



SEPARATE SERVICE FLAP FOR THE HEATING SYSTEM

INNER WORKINGS

Outsiders really stay on the outside with the new Carver. All serviceable components, such as the central heating/hot-water system with optimised heating circuit or the central electrical system in the generously dimensioned rear garage, are easily accessible, so that there is no need for the mechanic to enter the living area. Apart from this, all water connections, pumps and heating elements are fitted in the cellar. After all, your motorhome belongs to you alone.

GENEROUSLY SIZED
REAR GARAGE WITH
EASILY ACCESSIBLE
ELECTRICAL SYSTEM



The image shows the interior of a motorhome cab. Two large, white leather seats with horizontal stitching are positioned on either side of a central dashboard. The dashboard is dark wood with a steering wheel on the left, a central console with a gear shift and handbrake, and a dashboard with multiple gauges and a small screen. Above the dashboard is a large, white, horizontally-slatted panel. The ceiling is dark wood with recessed lighting. The overall atmosphere is warm and luxurious.

**SPECIALLY DEVELOPED DRIVER-ACTIVE DASHBOARD
IN THE COMPLETELY INSULATED DRIVER'S CAB**

CONCORDE. REISEMOBILE AUS LEIDENSCHAFT

SINGLE-LEVEL FLOOR THROUGHOUT



STYLISHLY INTEGRATED GAS SUPPLY VALVES



STANDING STILL IS THE SAME AS GOING BACKWARDS

Always being a few steps ahead is part of Concorde's philosophy. As one example of this, the new Carver is the first motorhome of its class to have a single-level floor throughout. This gives rise to a fully insulated driver's cab and a virtually unique feeling of spaciousness. Furthermore, you will enjoy the pleasure of a raised sitting position, further forward in the cab, providing a much better view of the road. These features, combined with the driver-active dashboard developed specially for this vehicle, offer the perfect driving experience in the Carver. Try it yourself!



OPTIONAL AWNING - 4.00 OR 4.50 METRES LONG

OPTIONAL SECURITY DOOR



EXTREME TECHNOLOGY

You will not only find innovations inside the new Carver. Its turbocharged diesel engine with electronically controlled Common Rail direct injection, exhaust gas recirculation system and particle filter ensure that you make good progress in every situation. The door to the living area with electronic interlock, safety glass and safe-type, user-definable combination lock will reliably keep unwanted visitors at bay. And the flaps with their welded, powder-coated frames ensure that your luggage stays exactly where it belongs. But you should really find out for yourself.

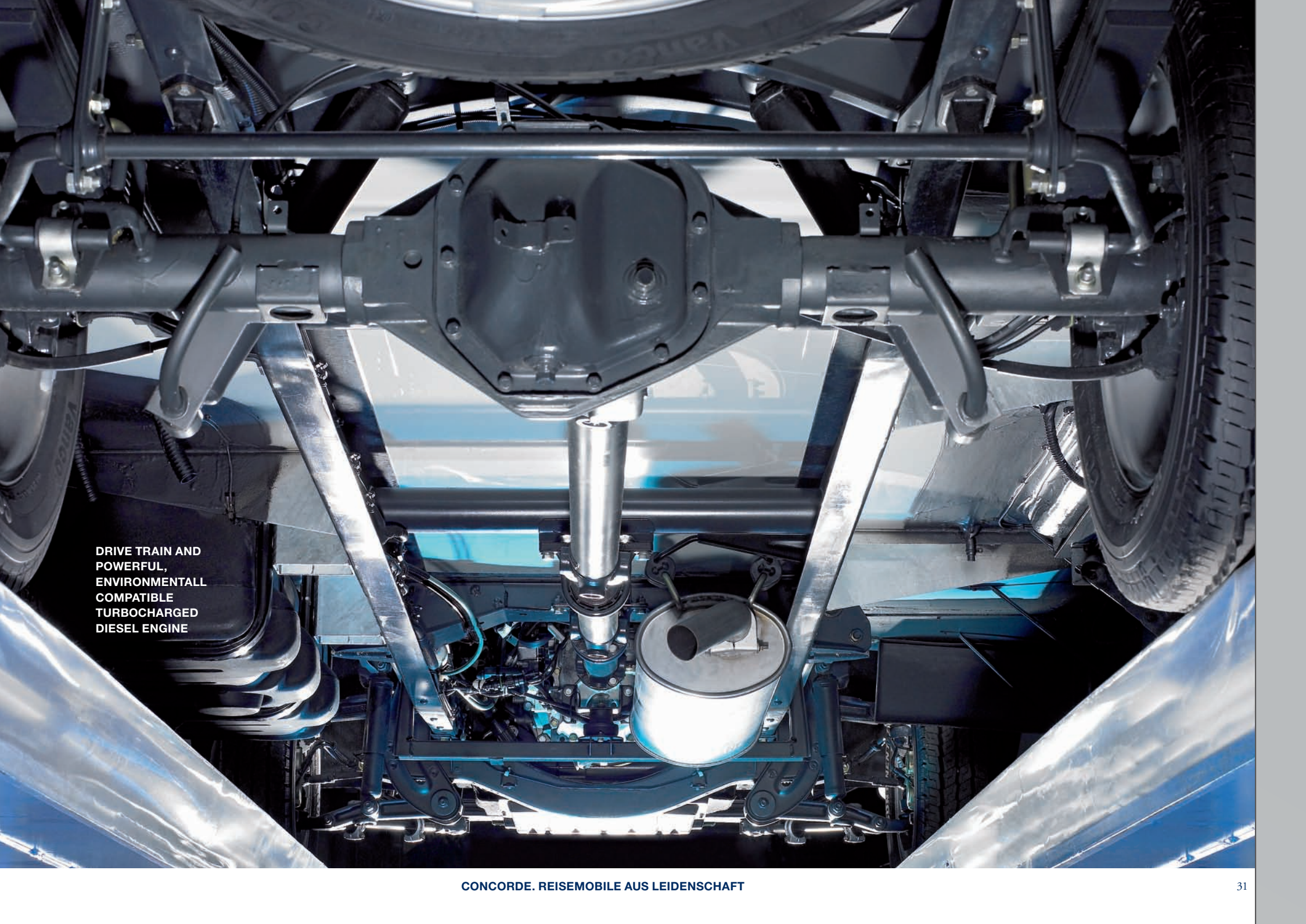

A detailed view of the undercarriage of a vehicle, focusing on the drive train and engine. The image shows a complex arrangement of metal components, including the chassis, suspension, and engine block. A prominent silver-colored cylindrical component, likely a fuel filter or part of the exhaust system, is visible in the center. The overall scene is illuminated with a cool blue light, highlighting the metallic surfaces and the intricate engineering of the vehicle's underside.

DRIVE TRAIN AND
POWERFUL,
ENVIRONMENTALLY
COMPATIBLE
TURBOCHARGED
DIESEL ENGINE

04 UPHOLSTERY AND FABRICS



DOVE BLUE*

* All colours also available in leather



MINT GREEN*



SANDSTONE*



CARAMEL*

05 LAYOUTS

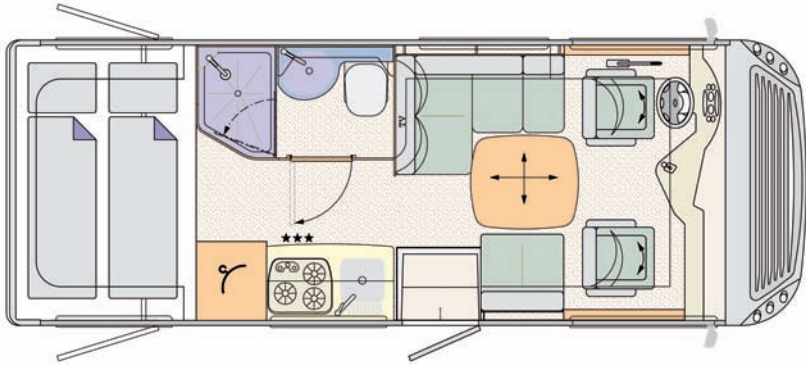

CARVER 642 H 6480 x 2380 x 3190 mm

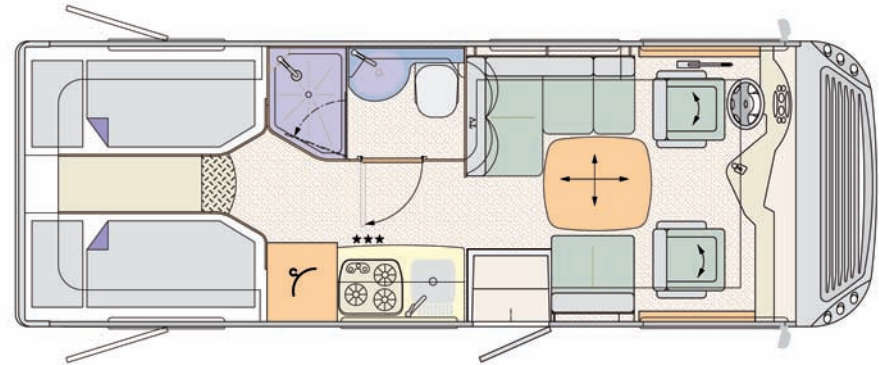

CARVER 692 L 6980 x 2380 x 3190 mm

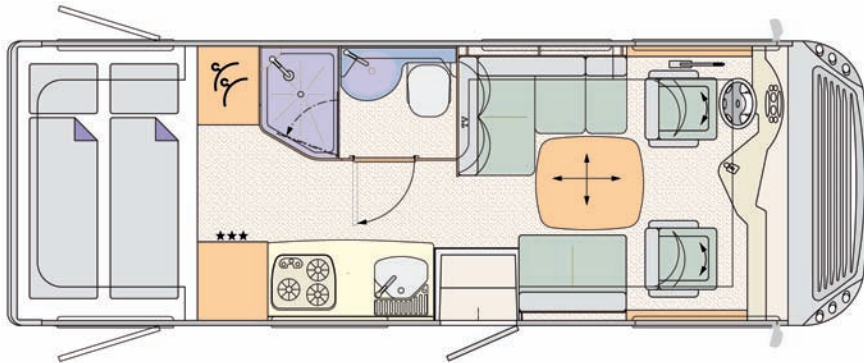

CARVER 692 H 6980 x 2380 x 3190 mm

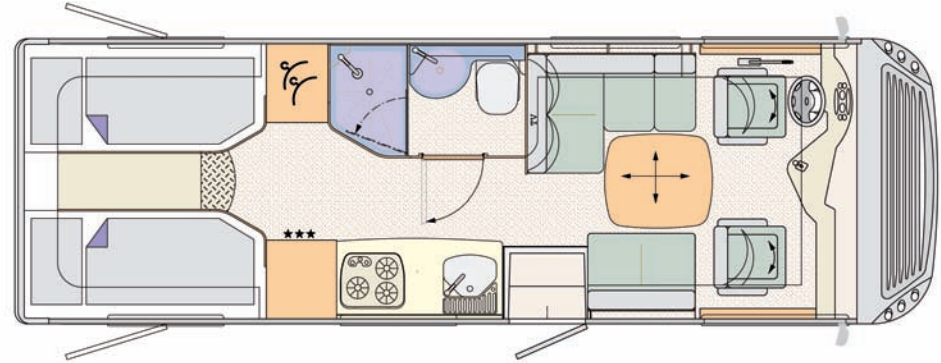

CARVER 742 L 7480 x 2380 x 3190 mm

PUBLISHED BY

Concorde Reisemobile GmbH
Concorde Strasse 2-4
D-96132 Schlüsselfeld-Aschbach
Phone ++49(0) 95 55 / 92 25-0
Fax ++49(0) 95 55 / 92 25-44
Web site: www.concorde.eu
eMail: info@concorde.eu

CONCEPT AND EDITORIAL

Medienagentur Punktgenau
Feldmochinger Straße 36
80992 München
Phone ++49(0) 89 / 14 34 30 88
Fax ++49(0) 89 / 14 34 30 89
Web site: www.medienagentur-punktgenau.de
eMail: info@medienagentur-punktgenau.de

ART DIRECTION

Andreas Croonenbroeck

PHOTOGRAPHS

Elmar Hahn Studios, Veitshöchheim

COPYRIGHTS

All of the text passages and photographs, drawings and illustrations contained in this brochure are protected by copyright. All rights reserved. May only be reprinted with the publisher's prior consent in writing.

DISCLAIMER

All of the information in this brochure is in accordance with the status of series production at the time of going to press. Deviations in structure and colour compared with the furnishings shown in the photographs are reserved to the extent that these are due to the nature of the materials used and are customary in the trade. The same applies to technical modifications to the vehicle, as long as the quality of the product remains the same or is improved, and the intended purpose is not adversely affected. Some photographs contain special options available at an extra charge.

Printed in August 2007



Concorde

REISEMOBILE AUS LEIDENSCHAFT

Concorde Reisemobile GmbH

Concorde-Strasse 2-4, 96132 Schlüsselfeld-Aschbach, Germany

Phone ++49(0) 95 55 / 92 25-0 - Fax ++49(0) 95 55 / 92 25-44

Web site: www.concorde.eu

eMail: info@concorde.eu