



***Concorde***

REISEMOBILE AUS LEIDENSCHAFT

# The new Concorde Cruiser – a face that stands out in a crowd.

Have you always thought that motorcaravans are all pretty much the same? Well, the new Concorde Cruiser has everything it takes to convince you that you were wrong. Far from running with the crowd, it is a pioneer among luxury-class coachbuilds.

Not only impressive by virtue of its size, with exceptionally spacious living accommodation, it also has something very unusual, something that makes it stand out against the dull monotony of the average motorhomes: and that is its appearance, its face.

This uniqueness, combined with the quality of craftsmanship that is typical of Concorde, and a multitude of previously undreamed-of technical innovations, make the Cruiser what it is: quite possibly the best coachbuilt motorhome of all time. And now, it's up to you...













## 01 **DESIGN**

Some people say that good looks and motorhomes don't go together. Not true, says Concorde.

There may have had times when motorhomes - and coachbuilds in particular - were designed with nothing but functional perfection in mind. The new Concorde Cruiser proves that those days are over. It unites state-of-the-art technology with stylish elegance like no other coachbuilt motorcaravan. The harmonious contours of the coachwork are in perfect concord with the compact stature of the Cruiser. A concord that is carried over inside the vehicle, where elegant cherry-wood, warm microfibre or leather covers and sparkling glass provide a feast for the eyes. See for yourself!



#### **FROM STYLISH DETAILS TO AN OVERALL IMPRESSION OF ELEGANCE**

Whether we like or dislike something is often decided at first sight. Your first impression of the Cruiser will be marked by top-quality materials and tasteful colour schemes. The perfectly crafted furnishings, harmoniously matched leather and fabric compositions and stylistic excellence right down to the finest detail ensure that the elegant concept is continued inside.













#### MAKE LIVING AN EXPERIENCE

A modern coachbuilt motorcaravan has to be a great deal more than just practical. It must offer sufficient room to live and enjoy life. After all, increasingly exacting demands leave relatively little room for compromise.









### **THE BATHROOM – ENJOY THE SPACIOUSNESS**

You can usually tell how seriously a motorhome manufacturer takes the wishes of his customers by taking a look at the sanitary facilities.

Both Divided and Premium bathroom options in the new Cruiser offer the pleasure of a luxuriously dimensioned shower cubicle and generously sized Corisan washbasin that are certainly a match for the bathroom at home.



CONCORDE. REISEMOBILE AUS LEIDENSCHAFT

## THE CRUISER LEAVES A LASTING IMPRESSION

True beauty is always in the eye of the beholder and this is also the case at Concorde. What do your eyes see?

A motorhome that combines apparent contradictions in a manner unparalleled by any other motorcaravan: compact exterior and streamlined silhouette, distinctive styling and harmonious contours, large-scale presence and meticulous detail. Simply allow it to take effect. The Cruiser makes it easy for you.





## 02 EQUIPMENT

Is the best just about good enough for you? If so, you'll feel really at home in the Cruiser.

Motorhome travellers are individualists. A fact that Concorde acknowledges in the new Cruiser with a vast range of equipment options to supplement the standard features, offering you the freedom to create your own, very personal "dream machine". Apart from a number of interior packages, the available options include such highlights as an air-suspended rear axle, differential lock, automatic six or twelve-speed transmission, a microwave cooker or a dishwasher. Underline your appreciation of special qualities and design a Concorde Cruiser that is as individual as you are.









### **YOU WANTED A KITCHEN – YOU NOW HAVE A NEW HOBBY**

Preferences can shift so quickly – just a moment ago, the motorhome kitchen was simply a place to prepare a quick snack. Impressive aesthetics unite with ergonomic modernity in the Cruiser to produce a kitchen centre that will transform cooks into chefs and eaters into gourmets



#### AS YOU MAKE YOUR BED...

...so you must lie on it.  
Not even the Cruiser can  
put aside the legitimacy  
of this proverb. And why  
should it? The Cruiser  
offers you a bedroom that  
certainly bears comparison  
with its counterpart at  
home. Irrespective of your  
preferences - single bed,  
double bed, lengthwise or  
crosswise – nothing will  
rob you of your sleep in  
the Cruiser.











### CONVINCING TECHNOLOGY

Mobile radio, DVD navigation system, digital satellite receiving equipment with twin LNB, as well as electrically retractable 20" flat panel displays: a great deal of importance is attached to multimedia in Concorde's luxury coachbuilt motorhome. After all, you need to offer the most modern equipment if you want to be the No. 1.







#### **EVEN EXPLORERS NEED A PLACE OF REFUGE**

Spaciousness, versatility and elegant surroundings – terms which are no longer contradictory where motorcaravan bathrooms are concerned in the new Concorde Cruiser. Choose between the Premium option with shower cubicle, washbasin and toilet all in one room and the Divided bathroom with separate shower. Just relax and take it easy!









CONCORDE. REISEMOBILE AUS LEIDENSCHAFT



## 03 TECHNOLOGY

The Cruiser proves it again: the name for technically outstanding motorhomes is Concorde.

High-tech gadgets seem to exude an almost magical attraction for some people. Other people regard technology as merely being a means to an end, providing assistance throughout their daily lives. It's nice to know that the Cruiser will make all of these people happy. The high-tech fans because the Concorde development engineers have packed a multitude of technical highlights into the luxury coachbuilt, and the others because the technical systems do exactly what they were designed to do. And they do so without you even noticing. After all, you'd much rather concentrate on enjoying your holiday, wouldn't you?



**ACCESSIBLE FROM BOTH SIDES, UNDERFLOOR STORAGE COMPARTMENT**



**SEPARATE SERVICE FLAP FOR THE HEATING SYSTEM**

### EVERYTHING WORKS BETTER IN THE CRUISER

Behind the flaps with their welded, powder-coated frames, the new Cruiser reveals one of major points in its favour: seemingly endless storage space. The capacity of the rear garage alone amounts to more than 4,400 litres and there's another 1,600 litres capacity in the underfloor storage compartment. Another flap conceals the central heating / hot-water system with optimised heating circuit that provides an even supply of heat throughout the Cruiser interior. This standard is also matched by the door to the living area, which has an electronic interlocking facility, safety glass window and safe-type lock with user-definable combination. Enough room? Certainly!

**DOOR WITH COMBINATION LOCK**





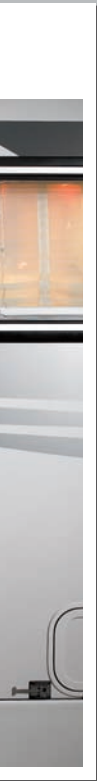

GENEROUSLY  
DIMENSIONED  
GARAGE WITH  
4,400 LITRES  
LOADING VOLUME





LUXURY-QUALITY  
CONTROL PANEL  
FOR THE CENTRAL  
HEATING / HOT-  
WATER SYSTEM



### **MORE THAN JUST WARM WORDS OF COMFORT**

Warmth is life. This is certainly the case in a motorhome. Concorde models are not famous for their cold-weather capability for nothing. The Solidtherm® sandwich construction of the coachwork guarantees that the warmth stays exactly there, where it belongs – inside. The new Cruiser is kept warm by a central heating / hot-water system that has been fitted between the floor panels to save space. Apart from this, the three-flame stainless steel gas hob and the stainless steel coffee-maker fitted as an option also ensure that you can warm up to the Cruiser from the inside.

**WORKTOP WITH OPTIONAL COFFEE-MAKER**



**GAS HOB WITH AUTOMATIC IGNITION**





PANORAMIC ROOF HATCH WITH OPTIONAL SOLAR EQUIPMENT



## WELCOME TO THE ROOF OF THE (MOTORHOME ) WORLD

The roof of a motorhome is a lot more exciting than is generally thought. Well the roof of the Concorde Cruiser is, at any rate: the enormous, level surface not only accommodates the perfectly situated digital satellite receiving equipment, but also the panoramic roof hatch with interior lighting, the mobile radio antenna and the solar equipment capable of producing up to 240 watts of power. And, as you can see, the designers of the new Cruiser didn't stop when they got to the roof. It's actually a pity that you rarely see it from this point of view.





PERFECTLY ACCESSIBLE ELECTRICAL SYSTEM IN THE REAR GARAGE





**THE DRIVING SEAT OF THE IVECO EUROCARGO WITH ITS MANY ADJUSTMENT FACILITIES**

#### **THE CRUISER WILL MAKE YOU A LIVE WIRE, AS WELL**

The Cruiser appears to have adopted some of its features from “normal” homes, where electrical wires and cables are also brought together in a fuse box. In the case of the Cruiser, all wires and cables are routed to the control centre, situated out of the way in the rear garage, from where power is supplied to all items of equipment. And that’s the way it should be.

**PANORAMIC ROOF HATCH WITH LIGHTING**



## 04 UPHOLSTERY AND FABRICS



DOVE BLUE\*

\* All colours also available in leather



MINT GREEN\*





SANDSTONE\*



CARAMEL\*

## 05 LAYOUTS

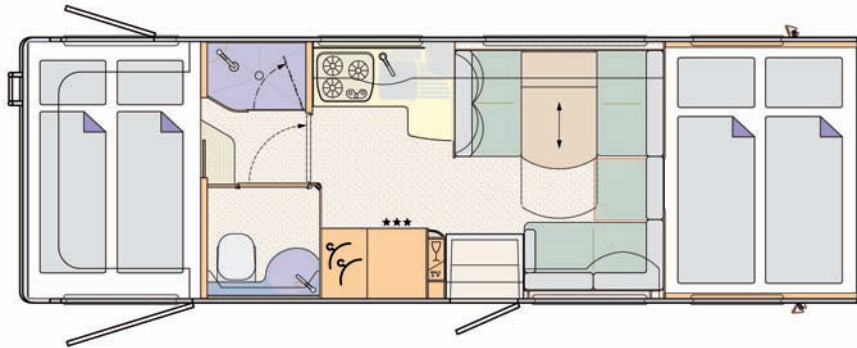

### CRUISER 791 H WITH DIVIDED BATHROOM

Iveco Daily: 8470 x 2380 x 3420 mm, Iveco Eurocargo 75E18: 7830 x 2490 x 3570 mm,  
Iveco Eurocargo 80E22: 7830 x 2490 x 3600 mm, MAN: 7830 x 2490 x 3600 mm

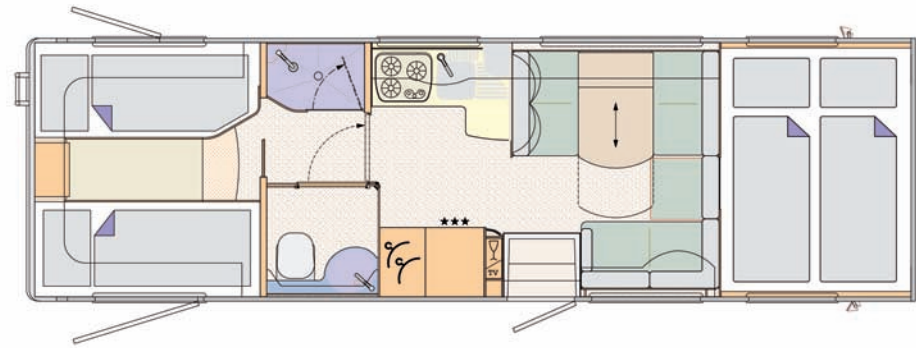

### CRUISER 841 L WITH DIVIDED BATHROOM

Iveco Daily: 8970 x 2380 x 3420 mm, Iveco Eurocargo 75E18: 8330 x 2490 x 3570 mm,  
Iveco Eurocargo 80E22: 8330 x 2490 x 3600 mm, MAN: 8330 x 2490 x 3600 mm

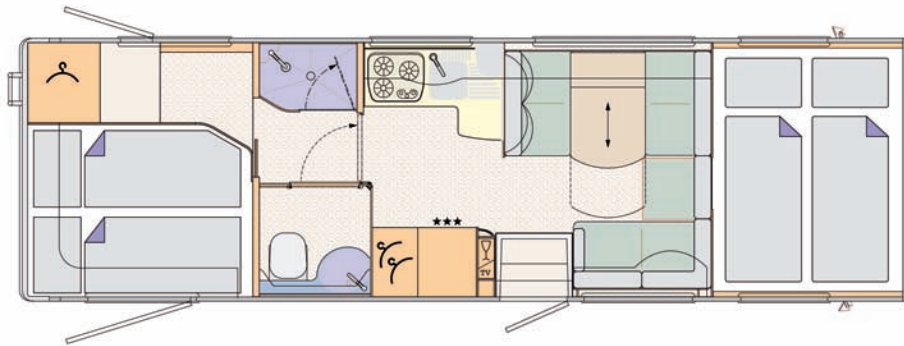

### CRUISER 841 F WITH DIVIDED BATHROOM

Iveco Daily: 8970 x 2380 x 3420 mm, Iveco Eurocargo 75E18: 8330 x 2490 x 3570 mm,  
Iveco Eurocargo 80E22: 8330 x 2490 x 3600 mm, MAN: 8330 x 2490 x 3600 mm

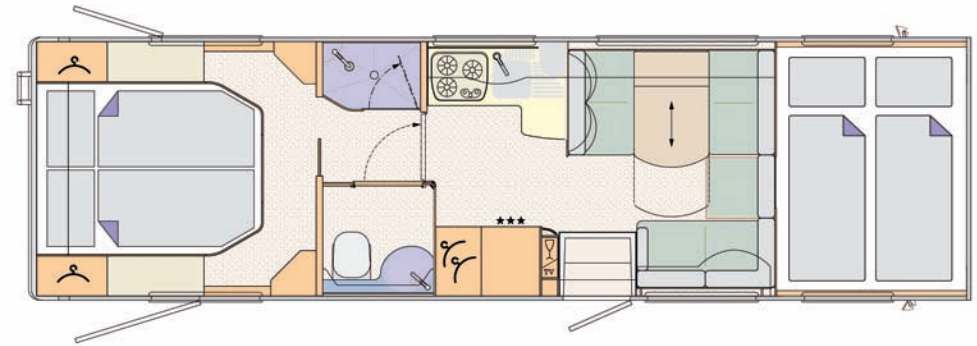

### CRUISER 891 M WITH DIVIDED BATHROOM

Iveco Daily: 9470 x 2380 x 3420 mm, Iveco Eurocargo 75E18: 8830 x 2490 x 3570 mm,  
Iveco Eurocargo 80E22: 8830 x 2490 x 3600 mm, MAN: 8830 x 2490 x 3600 mm



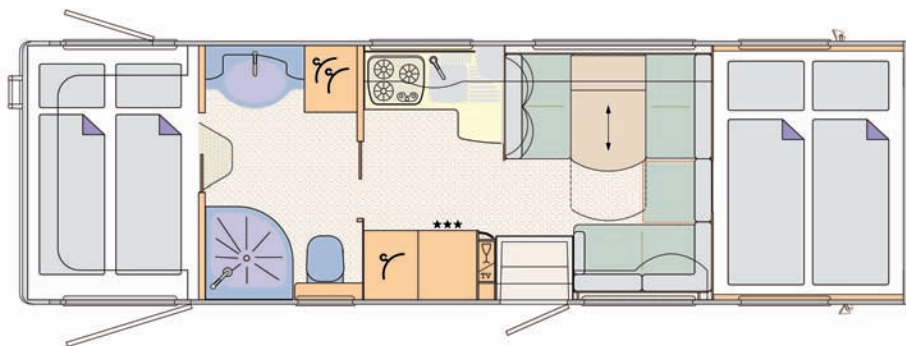

#### CRUISER 840 H WITH PREMIUM BATHROOM

Iveco Daily: 8970 x 2380 x 3420 mm, Iveco Eurocargo 75E18: 8330 x 2490 x 3570 mm,  
Iveco Eurocargo 80E22: 8330 x 2490 x 3600 mm, MAN: 8330 x 2490 x 3600 mm

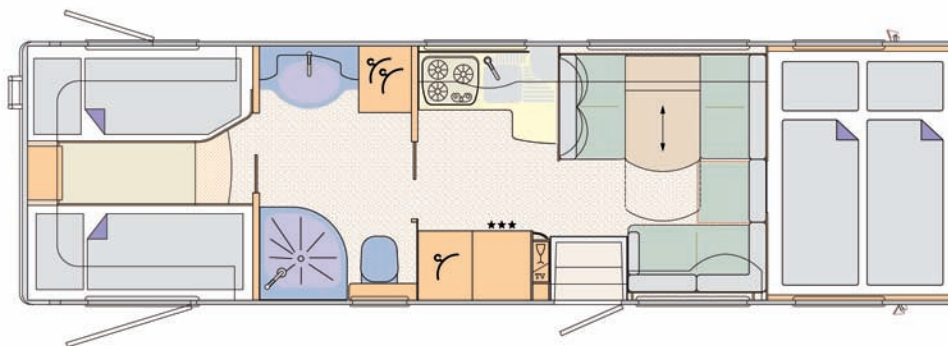

#### CRUISER 890 L WITH PREMIUM BATHROOM

Iveco Daily: 9470 x 2380 x 3420 mm, Iveco Eurocargo 75E18: 8830 x 2490 x 3570 mm,  
Iveco Eurocargo 80E22: 8830 x 2490 x 3600 mm, MAN: 8830 x 2490 x 3600 mm

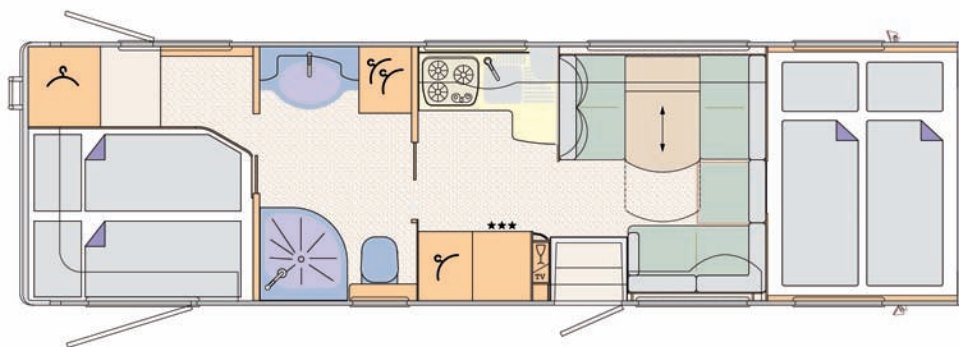

#### CRUISER 890 F WITH PREMIUM BATHROOM

Iveco Daily: 9470 x 2380 x 3420 mm, Iveco Eurocargo 75E18: 8830 x 2490 x 3570 mm,  
Iveco Eurocargo 80E22: 8830 x 2490 x 3600 mm, MAN: 8830 x 2490 x 3600 mm

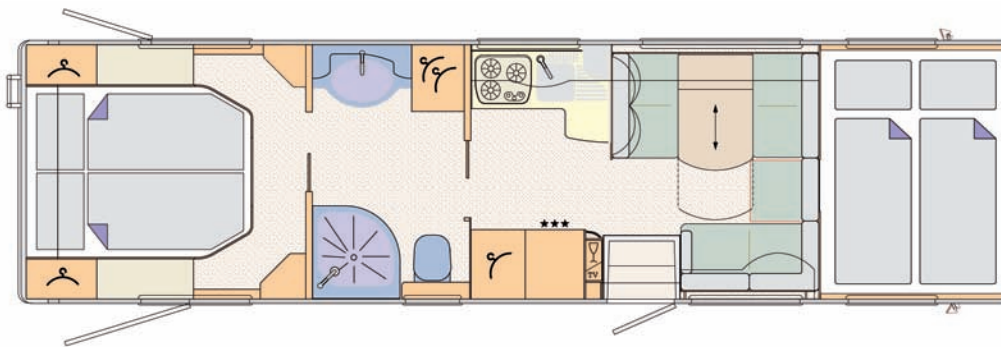

#### CRUISER 940 M WITH PREMIUM BATHROOM

Iveco Eurocargo 75E17: 9330 x 2490 x 3570 mm, Iveco Eurocargo 80E21: 9330 x 2490  
x 3600 mm, MAN: 9330 x 2490 x 3600 mm

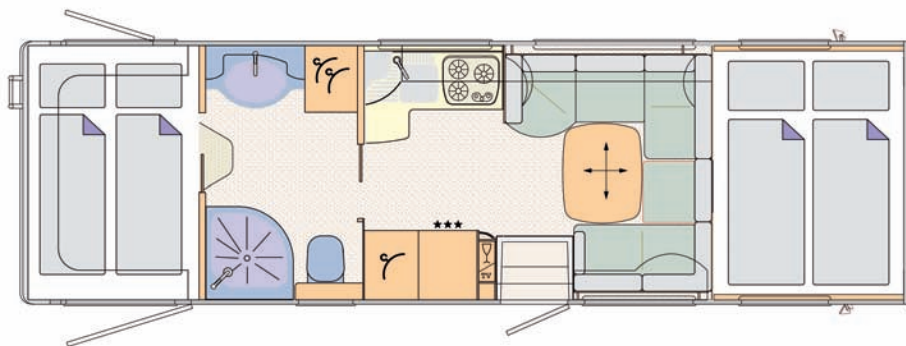

#### CRUISER 840 HR WITH PREMIUM BATHROOM

Iveco Daily: 8970 x 2380 x 3420 mm, Iveco Eurocargo 75E18: 8330 x 2490 x 3570 mm,  
Iveco Eurocargo 80E22: 8330 x 2490 x 3600 mm, MAN: 8330 x 2490 x 3600 mm

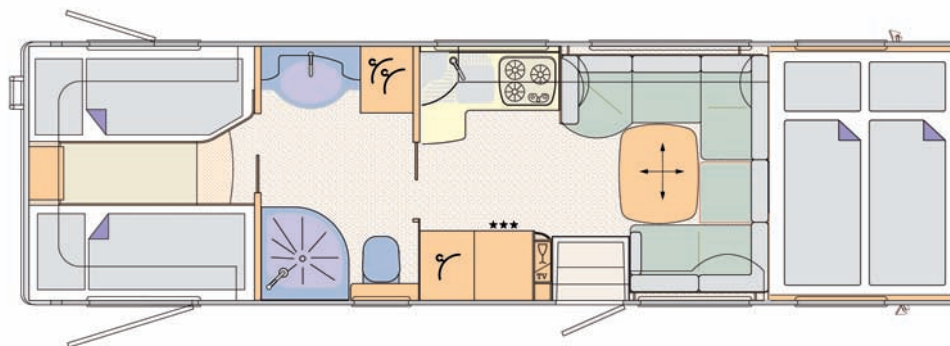

#### CRUISER 890 LR WITH PREMIUM BATHROOM

Iveco Daily: 9470 x 2380 x 3420 mm, Iveco Eurocargo 75E18: 8830 x 2490 x 3570 mm,  
Iveco Eurocargo 80E22: 8830 x 2490 x 3600 mm, MAN: 8830 x 2490 x 3600 mm

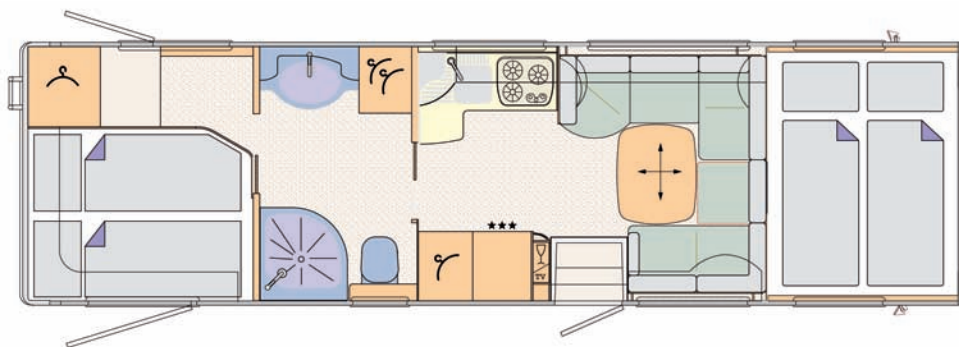

#### CRUISER 890 FR WITH PREMIUM BATHROOM

Iveco Daily: 9470 x 2380 x 3420 mm, Iveco Eurocargo 75E18: 8830 x 2490 x 3570 mm,  
Iveco Eurocargo 80E22: 8830 x 2490 x 3600 mm, MAN: 8830 x 2490 x 3600 mm

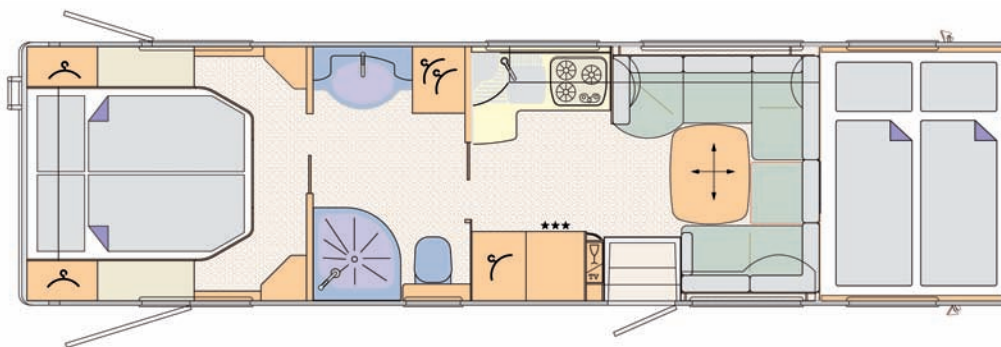

#### CRUISER 940 MR WITH PREMIUM BATHROOM

Iveco Eurocargo 75E17: 9330 x 2490 x 3570 mm, Iveco Eurocargo 80E21: 9330 x 2490  
x 3600 mm, MAN: 9330 x 2490 x 3600 mm



#### **PUBLISHED BY**

Concorde Reisemobile GmbH  
Concorde Strasse 2-4  
D-96132 Schlüsselfeld-Aschbach  
Phone ++49(0) 95 55 / 92 25-0  
Fax ++49(0) 95 55 / 92 25-44  
Web site: [www.concorde.eu](http://www.concorde.eu)  
eMail: [info@concorde.eu](mailto:info@concorde.eu)

#### **CONCEPT AND EDITORIAL**

Medienagentur Punktgenau  
Feldmochinger Strasse 36  
80992 München  
Phone ++49(0) 89 / 14 34 30 88  
Fax ++49(0) 89 / 14 34 30 89  
Web site: [www.medienagentur-punktgenau.de](http://www.medienagentur-punktgenau.de)  
eMail: [info@medienagentur-punktgenau.de](mailto:info@medienagentur-punktgenau.de)

#### **ART DIRECTION**

Andreas Croonenbroeck

#### **PHOTOGRAPHS**

Elmar Hahn Studios, Veitshöchheim

#### **COPYRIGHTS**

All of the text passages and photographs, drawings and illustrations contained in this brochure are protected by copyright. All rights reserved. May only be reprinted with the publisher's prior consent in writing.

#### **DISCLAIMER**

All of the information in this brochure is in accordance with the status of series production at the time of going to press. Deviations in structure and colour compared with the furnishings shown in the photographs are reserved to the extent that these are due to the nature of the materials used and are customary in the trade. The same applies to technical modifications to the vehicle, as long as the quality of the product remains the same or is improved, and the intended purpose is not adversely affected. Some photographs contain special options available at an extra charge.

Printed in August 2007



# **Concorde**

REISEMOBILE AUS LEIDENSCHAFT

Concorde Reisemobile GmbH

Concorde-Strasse 2-4, 96132 Aschbach, Germany

Phone ++49(0) 95 55 / 92 25-0 - Fax ++49(0) 95 55 / 92 25-44

Web site: [www.concorde.eu](http://www.concorde.eu)

eMail: [info@concorde.eu](mailto:info@concorde.eu)