



Concorde
REISEMOBILE AUS LEIDENSCHAFT

The Concorde Liner – It's time to show your colours.

Creating milestones can hardly be described as an easy undertaking. But Concorde continues to set new motorhome standards over and over again. Can this be put down to experience? The open-minded, completely impartial approach? The ability to develop technical innovations? In fact, it is the amalgamation of all of these factors that make the Concorde Liner what it is: probably the best motorhome of all time. It combines the interior design of the successful Concorde Charisma - but even more spacious - with the outstanding technical qualities of the basic MAN vehicle and the tried-and-trusted Solidtherm® construction with smooth, elegant contours with as an yet unparalleled visual presence. The Liner - why be satisfied with anything less?





01 DESIGN

However you look at it –
The Liner is a motorhome of
impressive perspectives.

There are many terms that characterise the appearance of the Concorde Liner: self-assured, spacious, consistent. But the one that really captures the essence of this luxury “A” class motorhome is a word with just 5 letters - “style”. Style on the outside - where smooth contours enter into a perfect liaison with distinctive details - and style on the inside - where the gentle curves of the cherry-wood furnishings harmonise with the elegant warm shades of the microfibre or leather covers. But why don't you discover the fascination of the Liner for yourself?









PURE ELEGANCE

Are you looking for a motorhome that meets your day-to-day requirements but still imbues you with a sense of well-being and offers enough space for your dreams? And does it have to be stylish and elegant as well? Well, here it is: the Concorde Liner. But there's one thing you can be sure of: you will soon stop referring to it as the Liner and start calling it "home".



AT HOME AT THE WORLD'S MOST PRESTIGIOUS LOCATIONS

Out of the opera house and into the Liner - Concorde's flagship always cuts a dashing figure at every exclusive event. A multitude of convincing features are also waiting inside the Liner. Fragrant leather, the elegant sheen of cherry-wood furnishings with sparkling glass-fronted cabinets unequivocally underline the claim of the high-end "A" class: to offer you as much luxury as possible during your holiday.





Liner

A close-up, low-angle shot of the front of a silver Concorde. The car's body is highly reflective, showing sharp highlights and shadows. The 'Liner' badge is prominently displayed in the upper left. Below it, the horizontal slats of the grille are visible. A sharp, diagonal line of the car's bodywork cuts across the frame. In the lower right, three circular light housings are visible; the rightmost one is illuminated, showing a complex array of small LED lights.

UNMISTAKABLE

The Concorde Liner would certainly be out of line if its appearance did not clearly distinguish it from run-of-the-mill "A" class motorhomes. The unique composition of elegant body contours, generously dimensioned glass panels and the self-assured front section make the Liner stand out in the crowd.





02 EQUIPMENT

At long last, a motorhome for those who only want the best. Or would you be satisfied with less?

Would you like to configure your own luxury motorhome? Well, you won't need to spend too much time configuring the Concorde Liner. Not because the Liner doesn't offer many options, but because most of these features - from the automated TipMatic transmission system through to the rear-axle air suspension, from the bi-xenon headlights through to the cruise control system, from the coffee-maker through to the heated towel rail - are included in the standard equipment anyway. But don't worry: you'll find enough ways of adapting your Liner to suit your own very personal requirements.



CONCORDE. REISEMOBILE AUS LEIDENSCHAFT



A TRUE ISLAND OF TRANQUILITY

People spend most of their lives in bed. Reason enough to allow you to decide how you want to spend this time: in single beds lengthwise, double beds crosswise or double beds lengthwise – it's up to you. But one thing is certain: you will enjoy your sleep.

DRIVING IN STYLE - LIVING IN STYLE - SLEEPING IN STYLE

How is "luxury" actually defined? According to the dictionary, luxury is the "abundant provision of means of comfort, ease and pleasure". It can be defined in much more concise terms, however: luxury = Liner. The Concorde Liner provides you with an abundance of means of comfort, ease and pleasure; in other words, the things that make the life of a motorhome traveller worth living. After all, it is this elegance, this sensuality and this perfection that make the difference between a motorhome and a Concorde.







MOBILE WELLNESS

When Concorde refers to a "Premium bathroom" then you can expect something really special, such as the enormous shower cubicle and Corisan washbasin. The Premium bathroom - pure relaxation.





REAL GOURMETS TRAVEL IN LINERS

Modern, ergonomic and simply beautiful: the cooking area in the Liner is not called a kitchen centre for nothing. Surrounded by stainless steel, chrome and Corisan, you'll find that cooking can be just as enjoyable as eating in the future.





VERSATILITY IS ONE OF ITS STRONG POINTS

The bench seat in the Liner is truly multifunctional: the comfortable, generously dimensioned couch can be transformed into a third (Lounge version) or even fourth (Bar version) seat with three-point seat belt in next to no time.

03 TECHNOLOGY

The Liner manages to do what others dream of: it combines innovation with reliability.

It is often the things in the background that allow you to concentrate on the important aspects of life. And this is exactly the case in the Liner as well. As one would expect, the Liner is simply packed with an astounding number of technical innovations. And what do you notice about all of these detailed solutions? Well, nothing initially. Except perhaps for the fact that everything in the Liner works just a little more perfectly than in other motorhomes. The Concorde Liner - allows you to simply concentrate on enjoying your holiday.



CONCORDE. REISEMOBILE AUS LEIDENSCHAFT

DRIVER-ACTIVE DASHBOARD
WITH THE DRIVER SITTING HIGHER
AND FURTHER FORWARD



CONCORDE. REISEMOBILE AUS LEIDENSCHAFT

THE CONCORDE LINER – ALWAYS AHEAD OF THE REST

The Liner will not only prove itself to you at a caravan or camping site, but will have already done so before you get there. Its persuasive arguments include the powerful MAN engine and the driver's "workplace". Specially developed for the Liner, the dashboard nestles around the driver, who sits enthroned above it all in his comfortable microfibre or leather-covered seat with a multitude of adjustment facilities. The air conditioner makes sure that the temperature is just right and the cruise control system fitted as standard ensures that you arrive even more relaxed. Bon voyage!

DRIVING SEAT ADJUSTMENT FACILITIES



CRUISE CONTROL OPERATING LEVER



SINGLE-LEVEL FLOOR THROUGHOUT



HIGH-QUALITY RADIO WITH CD AND MP3 PLAYER

BROADBAND SPEAKERS IN THE CAB



ENTERTAINMENT GUARANTEED

Comprehensive, future-oriented multimedia solutions are on the agenda in the Concorde Liner: the Bluetooth hands-free talking facility integrated into the radio and reversing camera, right through to the digital satellite TV system with multi-user reception and the 20" flat panel displays offer you a multifarious range of high-tech features to customise your own, very personal Liner.

THE BAR SUITE WITH FLAT PANEL
DISPLAY VIEWED THROUGH
THE PANORAMIC ROOF HATCH



CENTRAL CONTROL AND
MONITORING PANEL WITH
LIQUID-CRYSTAL DISPLAY

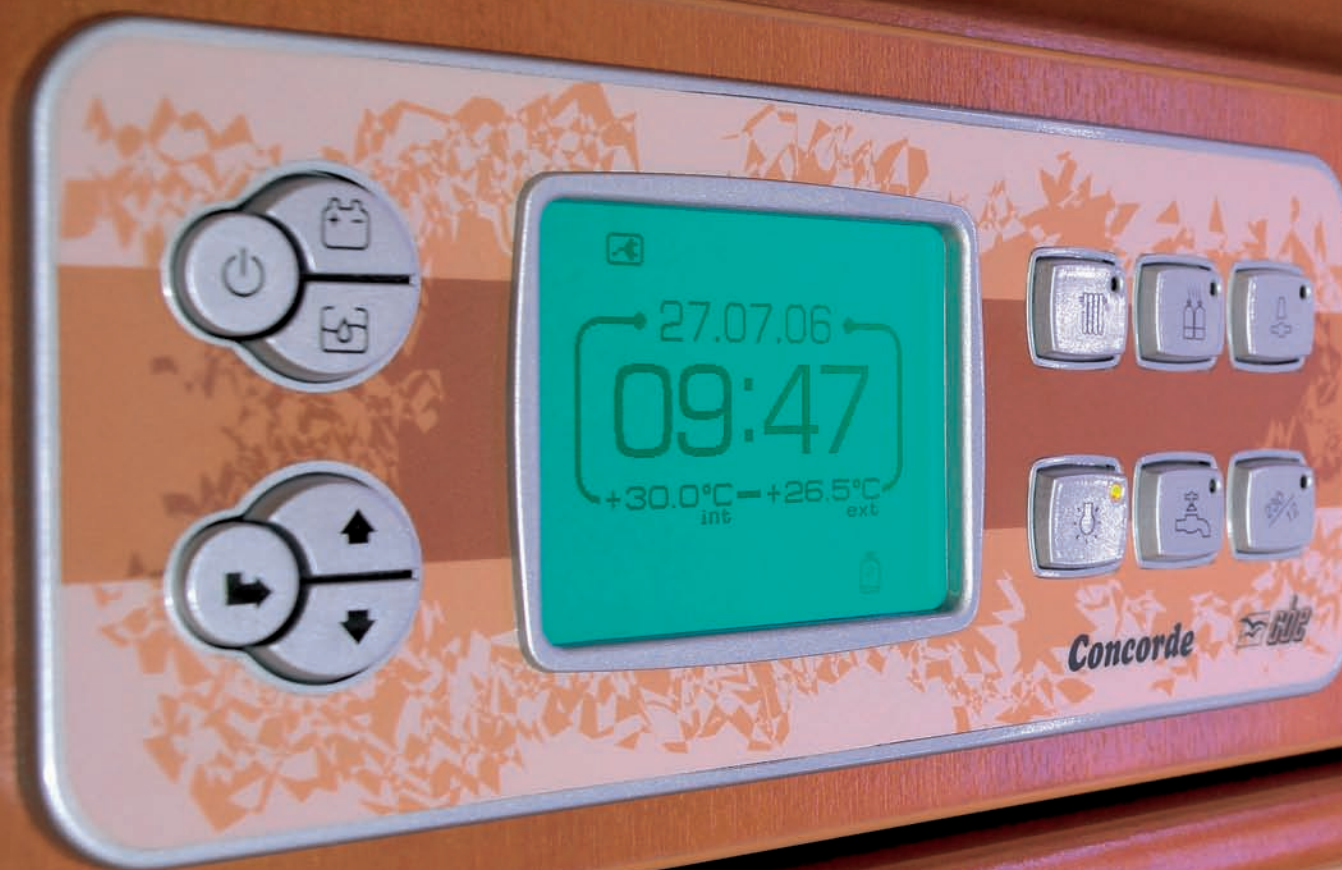

THE LINER - YOU'LL SOON WARM TO IT

The Concorde Liner leaves its rivals out in the cold - you, on the other hand, can make yourself comfortable and rely on the central heating / hot water system with 5500 watts heating capacity to keep you warm. Combined with the optional auxiliary 5200 watts diesel heating system, you can use a time switch to turn the heating on even while you are out. It's nice to know that the Solidtherm® construction of the living area will keep the cosy warmth where it belongs - inside.

GAS REGULATOR WITH AUTOMATIC BOTTLE CHANGEOVER SYSTEM



CONCORDE. REISEMOBILE AUS LEIDENSCHAFT

CENTRAL/AUXILIARY HEATING/HOT-WATER SYSTEM





“SECURITY PLUS” DOOR WITH ILLUMINATED, HEATED DOUBLE STEP

**PERFECTLY ACCESSIBLE
ELECTRICAL SYSTEM**



ENORMOUS, ILLUMINATED REAR GARAGE WITH ALMOST FIVE CUBIC METRES STORAGE CAPACITY

LOTS OF ROOM FOR FASCINATING TECHNOLOGY

The Liner's flaps and hatches conceal another one of its strong points: a seemingly endless amount of storage space. It's good to know that Concorde also makes sure that everything is stowed away securely. This is assured by powder-coated, welded frames to the same extent as the door to the living area, which is equipped with sensors, safety glass and a safe-type combination lock. After all, you can't be too careful.

04 UPHOLSTERY AND FABRICS



DOVE BLUE*

* All colours also available in leather



MINT GREEN*



05 LAYOUTS

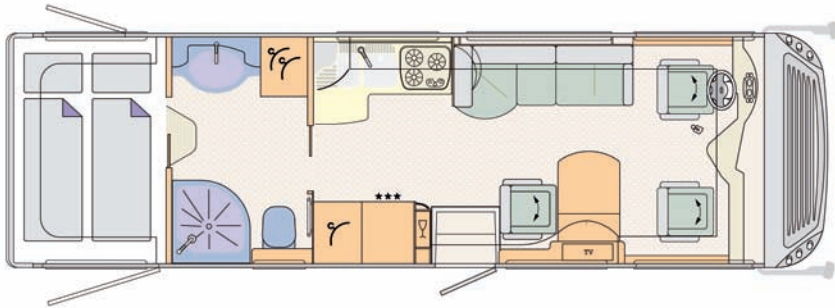

LINER 840 H BAR VERSION

8480 x 2490 x 3480 mm

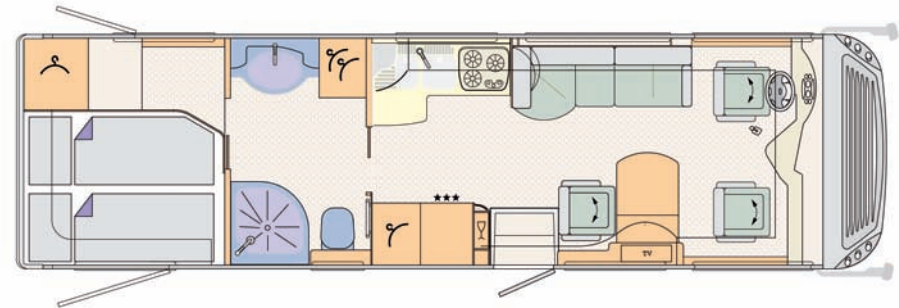

LINER 890 F BAR VERSION

8980 x 2490 x 3480 mm

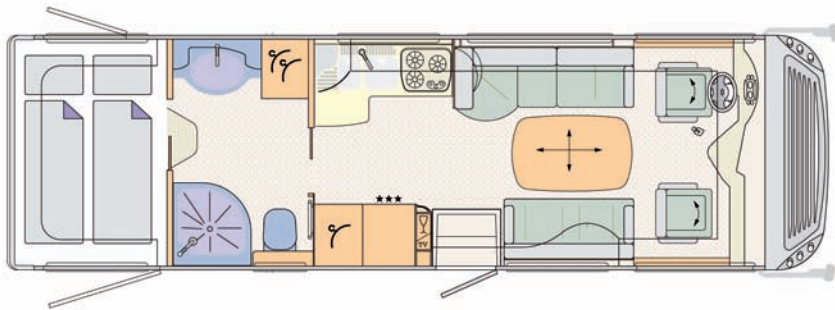

LINER 840 H LOUNGE

8480 x 2490 x 3480 mm

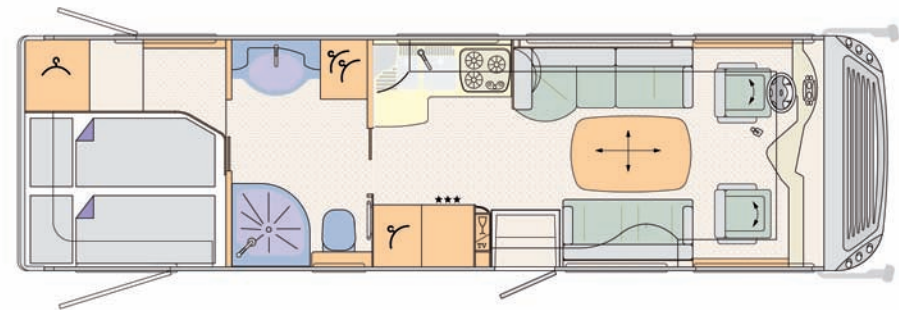

LINER 890 F LOUNGE

8980 x 2490 x 3480 mm

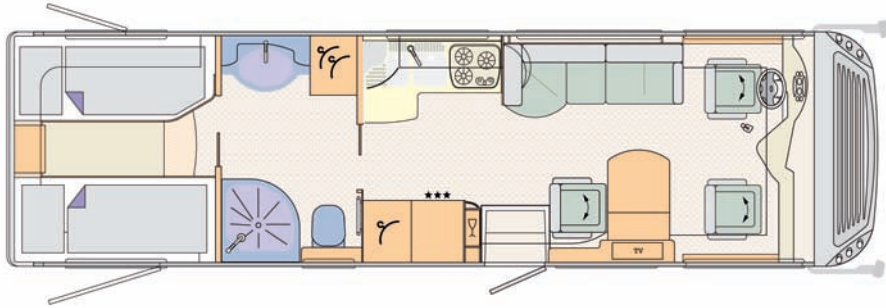

LINER 890 L BAR VERSION

8980 x 2490 x 3480 mm

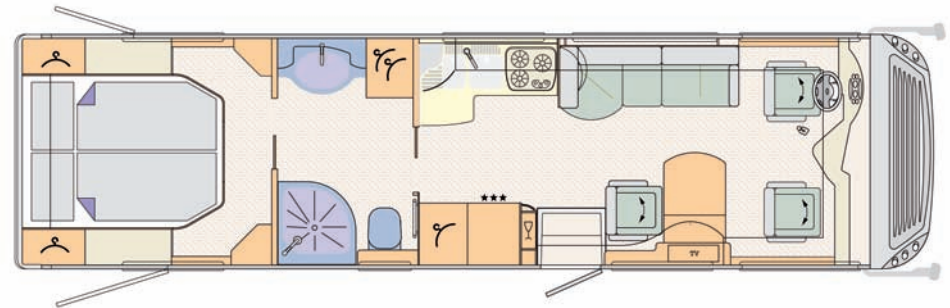

LINER 940 M BAR VERSION

9480 x 2490 x 3480 mm

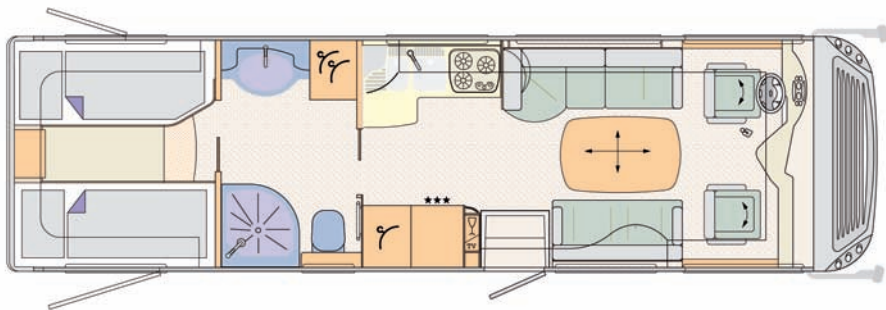

LINER 890 L LOUNGE

8980 x 2490 x 3480 mm

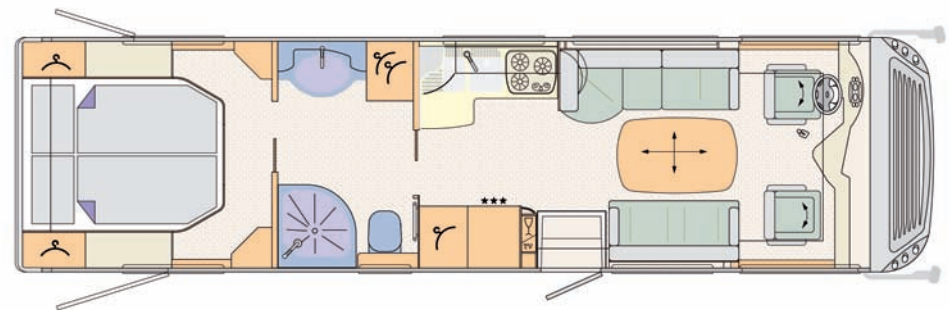

LINER 940 M LOUNGE

9480 x 2490 x 3480 mm

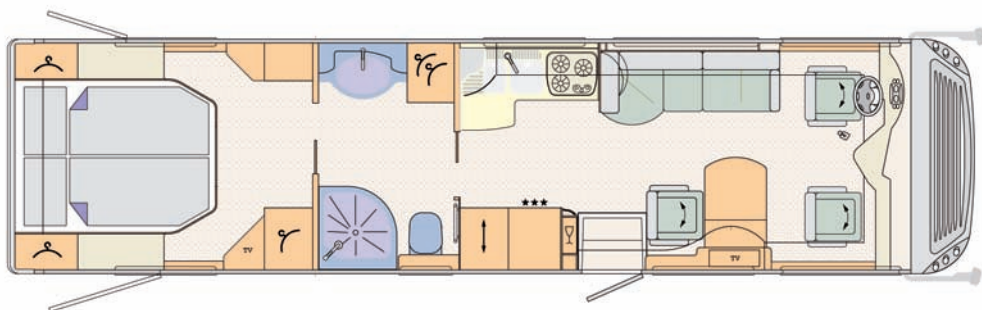

LINER 990 M BAR VERSION

9980 x 2490 x 3480 mm

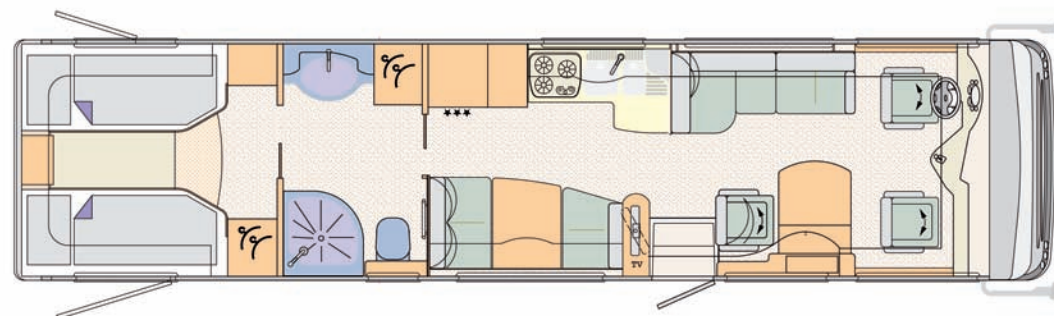

LINER 1040 L BAR VERSION

10480 x 2490 x 3480 mm

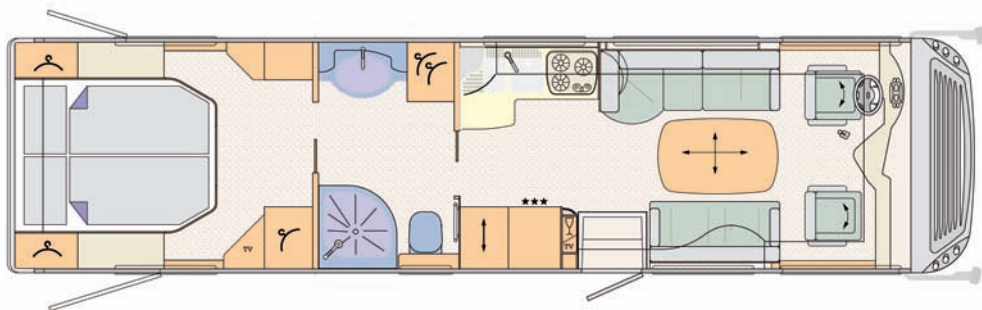

LINER 990 M LOUNGE

9980 x 2490 x 3480 mm

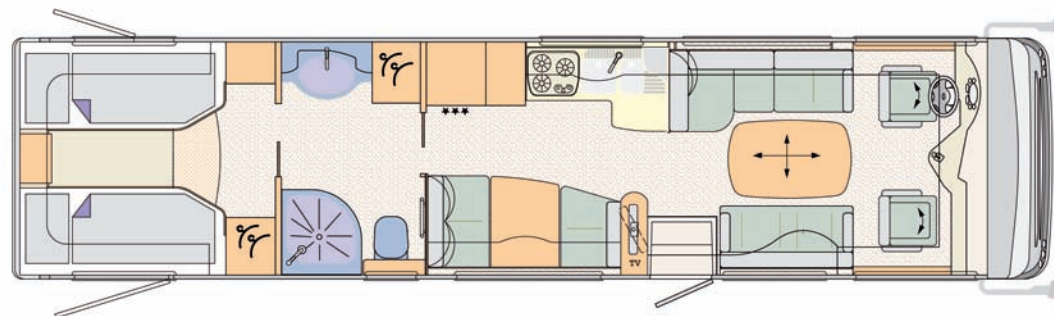

LINER 1040 L LOUNGE

10480 x 2490 x 3480 mm

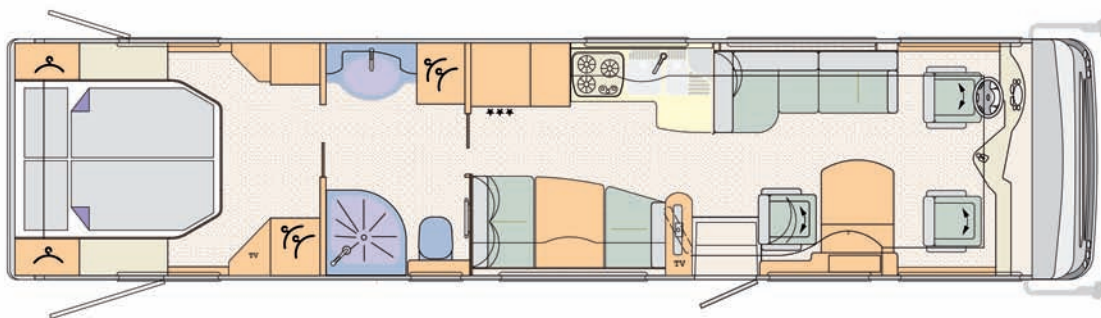

LINER 1090 M BAR VERSION

10980 x 2490 x 3480 mm

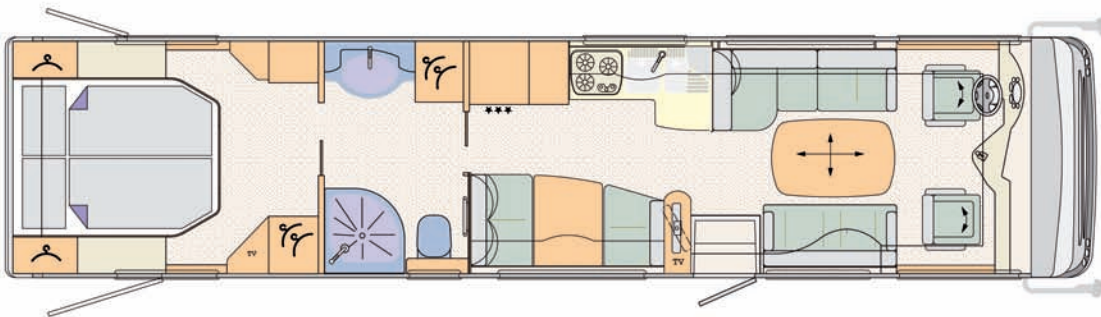

LINER 1090 M LOUNGE

10980 x 2490 x 3480 mm

PUBLISHED BY

Concorde Reisemobile GmbH
Concorde Strasse 2-4
D-96132 Schlüsselfeld-Aschbach
Phone ++49(0) 95 55 / 92 25-0
Fax ++49(0) 95 55 / 92 25-44
Web site: www.concorde.eu
eMail: info@concorde.eu

CONCEPT AND EDITORIAL

Medienagentur Punktgenau
Feldmochinger Straße 36
80992 München
Phone ++49(0) 89 / 14 34 30 88
Fax ++49(0) 89 / 14 34 30 89
Web site: www.medienagentur-punktgenau.de
eMail: info@medienagentur-punktgenau.de

ART DIRECTION

Andreas Croonenbroeck

PHOTOGRAPHS

Elmar Hahn Studios, Veitshöchheim

COPYRIGHTS

All of the text passages and photographs, drawings and illustrations contained in this brochure are protected by copyright. All rights reserved. May only be reprinted with the publisher's prior consent in writing.

DISCLAIMER

All of the information in this brochure is in accordance with the status of series production at the time of going to press. Deviations in structure and colour compared with the furnishings shown in the photographs are reserved to the extent that these are due to the nature of the materials used and are customary in the trade. The same applies to technical modifications to the vehicle, as long as the quality of the product remains the same or is improved, and the intended purpose is not adversely affected. Some photographs contain special options available at an extra charge.

Printed in August 2007



Concorde

REISEMOBILE AUS LEIDENSCHAFT

Concorde Reisemobile GmbH

Concorde-Strasse 2-4, 96132 Schlüsselfeld-Aschbach, Germany

Phone ++49(0) 95 55 / 92 25-0 - Fax ++49(0) 95 55 / 92 25-44

Web site: www.concorde.eu

eMail: info@concorde.eu