

2022

FENDT

CARAVAN



SAPHIR • BIANCO • TENDENZA • OPAL • DIAMANT

www.fendt-caravan.com



SAPHIR • BIANCO • TENDENZA • OPAL • DIAMANT

CONTENTS

- 04 *Over 50 years of quality with conviction – the inner qualities*
- 08 *Individual accessories*
- 10 *Saphir – your companion for a perfect holiday*
- 24 *Bianco – modern caravans to suit all tastes*
- 38 *Tendenza – stay trendy on the go in a designer caravan*
- 52 *Opal – holiday time with extra comfort*
- 66 *Diamant – your jewel*
- 80 *Quality with conviction – unmistakable exterior design*
- 84 *Standard fittings – chassis, outside bodywork*
- 86 *Bed overview*
- 88 *Dimensions and weights of all model ranges*
- 91 *Symbols explained*



Fly-screen door
Silent and extendable,
can be retracted without
losing space in the door
frame (certain models
only)



Bench end drop hatch
Easily accessible for convenient
loading and unloading (certain
models only)



Bench partition
Improved loading, good
accommodation of large
quantities of luggage



Spring-core seat upholstery
(Diamant) In comfort quality



Smoke detector
High-quality design, optimal
position, warns of fire risk at
an early stage



Power outlets
Optimal position, easy to reach



LED lighting
Energy-saving LED technology,
arranged for harmonious and
atmospheric lighting effects



PVC flooring
Practical, durable,
easy to care for



**Hinged window that can be
operated with one hand**
and combined fly-screen/blackout
roller blind, double glazed and
tinted

WHERE WE ARE IS ON HOLIDAY – THE DIFFERENCE IS IN THE DETAILS



Upholstery

Quality moulded upholstery with high density
and elasticity that offers long-lasting comfort
when sitting and relaxing and has ergonomic
and comfortable back padding

Winter backrests

Increased ventilation during winter thanks to
additional wall aerators – prevents freezing on
cold windows

Fabrics

Quality fabrics made from flat
weaves with a very high resistance
to abrasion, low-maintenance and
robust

Air recirculation system with vent

Optimal air circulation, prevents
moisture build-up

Single-leg table, fully adjustable in height

Easier access to the round seating area, optimal
use of the longitudinal bench, more legroom in
the seating area, modern appearance
(certain models only)

Corner ventilation

For the perfect indoor climate, counteracts the
build-up of condensation without inconvenient
drafts

GOOD SLEEP – GOOD MOOD



Interior-sprung mattress
(Standard in Saphir, Bianco Selection, Bianco Activ)
Strengthened 5-turn Bonell spring core with elastic moulded upholstery and comfortable climate-control fleece on both sides



Hinged window
Well cooled in the summer, comfortably warm in the winter thanks to the double-glazed, tinted and insulated windows



LED reading spot lights
Partially tiltable with individual switches, they ensure precisely targeted, flicker-free bright light



7-zone comfort foam mattress
(Standard in Tendenza and Opal, available as an optional extra with all other series)
With excellent reclining properties thanks to the comfortable shoulder zone, lumbar support and a special ventilation system



Storage compartments with rear ventilation
and robust, high-quality hinges with a strong tilting and locking force; generous storage space, which also ensures good climate control



Winter back rests with spacing
Protects effectively against cold conditions in winter, prevents condensation, excellent circulation of warm air for an optimal indoor climate

QUALITY IN SERIES

Lift-O-Mat
gas-pressure dampers and a stable mechanism with hold function facilitate handling when opening and closing the bed frame



High-quality switch
Easily accessible, conveniently located



Additional ventilation
For perfect air circulation, prevents build-up of condensation and avoids cold spots



7-zone climate control foam mattress
(Standard in Diamant, available as an optional extra with all other series)
Excellent elasticity and breathability, special lumbar support and body temperature management with quilted elastic fibres with climate control



Slatted bed base
With a permanently elastic joint bridge and hardness adjustment, narrow slat spacing



Extendable slatted bed base and bed filler
Both together, as optional extras, maximise the bed surface, and the conversion is quick thanks to easy handling



Combi 4 E * or 6 E heating * (only available as an optional extra with Combi 4 and Combi 6 as standard)

Warm air flowing into the vehicle via four air outlets is evenly distributed, providing a perfect feel-good climate. Design includes integrated electric heating elements, also works with empty water tank, FrostControl drain valve installed, simple to operate via the CP plus iNet ready digital control panel or via the Truma App thanks to installation of the iNet Box as standard. Boost function for a quick supply of hot water and room heating



Air conditioning *

Impresses thanks to the individual setting options: outlets can be adjusted in a multitude of ways so that the cool air flows where it is needed. Excellent cooling performance and fast dehumidification, simple to control via "CP Plus" or via the Truma app (if iNet Box is standard)



REMOTE CONTROL FROM HOME OR ON THE GO

Convenient and easy.

iNET BOX in all models with C-heating. Additional control options via the Truma app (depending on the country).

- Control iNet-enabled devices via app from up to four smartphones
- Control iNet-enabled devices via Bluetooth at close range or via SMS on the go
- Automatic climate control in conjunction with the CP plus iNet ready digital control panel
- Query the status of the on-board equipment
- Query the operating status of the devices
- Display when a set temperature or on-board voltage is not met



"Sky" TV bracket * (as standard in the Diamant)

TV wall bracket, lockable, with twist and swivel options for comfortably watching TV in various positions



Fullstop mechanical anti-theft protection *

Simple and effective, this anti-theft device protects the caravan from unauthorised access. This engine immobiliser is quick and easy to install



Bicycle rack for the drawbar (Thule) *

Foldable, suitable for 2 bicycles or 2 e-bikes, loads up to 60 kg, equipped with a comfort locking device and a bicycle mount lock to protect against theft



External gas outlet *

Enables external gas-based appliances to be connected, such as gas grills or gas lamps



Universal awning outlet *

For supply of electricity outside the caravan (230 V/12 V and TV connection)



City water connection *

With pressure reduction and a 45-litre fresh water tank, for direct connection to the public water network

Self-sufficient packages * (not illustrated)

This way, the caravan can also function away from the campsite for short periods. Different variants with 55 Ah or 75 Ah batteries and a charging booster for charging while driving are available

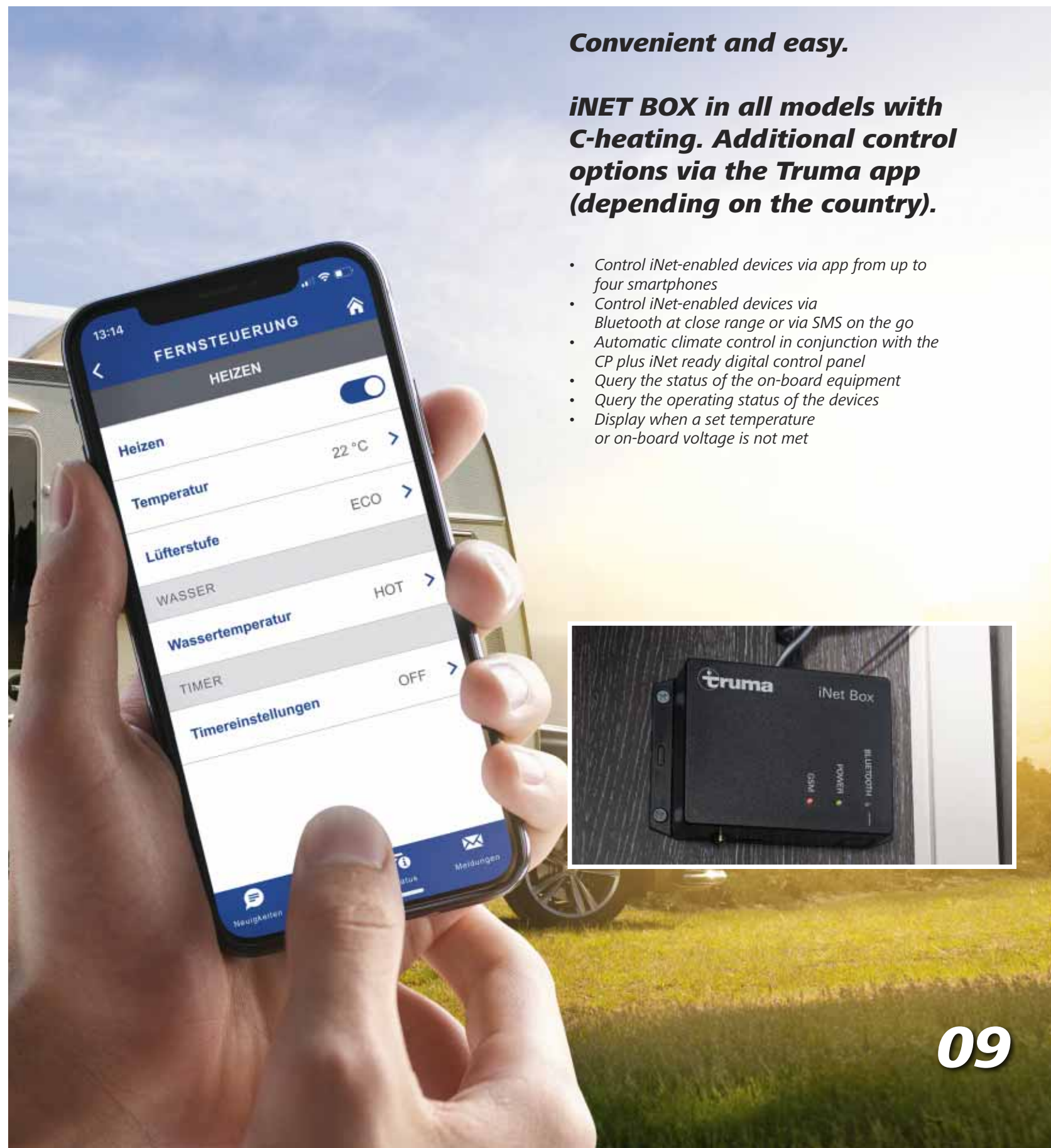

INDIVIDUAL ACCESSORIES

* Additional equipment subject to a charge

***THE COMPANION
FOR A PERFECT HOLIDAY***



SAPHIR

**COMFORT
YOU'LL LOVE**

SAPHIR 495 SFB / CARDIFF

13



495 SKM / AOSTA



465 TG / CARDIFF

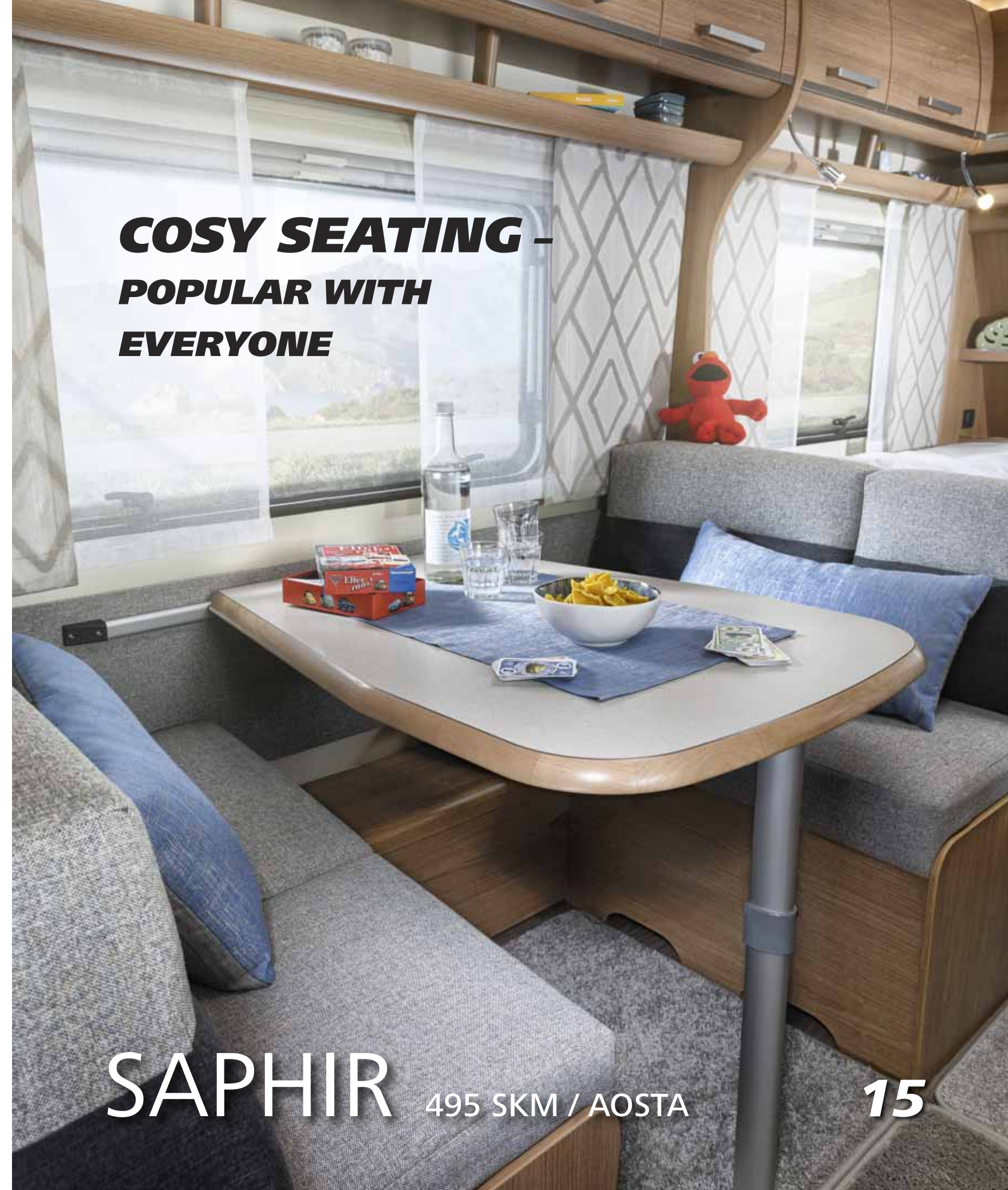

***COSY SEATING -
POPULAR WITH
EVERYONE***

SAPHIR 495 SKM / AOSTA

***THIS IS HOW SLEEP
BECOMES PURE PLEASURE***

SAPHIR 495 SKM



495 SFB

17



495 SKM



495 SKM



495 SKM

**YOUR HOLIDAY
KITCHEN FOR
GOURMET MOMENTS**

SAPHIR

19

Special features of the SAPHIR

- Stove/sink combination with safety pilot, automatic ignition, split cast iron grate and split glass cover (3-burner)
- 98 L or 133 L refrigerators
- A wide variety of seating arrangements, including central seating areas
- Attractive bunk bed options
- TRUMA S 3004 or S 5004 gas heating
- Depending on the layout, shower cubicle and a wide variety of washroom variants
- Comfortable, robust interior-sprung mattresses for single and French beds
- Warm Chestnut-Moretti furniture decor; the fabric options (see page 12–15) Aosta and Cardiff are available to choose from



465 TG



495 SFB



495 SKM

Living room/sleeping area

- Furniture in "Chestnut-Moretti" decor
- Upholstery variants (see page 12–15) "Aosta" or "Cardiff"
- LED lighting
- Ceiling lamp (LED/12 V) with 2 circuits
- Single-leg lifting table in the round seating area *
- Folding sliding door
- Clothes rack in the sleeping area *
- Indirect lighting (LED)
- Slatted bed base with fully flexible and permanently elastic joint bridges and hardness adjustment (single and French beds)
- Reading spotlights (12 V) in the round seating area *
- Reading spotlights (12 V) in the sleeping area
- Lift-O-Mat (single and French beds)
- Mattresses: interior-sprung (single and French beds)
- MIDI roof hood (Dometic) with crank, forced ventilation, integrated blackout pleated blind and roller fly-screen
- PVC flooring, hard-wearing, easy to care for
- Ergonomically shaped back padding
- High density seat upholstery
- Ventilated storage compartments with indirect ceiling lighting (LED)
- Carpet in the door sill with the Fendt Caravan logo
- Winter backrests

Kitchen/bathroom

- Waste collector integrated into the entrance door
- Workplace lighting (LED)
- Bathroom lighting (LED/12 V)
- Cutlery inserts with a soft-touch surface
- Shower cubicle *
- Towel/clothes hooks and toilet paper holder
- Stove/sink combination with safety pilot, automatic ignition, split cast iron grate and split glass cover (3-burner)
- Comfort pleated roller blind on the kitchen window
- Kitchens with large drawers *
- Refrigerator (98 L), can be opened on both sides, with removable freezer compartment and interior lighting *
- Slim tower refrigerator (133 L), can be opened from both sides, with removable freezer compartment and interior lighting *
- Brass kitchen mixer tap
- Central washrooms * with large wall units, generous shelves under the sink and an illuminated mirror
- Mirror cabinet in the open bathroom *
- Flush toilet with diode level indicator and holding tank (rollable) *
- Kitchen and bathroom storage compartments with soft-close hinges
- White washbasin with shelves, bathroom cabinet and illuminated mirror
- Washroom window, hinged, made of frosted glass with blackout and fly-screen roller blind

Water

- Mobile waste water tank (24 L)
- Fresh water (fixed tank 10^d/25^e litres) with external filling *
- Fresh water (fixed tank 10^d/45^e litres) with external filling *
- Fresh water level indicator
- Truma-Therme 230 V water heating with mixer tap

Multimedia

- TV cabling (230 V socket)

Technology/heating/air conditioning

- Truma gas heating S 3004 and S 5004 with automatic ignition *
- Smoke detector
- Switch on the entrance door for the ceiling light and awning light
- Switching power supply 350 W
- Fuse box (230 V) with residual current device (safety switch)
- Spot light(s) (LED/12 V)
- 230 V sockets
- Warm air system with fan (1 x 12 V) *
- Warm air system with fan (2 x 12 V) *

* certain models only

For an explanation of the symbols, see page 91

SAPHIR

QUALITY IN SERIES



465 TG



465 SFB	
Total length	cm 705
Total width	cm 232
Sleeping spaces	4
Technically permitted total mass	kg 1500 ^{g)}
Mass in running order	kg ^{c)} 1289

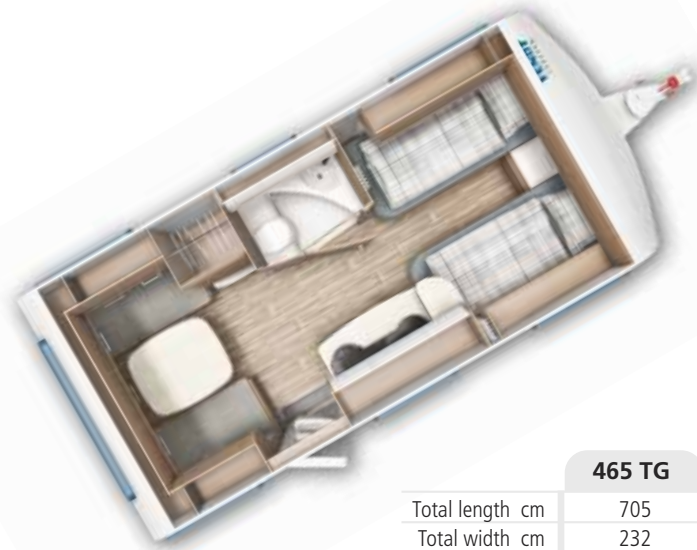

465 TG	
Total length	cm 705
Total width	cm 232
Sleeping spaces	4
Technically permitted total mass	kg 1500 ^{g)}
Mass in running order	kg ^{c)} 1291



495 SFB	
Total length	cm 724
Total width	cm 232
Sleeping spaces	4
Technically permitted total mass	kg 1600 / 1700 ^{h) g)}
Mass in running order	kg ^{c)} 1333

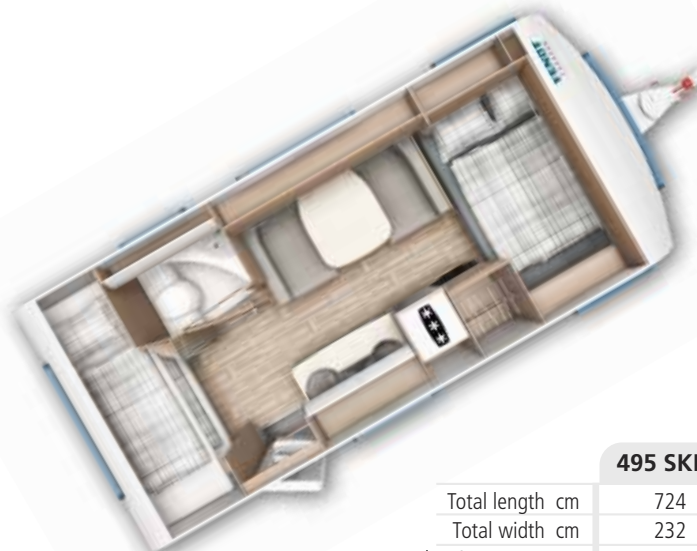

495 SKM	
Total length	cm 724
Total width	cm 232
Sleeping spaces	5
Technically permitted total mass	kg 1600 / 1700 ^{h) g)}
Mass in running order	kg ^{c)} 1367



515 SG	
Total length	cm 753
Total width	cm 232
Sleeping spaces	4
Technically permitted total mass	kg 1600 / 1700 ^{h) g)}
Mass in running order	kg ^{c)} 1424



560 SKM	
Total length	cm 774
Total width	cm 250
Sleeping spaces	5
Technically permitted total mass	kg 1700 ^{g)}
Mass in running order	kg ^{c)} 1494



In all Saphir floor plans: reading spotlights (12 V) in the bedroom

SAPHIR LAYOUTS AND DIMENSIONS

Scan QR code
to watch a film about the Saphir



Dimensions and weights of all model ranges and models from page 88
Explanation of the symbols on page 91

**BIANCO –
MODERN CARAVANS
TO SUIT EVERY TASTE**

BIANCO



***COMFORT IN AN
ATTRACTIVE AMBIENCE***

BIANCO ACTIV 465 SFH / ZINGARO

27



ACTIV 550 SD / ZINGARO



ACTIV 390 FHS / ZINGARO

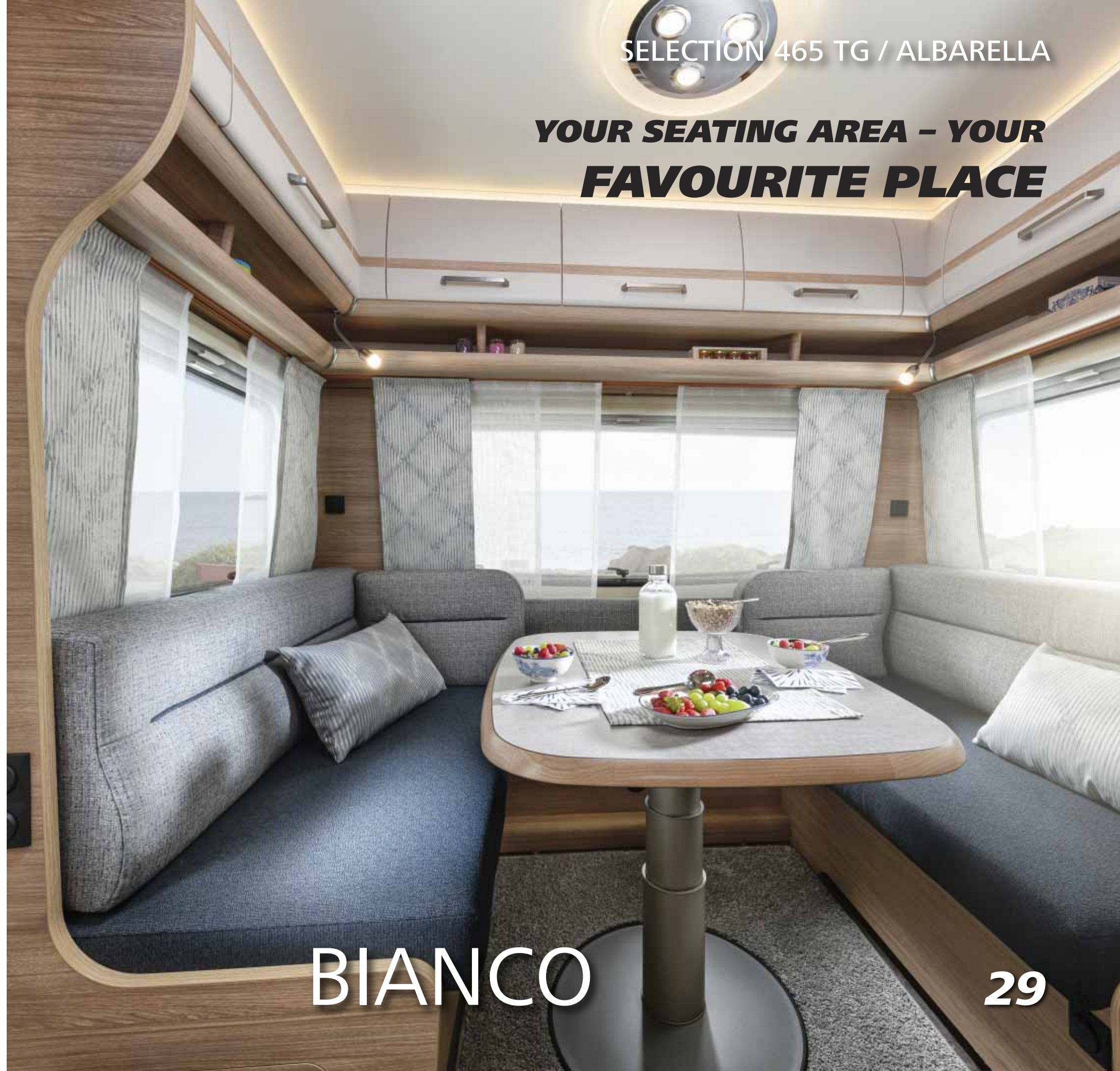

SELECTION 465 TG / ALBARELLA

***YOUR SEATING AREA – YOUR
FAVOURITE PLACE***

BIANCO



**THE RIGHT BED
FOR EVERYONE**

BIANCO

ACTIV 550 SD



ACTIV 515 SGE



ACTIV 720 SKDW

31



SELECTION 465 TG



ACTIV 515 SD



ACTIV 515 SD

**YOUR PERSONAL
BEAUTY SALON**

BIANCO

Special features of the BIANCO SELECTION and ACTIV

- Among others, the Bianco offers five children's room layouts, one with hot water heating and hot water underfloor heating
- 3-burner stove or stove/sink combinations *
- 98 L or 133 L refrigerators
- A wide variety of seating arrangements, including central seating areas
- TRUMA S 3004 or S 5004 gas heating with automatic ignition (Bianco Selection) *
- Various washroom variants
- Comfortable, robust interior-sprung mattresses for single and French beds
- The light "Tiberino" furniture decor creates a very harmonious effect with each of the fabric options (see pages 26-29) "Albarella" and "Zingaro"



ACTIV 515 SD



ACTIV 390 FHS



ACTIV 390 FHS



ACTIV 720 SKDW

Additional standard fittings for the BIANCO ACTIV

- Truma Combi 4 * or Combi 6 * gas heater with CP plus iNet ready digital control panel with circulating air distribution and integrated hot water boiler (10 litre capacity) and iNet Box for the additional option of heating control via the Truma app (depending on the country)
- Side seat as a chest (can carry up to max 100 kg) *
- Lateral loading feature (with separate beds) *
- Increased load capacity due to reinforced chassis
- Wardrobe with lighting (motion sensor)

Living room/sleeping area

- Furniture in the "Tiberino" decor
- Upholstery options (see page 26-29) "Albarella" or "Zingaro"
- LED lighting
- Ceiling lamp (LED/12 V) with 2 circuits
- Single-leg lifting table in the round seating area *
- Folding sliding door *
- Clothes rack in the sleeping area *
- Indirect lighting (LED)
- Slatted bed base with fully flexible and permanently elastic joint bridges and hardness adjustment (single and French beds)
- Reading spotlights (12 V) in the round seating area *
- Reading spotlights (12 V) in the sleeping area
- Lift-O-Mat (single and French beds)
- Mattresses: interior-sprung (single and French beds)
- MIDI roof hood (Dometic) with crank, forced ventilation, integrated blackout pleated blind and roller fly-screen
- PVC flooring, hard-wearing, easy to care for
- Ergonomically shaped back padding with comfortable and high-quality seating foam
- High density seat upholstery
- Ventilated storage compartments with indirect ceiling lighting (LED)
- Carpet in the door sill with the Fendt Caravan logo
- Winter backrests

Kitchen/bathroom

- Waste collector integrated into the entrance door *
- Workplace lighting (LED)
- Oven with grill (gas) ***
- Bathroom lighting (LED/12 V)
- Cutlery inserts with a soft-touch surface
- Shower cubicle *
- Towel/clothes hooks and toilet paper holder
- Stove with safety pilot and automatic ignition (3-burner) ***
- Stove/sink combination with safety pilot, automatic ignition, split cast iron grate and split glass cover (3-burner) *
- Comfort pleated roller blind on the kitchen window *
- Kitchens with large drawers *
- Refrigerator (98 L), can be opened on both sides, with removable freezer compartment and interior lighting *
- Slim tower refrigerator (133 L), can be opened from both sides, with removable freezer compartment and interior lighting *
- Brass kitchen mixer tap *
- Central washrooms * with large wall units, generous shelves under the sink and an illuminated mirror
- Mirror cabinet in the open bathroom *
- Stainless steel sink with glass cover ***
- Flush toilet with diode level indicator and holding tank (rollable) *
- Kitchen and bathroom storage compartments with soft-close hinges
- White washbasin with shelves, bathroom cabinet and illuminated mirror
- Washroom window, hinged, made of frosted glass with blackout and fly-screen roller blind

Water

- Mobile waste water tank (24 L)
- Fresh water (fixed tank 10^d/25^e) litres) with external filling *
- Fresh water (fixed tank 10^d/45^e) litres) with external filling *
- Fresh water level indicator
- Truma-Therme 230 V water heating with mixer tap *

Multimedia

- TV cabling (230 V socket)

Technology/heating/air conditioning

- Truma S 3004 or S 5004 gas heating with automatic ignition (Bianco Selection) *
- Truma Combi 4 or Combi 6 gas heating (Bianco Activ) *
- iNet Box for the additional option of heating control via the Truma app (depending on the country) (Bianco Activ)
- Smoke detector
- Switch on the entrance door for the ceiling light and awning light
- Switching power supply 350 W
- Fuse box (230 V) with residual current device (safety switch)
- Spot light(s) (LED/12 V)
- 230 V sockets
- Warm air system with fan (1 x 12 V) (Bianco Selection)
- Hot water heating and hot water underfloor heating (Alde) ***

* certain models only *** ACTIV 720 SKDW
For an explanation of the symbols, see page 91

BIANCO

QUALITY IN SERIES

35

SELECTION



465 SFB	
Total length	cm 705
Total width	cm 232
Sleeping spaces	4
Technically permitted total mass	kg 1500 ^{g)}
Mass in running order	kg ^{c)} 1277

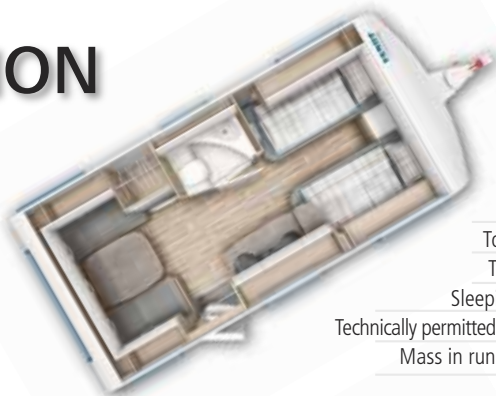

465 TG	
Total length	cm 705
Total width	cm 232
Sleeping spaces	4
Technically permitted total mass	kg 1500 ^{g)}
Mass in running order	kg ^{c)} 1285

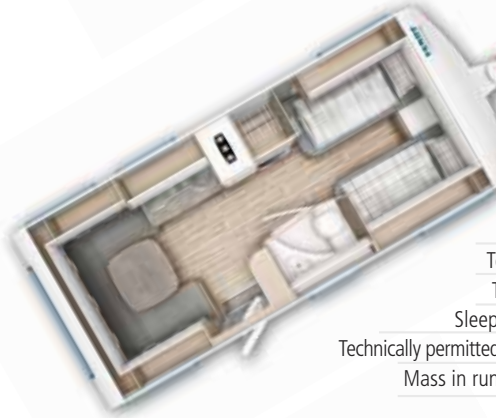

515 SG	
Total length	cm 753
Total width	cm 232
Sleeping spaces	4
Technically permitted total mass	kg 1600 / 1700 ^{h) g)}
Mass in running order	kg ^{c)} 1399

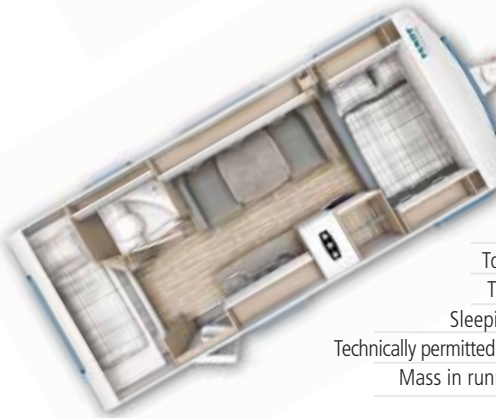

515 SKM	
Total length	cm 753
Total width	cm 232
Sleeping spaces	5
Technically permitted total mass	kg 1600 / 1700 ^{h) g)}
Mass in running order	kg ^{c)} 1408



Scan QR code
and watch a film about the Bianco

Dimensions and weights of all model ranges and models from page 88
Explanation of the symbols on page 91

ACTIV



390 FHS	
Total length	cm 605
Total width	cm 232
Sleeping spaces	3
Technically permitted total mass	kg 1500 ^{g)}
Mass in running order	kg ^{c)} 1173



445 SFB	
Total length	cm 679
Total width	cm 232
Sleeping spaces	4
Technically permitted total mass	kg 1500 ^{g)}
Mass in running order	kg ^{c)} 1277

ACTIV

New layout



465 SFH	
Total length	cm 705
Total width	cm 232
Sleeping spaces	3
Technically permitted total mass	kg 1600 / 1700 ^{h) g)}
Mass in running order	kg ^{c)} 1336



515 SD	
Total length	cm 753
Total width	cm 232
Sleeping spaces	3
Technically permitted total mass	kg 1700 ^{g)}
Mass in running order	kg ^{c)} 1392

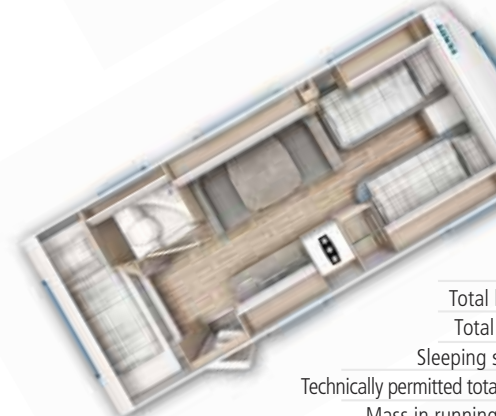

550 KMG	
Total length	cm 774
Total width	cm 232
Sleeping spaces	5
Technically permitted total mass	kg 1700 ^{g)}
Mass in running order	kg ^{c)} 1462



560 SKM	
Total length	cm 774
Total width	cm 250
Sleeping spaces	5
Technically permitted total mass	kg 1700 ^{g)}
Mass in running order	kg ^{c)} 1499

New layout



465 SGE	
Total length	cm 705
Total width	cm 232
Sleeping spaces	2
Technically permitted total mass	kg 1600 / 1700 ^{h) g)}
Mass in running order	kg ^{c)} 1356



515 SGE	
Total length	cm 753
Total width	cm 232
Sleeping spaces	4
Technically permitted total mass	kg 1700 ^{g)}
Mass in running order	kg ^{c)} 1409



550 SD	
Total length	cm 774
Total width	cm 232
Sleeping spaces	4
Technically permitted total mass	kg 1700 ^{g)}
Mass in running order	kg ^{c)} 1411

New layout



720 SKDW	
Total length	cm 925
Total width	cm 250
Sleeping spaces	6
Technically permitted total mass	kg 2200 ^{g)}
Mass in running order	kg ^{c)} 1923

**STAY TRENDY ON THE GO IN A
DESIGNER CARAVAN**



TENDENZA

***WELLBEING IN
EXQUISITE SURROUNDINGS***

TENDENZA 515 SG / CORDOBA

41



515 SG / CORDOBA



650 SFD / STUDIO-LINE VIESTE

650 SFD / STUDIO-LINE VIESTE

**AMAZING
ATMOSPHERE
FOR EVERY OCCASION**



TENDENZA

43



**PURE
DECELERATION**

TENDENZA

515 SG



515 SG



650 SFD

45

650 SFD



TENDENZA

515 SG



**MODERN KITCHEN
TECHNOLOGY THAT'S
RIGHT ON TREND**



Special features of the TENDENZA

- Ovens with grill function (650 SFD, 650 SFDW)
- 3-burner stove or stove/sink combinations *
- Two layouts with a queen bed (650 SFD and 650 SFDW)
- Shower cubicle and a wide variety of washroom variants (depending on the layout)
- 12 V reading spotlights
- Truma Combi 4 * or Combi 6 gas heater (650 SFD) with CP plus iNet ready and iNet Box for the additional option of heating control via the Truma app (depending on the country) as well as a TFT touch panel in a glass look (CI-BUS on-board management)
- Hot water heating and hot water underfloor heating (Alde) (650 SFDW)
- 7-zone comfort foam mattresses for single and French beds
- Lounge-style back padding *, seat upholstery in quality comfort foam
- Fly-screen door in the entrance area
- Warm Chesterfield Oak furniture decor; the fabric options (see page 40-43) Cordoba and studio line Vieste are available to choose from



Living room/sleeping area

- Furniture in "Chesterfield Oak" decor
- Upholstery options (see page 40-43) "Cordoba" or studio line "Vieste"
- Lighting in the wardrobe with motion sensor
- LED lighting
- Ceiling lamp (LED/12 V) with 2 circuits, dimmable
- Decorative package (2 cushions/1 table runner)
- Single-leg lifting table in the round seating area
- Folding sliding door
- Fly-screen door in the entrance area
- Clothes rack in the sleeping area
- Indirect lighting (LED)
- Slatted bed base with fully flexible and permanently elastic joint bridges and hardness adjustment (single and French beds) *
- Reading spotlights (12 V) in the round seating area
- Reading spotlights (12 V) in the sleeping area
- Lift-O-Mat (single and French beds)
- Mattresses: comfort foam (7 zones) (single and French beds)
- MIDI roof hood (Dometic) with crank, forced ventilation, integrated blackout pleated blind and roller fly-screen
- PVC flooring, hard-wearing, easy to care for
- Ergonomically shaped back padding *
- Lounge-style back padding *
- Quality comfort foam seating upholstery
- Ventilated storage compartments with indirect ceiling lighting (LED)
- Storage compartments with soft-close hinges
- Carpet in the door sill with the Fendt Caravan logo
- Carpeted floor, bound at the edge and loosely laid
- Winter backrests

Kitchen/bathroom

- Waste collector integrated into the entrance door
- Workplace lighting (LED)
- Oven with grill (gas) **
- Bathroom lighting (LED/12 V)
- Cutlery inserts with a soft-touch surface
- Shower cubicle **
- Towel/clothes hooks and toilet paper holder
- Stove with safety pilot and automatic ignition (3-burner) **
- Stove/sink combination with safety pilot, automatic ignition, split cast iron grate and split glass cover (3-burner) *
- Comfort pleated roller blind on the kitchen window
- Kitchens with large drawers *
- Backlit kitchen rear wall panelling in a glass look
- Slim tower refrigerator (133 L), can be opened from both sides, with removable freezer compartment and interior lighting *
- Slim tower refrigerator (177 L), can be opened from both sides, with removable freezer compartment and interior lighting **
- Brass kitchen mixer tap *
- Central washrooms * with large wall units, generous shelves under the sink and an illuminated mirror
- Mirror cabinet in the open bathroom *
- Stainless steel sink with glass cover **
- Flush toilet with diode level indicator and holding tank (rollable) *
- Mineral composite washbasin with shelves, bathroom cabinet and illuminated mirror *
- Kitchen and bathroom storage compartments with soft-close hinges
- Stainless steel washbasin ** with shelves, bathroom cabinet and illuminated mirror
- Washroom window, hinged, made of frosted glass with blackout and fly-screen roller blind

Water

- Mobile waste water tank (24 L)
- Fresh water (fixed tank 10^d/25^e) litres) with external filling *
- Fresh water (fixed tank 10^d/45^e) litres) with external filling **
- Fresh water level indicator

Multimedia

- TV cabling (230 V socket)

Technology/heating/air conditioning

- Truma Combi 4 * or Combi 6 gas heater (650 SFD) with CP plus iNET ready digital control panel with circulating air distribution and integrated hot water boiler (10 L capacity) *
- iNet Box for the additional option of heating control via the Truma app (depending on the country)
- Smoke detector
- Switch on the entrance door for the ceiling light
- Switching power supply 350 W
- Fuse box (230 V) with residual current device (safety switch)
- Spot light(s) (LED/12 V)
- 230 V sockets
- TFT touch panel (central) in a glass look (CI-BUS on-board management)
- Hot water heating and hot water underfloor heating (Alde) ***

* certain models only ** for 650 SFD, 650 SFDW

*** for 650 SFDW

For an explanation of the symbols, see page 91



TENDENZA

QUALITY IN SERIES



In all Tendenza layouts: TFT touch panel (central) in a glass look (CI-BUS on-board management)



465 SFB	
Total length	cm 705
Total width	cm 232
Sleeping spaces	4
Technically permitted total mass	kg 1500 ^{g)}
Mass in running order	kg ^{e)} 1319



515 SG	
Total length	cm 753
Total width	cm 232
Sleeping spaces	4
Technically permitted total mass	kg 1700 ^{g)}
Mass in running order	kg ^{e)} 1433

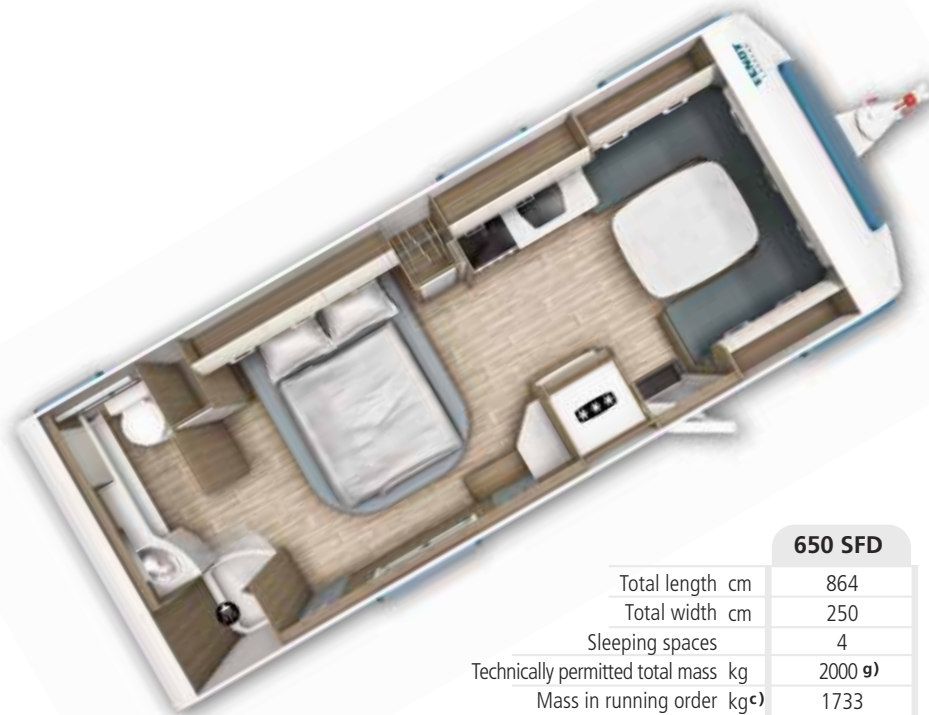

650 SFD	
Total length	cm 864
Total width	cm 250
Sleeping spaces	4
Technically permitted total mass	kg 2000 ^{g)}
Mass in running order	kg ^{e)} 1733



650 SFDW	
Total length	cm 864
Total width	cm 250
Sleeping spaces	4
Technically permitted total mass	kg 2200 ^{g)}
Mass in running order	kg ^{e)} 1775

TENDENZA

LAYOUTS AND DIMENSIONS

Scan QR code
and watch a film on the Tendenza



Dimensions and weights of all model ranges and models from page 88
Explanation of the symbols on page 91

**HOLIDAY TIME WITH
EXTRA COMFORT**



OPAL

53

***JUST SIT DOWN
AND RELAX***

OPAL 560 SRF / STUDIO-LINE DENIA

55

***SNUG AREAS
TO RELAX***



OPAL

560 SRF / STUDIO-LINE DENIA



560 SRF / STUDIO-LINE DENIA



550 SG / MARGHERA

57



515 SKF



550 SG



**BEST
BEDDED**

OPAL 560 SRF

59

**HERE YOU CAN ENJOY
BEING THE CHEF**



OPAL

560 SRF



515 SKF



515 SKF

61

Special features of the OPAL

- Stove/sink combination with safety pilot, automatic ignition, split cast iron grate and split glass cover
- One layout with an L-shaped kitchen (560 SRF)
- One layout with a bunk bed (515 SKF)
- Indirect lighting above the roof storage compartments
- Reading spotlights (12 V)
- Truma Combi 4 (515) or Combi 6 (from 550) gas heater, each with CP plus iNet ready digital control panel with air circulation and integrated hot water boiler (10 L capacity)
- iNet Box for the additional option of heating control via the Truma app (depending on the country)
- 7-zone comfort foam mattresses for single and French beds
- Fly-screen door in the entrance area
- Elegant Chestnut Cilento furniture decor; the fabric options (see page 54-57) Marghera and studio line Denia are available to choose from



Living room/sleeping area

- Furniture in "Chestnut Cilento" decor
- Upholstery options (see page 54-57) "Marghera" or studio line "Denia"
- Lighting in the wardrobe with motion sensor
- LED lighting
- Ceiling lamp (LED/12 V) with 2 circuits
- Decorative package (2 cushions/1 table runner)
- Single-leg lifting table in the round seating area *
- Folding sliding door *
- Fly-screen door in the entrance area
- Clothes rack in the sleeping area *
- Wooden sliding door *
- Indirect lighting (LED)
- Indirect lighting above the roof storage compartments
- Slatted bed base with fully flexible and permanently elastic joint bridges and hardness adjustment (single and French beds)
- Reading spotlights (12 V) in the round seating area
- Reading spotlights (12 V) in the sleeping area
- Lift-O-Mat (single and French beds) *
- Mattresses: comfort foam (7 zones) (single and French beds)
- MIDI roof hood (Dometic) with crank, forced ventilation, integrated blackout pleated blind and roller fly-screen
- PVC flooring, hard-wearing, easy to care for
- Ergonomically shaped back padding
- Quality comfort foam seating upholstery
- Ventilated storage compartments with indirect ceiling lighting (LED)
- Storage compartments with soft-close hinges
- Carpet in the door sill with the Fendt Caravan logo
- Carpeted floor, bound at the edge and loosely laid
- Winter backrests

Kitchen/bathroom

- Waste collector integrated into the entrance door
- Workplace lighting (LED)
- Bathroom lighting (LED/12 V)
- Cutlery inserts with a soft-touch surface
- Towel/clothes hooks and toilet paper holder
- Stove/sink combination with safety pilot, automatic ignition, split cast iron grate and split glass cover (3-burner)
- Comfort pleated roller blind on the kitchen window
- Kitchens with large drawers *
- Slim tower refrigerator (133 L), can be opened from both sides, with removable freezer compartment and interior lighting
- Brass kitchen mixer tap
- Central washrooms * with large wall units, generous shelves under the sink and an illuminated mirror
- Mirror cabinet in the open bathroom *
- Flush toilet with diode level indicator and holding tank (rollable)
- Kitchen and bathroom storage compartments with soft-close hinges
- Mineral composite washbasin with shelves, bathroom cabinet and illuminated mirror
- Washroom window, hinged, made of frosted glass with blackout and fly-screen roller blind

Water

- Mobile waste water tank (24 L)
- Fresh water (fixed tank 10^{d)}/25^{e)} litres) with external filling *
- Fresh water (fixed tank 10^{d)}/45^{e)} litres) with external filling *
- Fresh water level indicator

Multimedia

- TV cabling (230 V socket)

Technology/heating/air conditioning

- Truma Combi 4 (515) or Combi 6 (from 550) gas heater, each with CP plus iNET ready digital control panel with air circulation and integrated hot water boiler (10 L capacity)
- iNet Box for the additional option of heating control via the Truma app (depending on the country)
- Smoke detector
- Switch on the entrance door for the ceiling light and awning light
- Switching power supply 350 W
- Fuse box (230 V) with residual current device (safety switch)
- Spot light(s) (LED/12 V)
- 230 V sockets

* certain models only
 For an explanation of the symbols, see page 91





515 SG	
Total length cm	753
Total width cm	232
Sleeping spaces	4
Technically permitted total mass kg	1700 ^g
Mass in running order kg ^{c)}	1424



515 SKF	
Total length cm	753
Total width cm	232
Sleeping spaces	5
Technically permitted total mass kg	1700 ^g
Mass in running order kg ^{c)}	1462



In all Opal floor plans: reading spotlights (12 V) in the bedroom



550 SG	
Total length cm	774
Total width cm	232
Sleeping spaces	4
Technically permitted total mass kg	1700 ^g
Mass in running order kg ^{c)}	1455



560 SG	
Total length cm	774
Total width cm	250
Sleeping spaces	4
Technically permitted total mass kg	1700 / 1800 ^{h) g}
Mass in running order kg ^{c)}	1538



560 SRF	
Total length cm	774
Total width cm	250
Sleeping spaces	4
Technically permitted total mass kg	1700 / 1800 ^{h) g}
Mass in running order kg ^{c)}	1522

OPAL LAYOUTS AND DIMENSIONS

Scan QR code
and watch a film about the Opal



Dimensions and weights of all model ranges and models from page 88
Explanation of the symbols on page 91

**DIAMANT –
YOUR JEWEL**



DIAMANT

***STYLISH,
LUXURY DESIGN***

DIAMANT 560 SF / SALINA

69



560 SG / MEDINA



DIAMANT

560 SG / LEATHER UPHOLSTERY ZINGST (OPTIONAL FOR AN ADDITIONAL CHARGE)



**THE HIGHEST
LEVEL OF
RELAXATION**

560 SG / MEDINA

560 SG



**RELAXING SLEEP
GUARANTEED**

DIAMANT



560 SG



560 SF

73



560 SG



560 SG



560 SF



560 SF

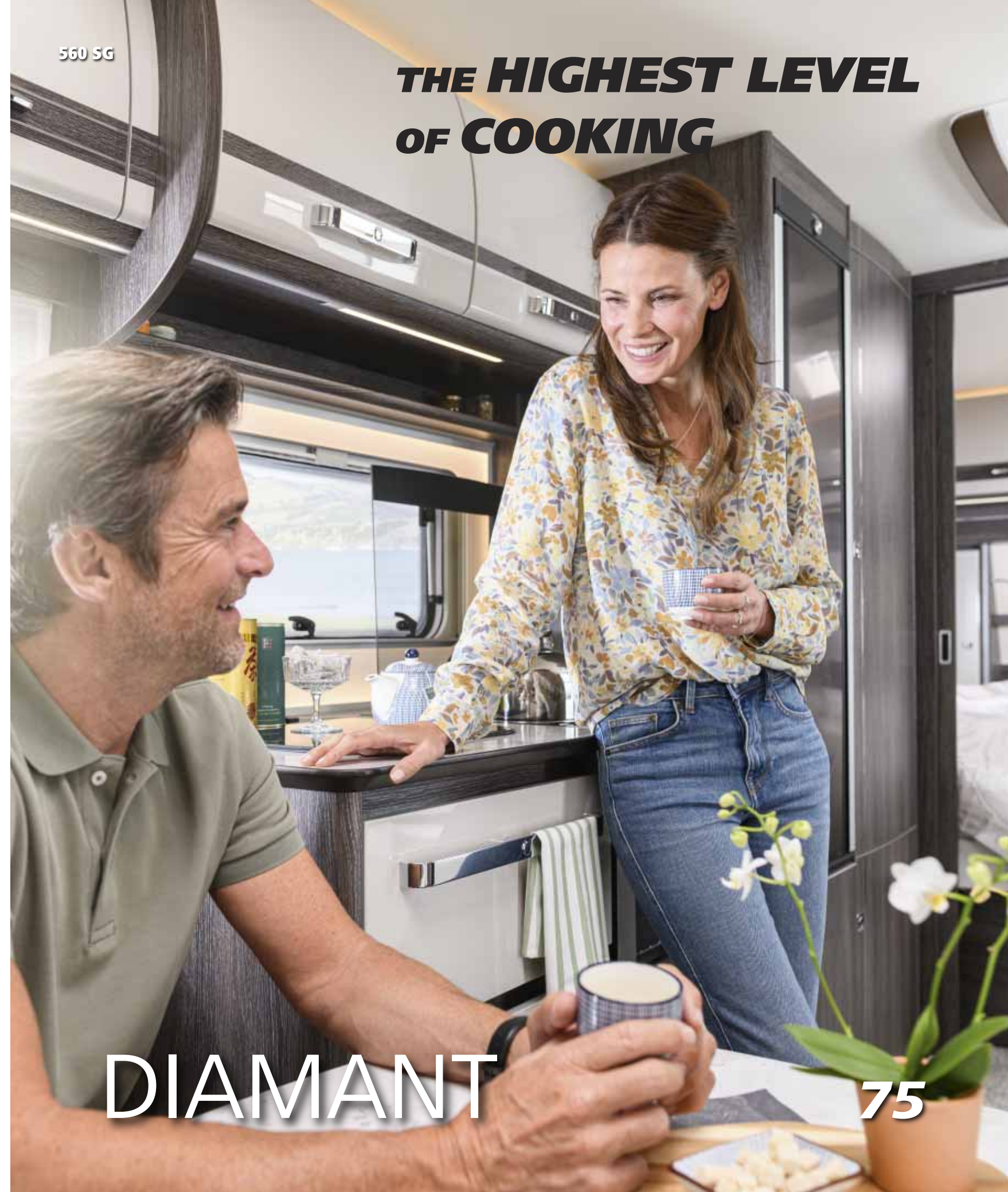

560 SG

**THE HIGHEST LEVEL
OF COOKING**

DIAMANT

75



560 SG



560 SG



560 SG



560 SF

Living room/sleeping area

- Furniture in "Rovero Castello" decor
- Upholstery "Medina" or "Salina" (pages 68-71), as well as leather upholstery "Zingst" (optional extra, page 70)
- Lighting in the wardrobe with motion sensor
- LED lighting
- Decorative package (2 cushions/1 table runner)
- Single-leg lifting table in the round seating area
- Folding sliding door *
- Fly-screen door in the entrance area
- Clothes rack in the sleeping area
- Wooden sliding door *
- Indirect lighting (LED)
- Headrests in the seating area, height adjustable
- Slatted bed base with fully flexible and permanently elastic joint bridges and hardness adjustment (single and French beds)
- Reading spotlights (12 V) in the round seating area
- Reading spotlights (12 V) in the sleeping area
- Lift-O-Mat (single and French beds)
- Mattresses: climate comfort foam (7 zones) (single/French beds)
- MIDI roof hood (Dometic) with crank, forced ventilation, integrated blackout pleated blind and roller fly-screen integrated into the Skylight panoramic roof hood
- Skylight panoramic roof hood with lighting (LED)
- PVC flooring, hard-wearing, easy to care for
- Ergonomically shaped back padding
- High density seat upholstery
- Seat upholstery with spring core in comfort quality
- Soft roller blinds with pleated fabric (blackout roller blind from below)
- Ventilated storage compartments with indirect ceiling lighting (LED)
- Storage compartments with soft-close hinges
- Carpet in the door sill with the Fendt Caravan logo
- Carpeted floor, bound at the edge and loosely laid
- Winter backrests

Kitchen/bathroom

- Waste collector integrated into the entrance door
- Workplace lighting (LED)
- Oven with grill (gas)
- Bathroom lighting (LED/12 V)
- Cutlery inserts with a soft-touch surface
- Shower cubicle **
- Towel/clothes hooks and toilet paper holder
- Stove with safety pilot and automatic ignition (3-burner)
- Comfort pleated roller blind on the kitchen window
- Kitchens with large drawers *
- Backlit kitchen rear wall panelling in a glass look
- Slim tower refrigerator (133 L), can be opened from both sides, with removable freezer compartment and interior lighting
- Central washrooms * with large wall units, generous shelves under the sink and an illuminated mirror
- Mirror cabinet in the open bathroom *
- Stainless steel sink with glass cover
- Flush toilet with diode level indicator and holding tank (rollable)
- Kitchen and bathroom storage compartments with soft-close hinges
- Mineral composite washbasin with shelves, bathroom cabinet and illuminated mirror
- Washroom window, hinged, made of frosted glass with blackout and fly-screen roller blind

Water

- Mobile waste water tank (24 L)
- Fresh water (fixed tank 10^d/45^e litres) with external filling
- Fresh water level indicator

Multimedia

- TV bracket with articulated arm
- TV cabling (230 V socket)

Technology/heating/air conditioning

- Electric floor temperature control (in the temperature-controlled area)
- Truma Combi 6 gas heater with CP plus iNET ready digital control panel with circulating air distribution and integrated hot water boiler (10 l capacity)
- iNet Box for the additional option of heating control via the Truma app (depending on the country)
- Smoke detector
- Switch on the entrance door for the ceiling light and awning light
- Switching power supply 350 W
- Fuse box (230 V) with residual current device (safety switch)
- Spot light(s) (LED/12 V)
- 230 V sockets
- TFT touch panel (central) in a glass look (CI-BUS on-board management)

* Certain models only ** for 650 SGD
For an explanation of the symbols, see page 91

Special features of the DIAMANT

- Headroom 198 cm
- Oven with grill (gas)
- Backlit kitchen rear wall panelling in a glass look
- SKY TV bracket with articulated arm
- Headrests in the seating area, height adjustable
- Kitchen and bathroom storage compartments with soft-close hinges
- Climate controlled comfort foam mattresses (7 zones) (single and French beds)
- Skylight panoramic roof hood with lighting (LED)
- Electric floor temperature control (in the temperature-controlled area)
- Truma Combi 6 gas heater with CP plus iNET ready digital control panel with circulating air distribution and integrated hot water boiler (10 l capacity)
- iNet Box for the additional option of heating control via the Truma app (depending on the country)
- TFT touch panel (central) in a glass look (CI-BUS on-board management)
- Rovero Castello furniture decor, fabric "Medina" or "Salina" (pages 68-71), as well as leather upholstery "Zingst" (optional extra, page 70)

DIAMANT

QUALITY IN SERIES



DIAMANT

LAYOUTS AND DIMENSIONS



560 SF		
Total length	cm	771
Total width	cm	250
Sleeping spaces		4
Technically permitted total mass	kg	1900 / 2000 ^{h) g)}
Mass in running order	kg ^{c)}	1615



560 SG		
Total length	cm	771
Total width	cm	250
Sleeping spaces		4
Technically permitted total mass	kg	1900 / 2000 ^{h) g)}
Mass in running order	kg ^{c)}	1616



New layout		
650 SGD		
Total length	cm	860
Total width	cm	250
Sleeping spaces		4
Technically permitted total mass	kg	2200 ^{g)}
Mass in running order	kg ^{c)}	1884

Scan the QR code and watch a film about the Diamant



Dimensions and weights of all model ranges and models from page 88
Explanation of the symbols on page 91



QUALITY WITH CONVICTION

FENDT
CARAVAN

Quality: our trademark

Quality begins right from the start with the design, and the selection of materials and suppliers. In our company, after deciding on and testing the selected materials, we start with various internal and external test series of the respective products.

Each employee contributes to ensuring our quality standards through his or her own personal performance. That is why our employees continuously receive training and further training. It is only by working in this way that we have been able to convince customers of our products for what is now 50 years.

DIAMANT



SAPHIR / BIANCO / TENDENZA / OPAL



SAPHIR / BIANCO / TENDENZA / OPAL



SAPHIR / BIANCO / TENDENZA / OPAL



Front part partly with LFI technology

Optimal insulation, improved hail protection, 100% UV-resistant, consumer-friendly repair solution for scratches, low maintenance

Rounded edges and awnings

Optimised awning feeder, all side panels in silver with chrome piping (Saphir, Bianco Selection, Bianco Activ, Tendenza, Opal) or in white with chrome piping (Diamant). The decorative trim end pieces are fastened without visible screws

Double-glazed, tinted hinged windows that can be operated with one hand and combined fly-screen/blackout roller blind

Separate hanging rails and separate awning rails above the windows, awning feeder independent of the window, zinc die-cast rail ends

Insulated service flap/ external storage flap with rain protection lip and locking system

Conveniently located and easily accessible

5-hole aluminium rims

Silver (Opal, Tendenza) or black polished (Diamant)

High-quality brand tyres

Supports optimal handling even at full load

AAA brakes

Self-adjusting, with excellent braking effect

Optimised drawbar

Base of the bottle crate is completely self-supporting, which increases the free drawbar length; dynamic load of drawbar vibrations is not introduced into the body via the bottle crate

AKS anti-roll clutch

Compensates for emerging rolling and pitching motions right from the outset

Hard rubber high-quality support wheel

Easy control of the drawbar load due to the load indicator

**White AKS cover hood
White drawbar cover**



MiDi-HEKI operated by crank

Easy handling

Skylight panoramic roof hood with LED lighting (Diamant)

MIDI-HEKI integrated in the panoramic roof hood



Entrance door with integrated and insulated access (lowered)

With tinted and arched windows, as well as fitted, pleated blackout blind, security lock, waste collector and storage (certain models only), single-key system for all locks (robust metal lock), ample space for entry and exit (both in width and in height), reinforced door frame in the entrance area, entrance carpet

UNMISTAKABLE ON THE ROAD AND AT THE CAMPSITE: FENDT-CARAVAN

Stable-form corner steadies

The practical solution for a secure positioning without vibrations

Extended crank supports at the rear

Easier to use



Waste water tank in the gas box

Easy to use and neatly arranged

Aluminium chequer plate floor in the gas box

Sturdy and durable

Bottle case lid with parallelogram guide and gas pressure spring

Opens up fully, robust gas cylinder box lock



QUALITY IN SERIES

Chassis

·"White" overrun device cover	●	●	●	●	●
·Silver alloy wheels			●	●	
·Black polished alloy wheels					●
·Brake AAA, self-adjusting (AL-KO)	●	●	●	●	●
·"White" drawbar cover	●	●	●	●	●
·Euro axle system (AL-KO)	●	●	●	●	●
·Low-profile tyres	●	●	●	●	●
·Automatic reversing	●	●	●	●	●
·Safety coupling AKS 3004 (AL-KO)	●	●	●	●	●
·Galvanised stable-form corner steadies	●	●	●	●	
·Galvanised stable-form corner steadies with "Big-Foot" (AL-KO)					●
·Shock absorber	●	●	●	●	●
·Jockey wheel with load indicator	●	●	●	●	●
·System lightweight chassis, fully galvanised (AL-KO)	●	●	●	●	●
·Extended crank supports	●	●	●	●	●
·Approval for 100 km/h	●	●	●	●	●
Exterior body					
·Exterior storage flap	●	●	●	●	●
·Double-glazed, tinted hinged windows that can be operated with one hand and combined fly-screen/blackout roller blind	●	●	●	●	●
·Additional brake light	●	●	●	●	●
·Entrance door with integrated and insulated access, waste collector and storage, tinted window and pleated blackout blind in the upper entrance door area	●	● *	●	●	●
·Bottle crate lid with gas-pressure damper, three-point locking	●	●	●	●	●
·Fly-screen door in the entrance area			●	●	●
·Front part partly with LFI technology	●	●	●	●	●
·Rear part partly with LFI technology					●
·Awning rail with lighting on the door side					●
·Rear fog lamp(s)	●	●	●	●	●
·"Skylight" panoramic roof hood with lighting (LED)					●
·Wheel housings, fully insulated	●	●	●	●	●
·Manoeuvring handles, ergonomic and stable, at the front and rear	●	●	●	●	●
·Reversing lights (2 pieces)	●	●	●	●	●
·Sandwich construction	●	●	●	●	●
·Awning light (LED), new design	●	●	●	●	●
·Water tank filler cap with retaining strap	●	●	●	●	●
·Central locking system	●	●	●	●	●
·Forced ventilation according to EN standard 1645-1	●	●	●	●	●

- comes as standard

* certain models only



12-year warranty
On the imperviousness
of the body connections

This warranty is only valid in connection with the annual, fee-based inspection carried out at your authorised Fendt Caravan dealer



ALL MODEL RANGES

SERIES EXTERIOR

85



Layouts with children's bed or bunk bed (Photographs 1 + 2)



Saphir 495 SKM



Opal 515 SKF



Bianco 515 SKM Selection



Bianco 550 KMG Activ



Bianco 550 SKM Selection



Saphir 560 SKM



Bianco 560 SKM Activ



Bianco 720 SKDW Activ

Layouts with French bed (Photograph 3)



Bianco 390 FHS Activ



Bianco 445 SFB Activ



Saphir 465 SFB



Bianco 465 SFB Selection



Tendenza 465 SFB



Bianco 465 SFH Activ



Saphir 495 SFB



Bianco 515 SD Activ



Bianco 550 SD Activ



Diamant 560 SF



Opal 560 SRF



Tendenza 650 SFD



Tendenza 650 SFDW

Layouts with single beds (Photograph 4)



Bianco 465 SGE Activ



Saphir 465 TG

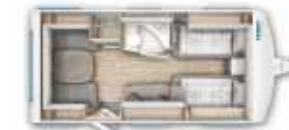

Bianco 465 TG Selection



Saphir 515 SG



Bianco 515 SG Selection



Tendenza 515 SG



Opal 515 SG



Bianco 515 SGE Activ



Opal 550 SG



Opal 560 SG



Diamant 560 SG



Diamant 650 SGD

OVERVIEW OF THE BEDS

- (1) Bunk bed lengthwise or crosswise (Saphir, Bianco Selection, Bianco Activ, Opal; all certain models only)
- (2) Bunk bed lengthwise or crosswise (Saphir, Bianco Selection, Bianco Activ, Opal; all certain models only)
- (3) French bed (Saphir, Bianco Selection, Bianco Activ, Tendenza, Opal, Diamant; all certain models only)
- (4) Single beds (Saphir, Bianco Selection, Bianco Activ, Tendenza, Opal, Diamant; all certain models only)

For an explanation of the symbols,
see page 91

SAPHIR

		465 SFB	465 TG	495 SFB	495 SKM	515 SG	560 SKM
Total length	cm	705	705	724	724	753	774
Body length	cm	594	594	612	612	642	662
Usable length	cm	500	507	520	527	556	569
Total width	cm	232	232	232	232	232	250
max. Height	cm	263	263	263	263	263	263
Headroom	cm	195	195	195	195	195	195
Sleeping spaces		4	4	4	5	4	5
Bed surface at front	cm	140 x 200	2 x 85 x 200	140 x 200	140 x 200	1x85x190/1x85x200	140 x 200
Bed surface at rear	cm	138/142 x 210	127/116 x 210	158/133 x 210	80 x 210	142/135 x 210	80 x 190
Bed surface in middle	cm	-	-	-	100 x 179	-	112/118 x 200
Bunk bed surface	cm	-	-	-	75 x 216	-	80 x 190
Technically permitted total mass	kg	1500 ^{a)}	1500 ^{a)}	1600 / 1700 ^{b) a)}	1600 / 1700 ^{b) a)}	1600 / 1700 ^{b) a)}	1700 ^{a)}
Dead weight	kg ^{b)}	1241	1243	1285	1319	1376	1454
Basic equipment	kg ^{a)}	48	48	48	48	48	40
Mass in running the road	kg ^{c)}	1289	1291	1333	1367	1424	1494
Vehicle load capacity	kg ca.	211	209	267 / 367 ^{b)}	233 / 333 ^{b)}	176 / 276 ^{b)}	206
Floor/roof/wall thickness	mm	47 / 39 / 31	47 / 39 / 31	47 / 39 / 31	47 / 39 / 31	47 / 39 / 31	47 / 39 / 31
Tyres	ⁱ⁾	205/65 R 15	205/65 R 15	195/70 R 15 C	195/70 R 15 C	195/70 R 15 C	195/70 R 15 C
Single/tandem axle		1	1	1	1	1	1
Awning circumference	cm ^{v)}	960	960	976 ^{p)}	976 ^{p)}	1002 ^{n) r)}	1026 ^{o) s)}

BIANCO ACTIV

		390 FHS Activ	445 SFB Activ	465 SFH Activ	465 SGE Activ	515 SD Activ	515 SGE Activ
Total length	cm	605	679	705	705	753	753
Body length	cm	493	567	594	594	642	642
Usable length	cm	407	481	507	507	556	549
Total width	cm	232	232	232	232	232	232
max. Height	cm	263	263	263	263	263	263
Headroom	cm	195	195	195	195	195	195
Sleeping spaces		3	4	3	2	3	4
Bed surface at front	cm	140 x 210	140 x 210	131/118 x 210	2 x 85 x 200	142/102 x 210	142/121 x 210
Bed surface at rear	cm	106/87 x 186	139/133 x 210	140 x 200	-	140 x 200	2 x 85 x 200
Bed surface in middle	cm	-	-	-	-	-	-
Bunk bed surface	cm	-	-	-	-	-	-
Technically permitted total mass	kg	1500 ^{a)}	1500 ^{a)}	1600 / 1700 ^{b) a)}	1600 / 1700 ^{b) a)}	1700 ^{a)}	1700 ^{a)}
Dead weight	kg ^{b)}	1120	1224	1283	1303	1347	1356
Basic equipment	kg ^{a)}	53	53	53	53	45	53
Mass in running the road	kg ^{c)}	1173	1277	1336	1356	1392	1409
Vehicle load capacity	kg ca.	327	223	264 / 364 ^{b)}	244 / 344 ^{b)}	308	291
Floor/roof/wall thickness	mm	47 / 39 / 31	47 / 39 / 31	47 / 39 / 31	47 / 39 / 31	47 / 39 / 31	47 / 39 / 31
Tyres	ⁱ⁾	205/65 R 15	205/65 R 15	195/75 R 15 C	195/70 R 15 C	195/70 R 15 C	195/70 R 15 C
Single/tandem axle		1	1	1	1	1	1
Awning circumference	cm ^{v)}	864	934	960	960	1002 ^{n) r)}	1002 ^{n) r)}

DIMENSIONS AND WEIGHTS

BIANCO SELECTION

		465 SFB Selection	465 TG Selection	515 SG Selection	515 SKM Selection	550 SKM Selection
Total length	cm	705	705	753	753	774
Body length	cm	594	594	642	642	662
Usable length	cm	500	507	556	556	569
Total width	cm	232	232	232	232	232
max. Height	cm	263	263	263	263	263
Headroom	cm	195	195	195	195	195
Sleeping spaces		4	4	4	5	5
Bed surface at front	cm	140 x 200	2 x 85 x 200	1x85x190/1x85x200	145 x 210	140 x 200
Bed surface at rear	cm	138/142 x 210	127/116 x 210	142/135 x 210	80 x 210	80 x 210
Bed surface in middle	cm	-	-	-	97 x 195	102 x 179
Bunk bed surface	cm	-	-	-	75 x 216	75 x 216
Technically permitted total mass	kg	1500 ^{a)}	1500 ^{a)}	1600 / 1700 ^{b) a)}	1600 / 1700 ^{b) a)}	1600 / 1700 ^{b) a)}
Dead weight	kg ^{b)}	1229	1237	1351	1360	1360
Basic equipment	kg ^{a)}	48	48	48	48	48
Mass in running the road	kg ^{c)}	1277	1285	1399	1408	1408
Vehicle load capacity	kg ca.	223	215	201 / 301 ^{b)}	192 / 292 ^{b)}	192 / 292 ^{b)}
Floor/roof/wall thickness	mm	47 / 39 / 31	47 / 39 / 31	47 / 39 / 31	47 / 39 / 31	47 / 39 / 31
Tyres	ⁱ⁾	205/65 R 15	205/65 R 15	195/70 R 15 C	195/70 R 15 C	195/70 R 15 C
Single/tandem axle		1	1	1	1	1
Awning circumference	cm ^{v)}	960	960	1002 ^{n) r)}	1002 ^{n) r)}	1030

BIANCO ACTIV

		550 KMG Activ	550 SD Activ	560 SKM Activ	720 SKDW Activ
Total length	cm	774	774	774	925
Body length	cm	662	662	662	820
Usable length	cm	576	576	569	727
Total width	cm	232	232	250	250
max. Height	cm	263	263	263	262
Headroom	cm	195	195	195	195
Sleeping spaces		5	4	5	6
Bed surface at front	cm	1x85x190/1x85x200	142/121 x 210	140 x 200	153/151 x 210
Bed surface at rear	cm	80 x 210	140 x 200	80 x 190	80 x 230
Bed surface in middle	cm	97 x 179	-	112/118 x 200	150 x 205
Bunk bed surface	cm	75 x 216	-	80 x 190	75 x 216
Technically permitted total mass	kg	1700 ^{a)}	1700 ^{a)}	1700 ^{a)}	2200 ^{a)}
Dead weight	kg ^{b)}	1409	1366	1454	1880
Basic equipment	kg ^{a)}	53	45	45	43
Mass in running the road	kg ^{c)}	1462	1411	1499	1923
Vehicle load capacity	kg ca.	238	289	201	277
Floor/roof/wall thickness	mm	47 / 39 / 31	47 / 39 / 31	47 / 39 / 31	47 / 47 / 31
Tyres	ⁱ⁾	195/70 R 15 C	195/70 R 15 C	195/70 R 15 C	195/65 R 15
Single/tandem axle		1	1	1	2
Awning circumference	cm ^{v)}	1030	1030	1026 ^{o) s)}	1193 ^{t)}

TENDENZA

		465 SFB	515 SG	650 SFD	650 SFDW
Total length	cm	705	753	864	864
Body length	cm	594	642	752	752
Usable length	cm	500	556	659	659
Total width	cm	232	232	250	250
max. Height	cm	263	263	262	262
Headroom	cm	195	195	195	195
Sleeping spaces		4	4	4	4
Bed surface at front	cm	140 x 200	1x85x190/1x85x200	163/151 x 230	163/151 x 230
Bed surface at rear	cm	138/142 x 210	142/135 x 210	-	-
Bed surface in middle	cm	-	-	190 x 150	190 x 150
Bunk bed surface	cm	-	-	-	-
Technically permitted total mass	kg	1500 ^{a)}	1700 ^{a)}	2000 ^{a)}	2200 ^{a)}
Dead weight	kg ^{b)}	1266	1380	1688	1732
Basic equipment	kg ^{a)}	53	53	45	43
Mass in running the road	kg ^{c)}	1319	1433	1733	1775
Vehicle load capacity	kg ca.	181	267	267	425
Floor/roof/wall thickness	mm	47 / 39 / 31	47 / 39 / 31	47 / 47 / 31	47 / 47 / 31
Tyres	ⁱ⁾	205/65 R 15	195/70 R 15 C	185/65 R 14	195/65 R 15
Single/tandem axle		1	1	2	2
Awning circumference	cm ^{v)}	960	1002 ⁿ⁾ ^{r)}	1115 ^{u)}	1122

DIAMANT

		560 SF	560 SG	650 SGD
Total length	cm	771	771	860
Body length	cm	656	656	746
Usable length	cm	563	563	654
Total width	cm	250	250	250
max. Height	cm	266	266	265
Headroom	cm	198	198	198
Sleeping spaces		4	4	4
Bed surface at front	cm	173/147 x 230	2 x 90 x 200	187/147 x 230
Bed surface at rear	cm	160 x 200	144/142 x 230	2 x 90 x 205
Bed surface in middle	cm	-	-	-
Bunk bed surface	cm	-	-	-
Technically permitted total mass	kg	1900 / 2000 ^{h)} ^{g)}	1900 / 2000 ^{h)} ^{g)}	2200 ^{g)}
Dead weight	kg ^{b)}	1562	1563	1831
Basic equipment	kg ^{a)}	53	53	53
Mass in running the road	kg ^{c)}	1615	1616	1884
Vehicle load capacity	kg ca.	285 / 385 ^{h)}	284 / 384 ^{h)}	316
Floor/roof/wall thickness	mm	47 / 39 / 31	47 / 39 / 31	47 / 39 / 31
Tyres	ⁱ⁾	215/70 R 15 C	215/70 R 15 C	195/65 R 15
Single/tandem axle		1	1	2
Awning circumference	cm ^{v)}	1016	1016	1116



+++ **12-year warranty on the imperviousness of the body connections: this warranty is only valid in connection with the annual, fee-based inspection carried out at your authorised Fendt Caravan dealer** +++
Certified to ISO 9001:2015 +++ Environmental management certification according to ISO 14001:2015 + ++ Metallic paintwork +++ 47 mm floor thickness for optimal insulation values +++ Rain and awning rails on the windows +++ Drain cocks for convenient emptying of the water pipes +++ Solid, screwed connections +++ Two-part sidewall panel +++ Sturdy furniture made of multi-glued plywood +++ Extra robust hinges, positioners and locks +++ 2-pole residual current device/safety switch with 30mA

DIMENSIONS AND WEIGHTS

OPAL

		515 SG	515 SKF	550 SG	560 SG	560 SRF
Total length	cm	753	753	774	774	774
Body length	cm	642	642	662	662	662
Usable length	cm	556	556	576	576	569
Total width	cm	232	232	232	250	250
max. Height	cm	263	263	263	263	263
Headroom	cm	195	195	195	195	195
Sleeping spaces		4	5	4	4	4
Bed surface at front	cm	1x85x190/1x85x200	140 x 210	1x85x210/1x85x200	1x90x210/1x90x200	150 x 200
Bed surface at rear	cm	142/135 x 210	80 x 210	142/153 x 210	142/153 x 230	213/162 x 230
Bed surface in middle	cm	-	97 x 210	-	-	-
Bunk bed surface	cm	-	75 x 216	-	-	-
Technically permitted total mass	kg	1700 ^{g)}	1700 ^{g)}	1700 ^{g)}	1700 / 1800 ^{h)} ^{g)}	1700 / 1800 ^{h)} ^{g)}
Dead weight	kg ^{b)}	1371	1409	1402	1485	1469
Basic equipment	kg ^{a)}	53	53	53	53	53
Mass in running the road	kg ^{c)}	1424	1462	1455	1538	1522
Vehicle load capacity	kg ca.	276	238	245	162 / 262 ^{h)}	178 / 278 ^{h)}
Floor/roof/wall thickness	mm	47 / 39 / 31	47 / 39 / 31	47 / 39 / 31	47 / 39 / 31	47 / 39 / 31
Tyres	ⁱ⁾	195/70 R 15 C	195/70 R 15 C	195/70 R 15 C	205/70 R 15 C	205/70 R 15 C
Single/tandem axle		1	1	1	1	1
Awning circumference	cm ^{v)}	1002 ⁿ⁾ ^{r)}	1002 ⁿ⁾ ^{r)}	1030	1021 ^{s)}	1021 ^{s)}

Legend:

- a) 100% filled aluminium gas cylinder (11 kg), fresh water tank with 10-litre "when-driving" fill level, 100% filled toilet flushing tank, 100% filled water heater
- b) The dead weight reflects the vehicle weight with standard fittings without water, gas or other accessories
- c) The mass in running order was determined according to Regulation (EU) No 1230/2012, taking into account the "when-driving" fill level of the fresh water tank, the 100% filled toilet flushing tank, the 100% filled water heater, and a 100% filled aluminium gas cylinder (11 kg)
- d) Fresh water tank capacity within the meaning of Annex V, part A, no.2.6 fn (h) of Regulation (EU) 1230/2012, taking into account the movement limitation (discharge nozzle on the fresh water tank) 10 l ("when driving" fill level)
- e) Capacity of the fresh water tank max. 25 litres or 45 litres, taking into account the discharge nozzle on the fresh water tank
- g) Additional weight variants are possible by installing a new chassis – your Fendt Caravan dealer will be happy to provide you with information
- h) Increased load capacity
- i) Alternative tyre sizes are permitted to the manufacturer
- n) For weight variant 1800 kg: awning circumference 1011 cm
- o) For weight variant 1800 kg: awning circumference 1021cm
- p) For weight variant 1900/2000 kg: awning circumference 987 cm
- r) For weight variant 1900/2000 kg: awning circumference 1013 cm
- s) For weight variant 1900/2000 kg: awning circumference 1032 cm
- t) For weight variant 2400/2500 kg: awning circumference 1183 cm
- u) For weight variant 2200/2400/2500 kg: awning circumference 1122 cm
- v) The specification of this circumference may not be sufficient to select the appropriate awning, under certain circumstances. The specified circumference only applies to awnings that are fully drawn into the existing keder strip of the caravan. The circumference may vary due to special equipment, tire size and load. We recommend measuring the caravan individually in each case in order to determine an exact circumference appropriate for the type of awning

Important information:

The catalogue and the price list reflect the status of the series at the time of printing. Despite the contents having been checked, printing errors cannot be ruled out. Over the course of the model year, we reserve the right to make changes to the equipment and fittings and product improvements. Differences in colour due to printing and photography cannot be completely ruled out. The models depicted in the catalogue and in the price list sometimes contain special fittings or decorations that are not part of the standard scope of delivery. Where weights are specified, deviations of up to +/- 5 percent are possible due to the processing of natural materials. When accessories are installed, the mass in running order is increased. Attachments to the vehicle may influence the drawbar load. All dimensions are non-binding and may be subject to minor changes. Information on masses and weights is given in accordance with Regulation (EU) 1230/2012, unless otherwise specified in the catalogue, including technical specifications and price list. Caution: Axle and drawbar loads must be observed, and the technically permissible overall mass be adhered to. Adherence to the permissible masses and loads is to be ensured by distributing the load throughout the vehicle. Fittings and equipment may influence the payload or vehicle load capacity by increasing/decreasing the dead weight. It should be noted that this can reduce the vehicle load capacity, depending on the fittings and equipment. The vehicle load capacity corresponds to the difference between the technically permissible total mass and the mass in running order. This value must take into account the masses for special accessories and personal equipment. The technically permissible total mass in the loaded state must never be exceeded. Please ask your Fendt Caravan dealer if necessary. We reserve the right to make changes to prices, constructional details and fittings.

FENDT

CARAVAN

Fendt-Caravan GmbH • Postfach 1135 • D-86689 Mertingen
Tel. +49 (0) 90 78 / 96 88 - 0 • Fax +49 (0) 90 78 / 96 88 - 406

concept & design: www.sewald.com - foto: www.zuckerfabrik.com



www.fendt-caravan.com (facebook, instagram, youtube)

2022