



**Auto-Sleepers**  
MOTORHOMES OF EXCELLENCE

Combining over 50 years of British motorhome craftsmanship from the Cotswolds and technologically advanced vehicles



# Award-Winning Manufacturer

Auto-Sleepers have been building motorhomes of exceptional quality for over fifty years. Our motorhomes are hand built by experienced craftsmen combining practicality with internal and external design innovations. Never before have these qualities been better combined than in the latest Auto-Sleepers range. For those who aspire – arrive in style with an Auto-Sleeper.



## Power with economy

Auto-Sleepers' long standing relationship with Peugeot dates back to the 1980's when both the Talbot Express chassis and panel vans were the base vehicles of choice. Today, the Peugeot Boxer features driver and passenger airbags as standard for ultimate peace of mind. The Peugeot Boxer is characterised by its practicality, spaciousness, drivability and comfort and is packed with innovative features to make your touring more enjoyable.

The Volkswagen name is synonymous with campervans and has built up a loyal following over the years, from the early split screen models to the modern and much loved T5 version, the Transporter has evolved. The latest and most sophisticated T5 comes with a host of new features.

Mercedes-Benz was the first name in motoring over a century ago. Their commitment to high engineering standards and safety mean that outstanding driving characteristics and innovations give you total peace of mind, allowing you to enjoy your leisure time to the full. Auto-Sleepers' craftsmanship and Mercedes-Benz engineering - an unbeatable combination.

The class leading Auto-Sleepers Motorhome range have a high specification befitting their flagship status and are built on the latest Euro V compliant range of Diesel engines, combining power with performance yet being environmentally friendly with low emissions.

## Safety first and foremost

Being safe in your vehicle is paramount. All Auto-Sleepers models have obtained EC Whole Vehicle Type Approval. That is why the forward facing seating in Auto-Sleepers' conversions is tested to European seat belt anchorage standards. All models comply with British and European safety standards as independently verified by the National Caravan Council (NCC) and VCA.

## Contents

3	Mercedes Vito Conversion
9	Volkswagen Van Conversion
15	Peugeot Van Conversions
31	Peugeot Coachbuilds
47	Mercedes Coachbuilds
63	Coachbuilt Personalisation
65	Grade 3 Insulation
66	Owner's Club
67	Warranty
68	Service
69	Weights & Dimensions



Manufactured in England



# Mercedes Vito Conversion



Model

2

Min Berth



Max. Berth



\* Wave model available as a 4 berth with optional roofbed

The all-new Vito Wave from Auto-Sleepers delivers the ultimate combination of compact versatility whether around town, on the school run, at leisure on sporting pursuits or those all-important breaks exploring at large. The 136bhp engine with the optional Mercedes 5 speed fully automatic gearbox and a host of electronic driving aids delivers executive car performance and so much more besides...

*"Compact & Versatile, the Wave is ready for everything"*

# Ready when you are...

**NEW**  
FOR 2015

**AS**  
Auto-Sleepers  
MOTORHOMES OF EXCELLENCE



- |  |   |   |   |
|--|---|---|---|
| <p>A. Cab air conditioning*, cruise control*, Bluetooth® telephone control*, smart phone input for audio and cab swivel seats</p> <p>B. Exclusive "Regency" upholstery with complementary curtains and tie backs</p> <p>C. Optional roofbed with Wave model</p> <p>D. 2 burner hob with separate grill</p> | <p>E. Webasto heater providing on site and on route heating*</p> <p>F. Optional Porta-Potti cassette toilet#</p> <p>G. Externally accessible 230v mains socket</p> <p>H. LPG gas tank (onboard)</p> <p>I. 2 swivel arm tables with bespoke storage</p> <p>J. External shower point accessible through rear door</p> | <p>K. Optional drive away awning for rear of motorhome, provides secure extension of available space for storage and privacy#</p> <p>L. Sink with mixer tap</p> <p>M. Fully portable cooler box in dedicated drawer</p> <p>N. Internal fresh water tank and external waste water tank</p> <p>O. Truma water heater*</p> | <p>P. 2 rear seats c/w 3-point inertia seat belts and lumbar support cushion</p> <p>Q. Choice of 5 body colours plus optional chrome body kit and BBS alloy wheels#</p> <p>R. Manual 136bhp engine as standard or optional 5 speed fully automatic*</p> |
|--|---|---|---|

**\*Premium Pack #Optional**

# Vito Wave - Ready for wherever life takes you next

Stunning on the outside, practical on the inside, versatile in use and on a par with the best executive car; the Wave is built for endurance and comes complete with the proverbial kitchen sink. Always ready, the Vito Wave is not just about being the ultimate in style - two models, the go anywhere Reimo roof Low Line or the enhanced storage High Line complete with opening sunroof; both deliver the ultimate lifestyle utility vehicle with everyday car practicality.



## Vehicle Layout

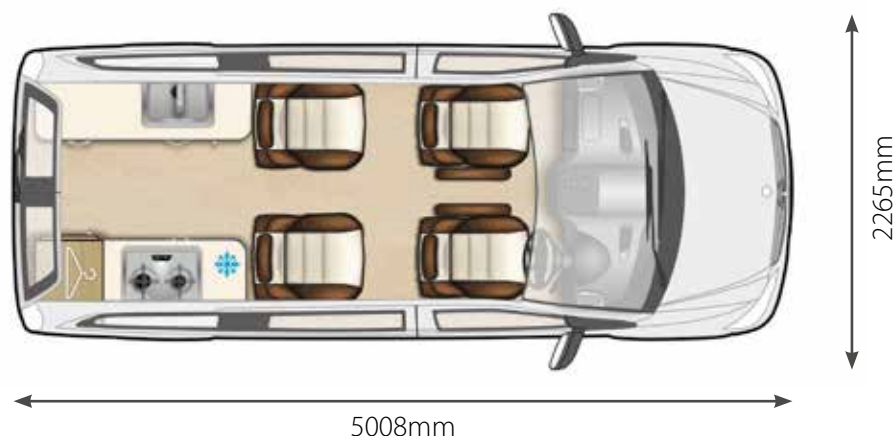

## Sleeping Options

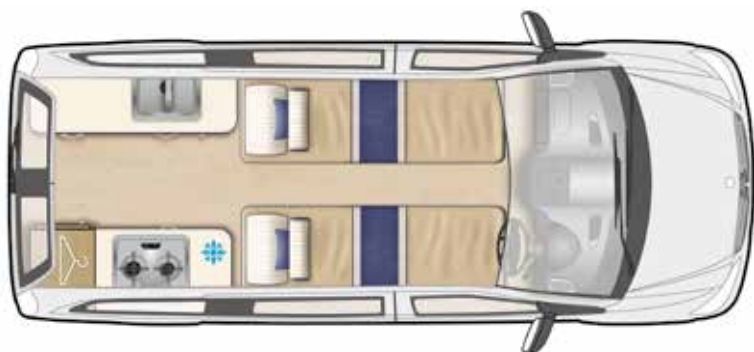

## Key Features

- Based on the Mercedes Vito LWB chassis
- Supplied as standard on the manual 136bhp engine
- Optional 5 speed fully automatic gearbox<sup>#</sup>
- Optional 163bhp engine upgrade<sup>#</sup>
- Cruise control\*
- Cab air conditioning\*
- Bluetooth® telephone control\*
- Smart phone input for audio
- Cab swivel seats
- Choice of 5 colours
- Chrome body kit and BBS alloy wheels<sup>#</sup>
- Exclusive "Regency" upholstery with complementary curtains and tie backs
- 4 travel seats including cab seats
- 2 rear seats featuring Reflex™ foam and lumbar support
- 2 swivel arm tables with bespoke storage
- Optional Porta-Potti cassette toilet<sup>#</sup>
- Truma water heater\*
- Webasto heater providing on site and on route heating\*
- Fully portable cooler box in dedicated drawer
- LPG gas tank (onboard)
- Internal fresh water tank and external waste water tank
- Sink with mixer tap
- 2 burner hob
- Separate grill
- Externally accessible 230v mains socket
- External shower point accessible through rear door
- Optional drive away awning for rear of motorhome, provides secure extension of available space for storage and privacy<sup>#</sup>

<sup>#</sup>Premium Pack <sup>#</sup>Optional

## Specification

- MTPLM - 3000/3050 kg
- MIRO - 2547/2596 kg
- Maximum User Payload - 453/454 kg
- Essential Habitation Equipment - 0 kg
- Vehicle Height- 2000/2535mm (Wave/HL)
- Fresh Water Tank - 32ltrs
- Waste Water Tank- 28ltrs



\*Wave available as a 4 berth with optional roofbed





# Specification

The Wave: delivering market leading specification for the discerning buyer to be the ideal choice for those who demand the very best refinement for their driving pleasure. With safety first and foremost - the new Vito Wave excels on every front epitomising a peerless all in one lifestyle solution

## Choice Of Colours

The Wave is available in a choice of 5 colours.

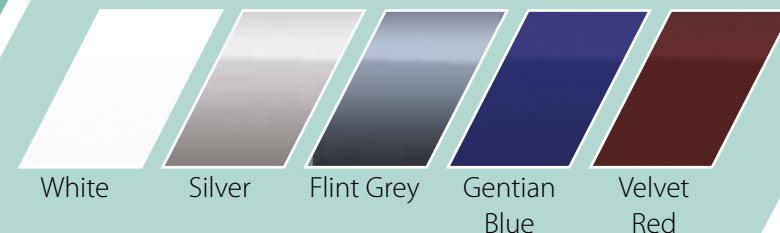

## Feel at home, wherever you are

You'll feel at home straight away in the Wave. Its ergonomically designed interior with a generously proportioned cockpit and comfortable seats provide even more comfort and a pleasant ambience. Top-quality fabrics and materials ensure your well-being on both short and long trips.

- Mercedes advanced audio system with media interface including iPod, USB and Auxiliary inputs
- LINGUATRONIC voice-operated control system in conjunction with COMMAND APS<sup>#</sup>
- Power-assisted steering
- Multi-functional steering wheel
- Speedtronic cruise control with two speed limiter
- Cab air conditioning\*
- Steering wheel adjustable for height and angle
- Multi position cab seats with twin armrests and height adjustable head restraints
- Central locking with radio remote control
- Electric windows
- Cup holder in centre console



Optional 5-speed automatic gearbox\*



Mercedes advanced audio system

## The Safety Equipment

The interaction between numerous active and passive safety systems in the Wave, including many electronic driver assistance systems, ensures a high level of protection.

- Electronic Stability Program ADAPTIVE ESP<sup>®</sup>
- Disc brakes on all wheels
- Three-point seat belts on all seats; with belt tensioners for driver and passenger
- Driver and passenger airbag
- Adaptive brake lights
- Safety body with high-strength load-bearing members
- Safety steering column
- Large safety tail lights

## Premium Pack Upgrades

- Cab air conditioning
- Cruise control
- Bluetooth<sup>®</sup> telephone control\*
- Truma water heater\*
- Webasto heater providing on site and on route heating\*

*\*Premium Pack #Optional*

## Base Vehicle Specification

- Mercedes Vito 113 - 163bhp<sup>#</sup>
- 6 Speed manual gearbox as standard
- 5 Speed fully automatic gearbox<sup>#</sup>
- Multi function steering wheel
- Cab air conditioning<sup>\*</sup>
- Cruise control<sup>\*</sup>
- Bluetooth<sup>®</sup> connectivity<sup>\*</sup>
- Driver & passenger airbags
- Adaptive brake lights
- Alarm
- CD/Radio sound 20
- Luxury cockpit with soft touch finish
- Central storage console
- Up rated 100ah vehicle battery
- Choice of 5 body colours
- Chrome pack including stainless steel running bar and BBS alloy wheels<sup>#</sup>

## Roof Options

### Wave

The Wave is a 2 berth model with a colour coded Reimo pop-top roof for a stunningly automotive appearance, with the option of a Reimo roof bed to sleep those extra passengers.



### Wave HL



The Wave HL is the 2 berth model featuring a colour coded GRP roof & opening skylight in the front, 4 storage lockers running down both sides with 1 across the rear, plus 4 travelling seats.

## Interior General

- Cab air conditioning<sup>\*</sup>
- Bluetooth<sup>®</sup> telephone control<sup>\*</sup>
- Smart phone input for audio
- Cab swivel seats
- Exclusive 'Regency' upholstery with complementary curtains and tiebacks
- 4 travel seats including cab seats
- The 2 rear seats feature 4 different grades of Reflex<sup>™</sup> foam with a removable lumbar support cushion to provide the ultimate in comfort
- 2 swivel arm tables with bespoke storage
- LPG gas tank (onboard)

## Facilities

- Sink with mixer tap
- 2 burner hob
- Separate grill
- Porta-Potti cassette toilet<sup>#</sup>

## Exterior General

- Choice of 5 colours
  - White
  - Pebble Grey (Silver)
  - Flint Grey
  - Gentian Blue
  - Velvet Red
- Chrome pack including stainless steel running bar and BBS alloy wheels
- Externally accessible 230v mains socket

## Electrics and Plumbing

- Truma water heater<sup>\*</sup>
- Webasto heater<sup>\*</sup>
- Internal fresh water tank
- External waste water tank
- Shower point accessible through rear door

*<sup>\*</sup>Premium Pack <sup>#</sup>Optional*

# Volkswagen Van Conversion



Models

1

Min Berth



Max Berth



Auto-Sleepers' passion, functional design, new technology, eye for beauty and a deep practical understanding of the demands of today's modern lifestyle provide a perfect combination of all the elements necessary to create an Auto-Sleepers Motorhome of Excellence.

# Drive and Arrive in Style



- |  |  |  |                                      |  |
|--|--|--|--------------------------------------|--|
| A. Turbo Diesel 2.0 litre 140bhp Euro V engine with optional upgrade to DSG automatic gearbox* | D. GRP roof top with side windows                        | H. En-suite facilities   | K. Reversing sensors                 | P. 16" alloy wheels                        |
| B. Driver and passenger airbags  | E. Opening roof windows with privacy blinds & flyscreens | I. Flush fitting, stylish and practical athermally treated privacy glass | L. Spare wheel and carrier           | Q. ESP & ASR traction control              |
| C. Cab air conditioning and cruise control   | F. Panoramic opening roof light                          | J. Sliding power door with self closing feature                          | M. Designer Belgium chenille fabrics | R. Choice of 6 (5 metallic) paint finishes |
|  | G. Luxury cabinets                                       |  | N. Fully featured kitchen            | S. Colour coded mirror and bumpers         |
|  |  |  | O. ABS brakes with EDS               |  |

*\*Optional*

# Topaz - *Combining Versatility and Practicality*

All neatly packaged together and put to practical use by our designers, this stylish 2 berth Campervan with the all-important third travelling seat the Topaz remains the iconic campervan users preferred choice.



## Vehicle Layout

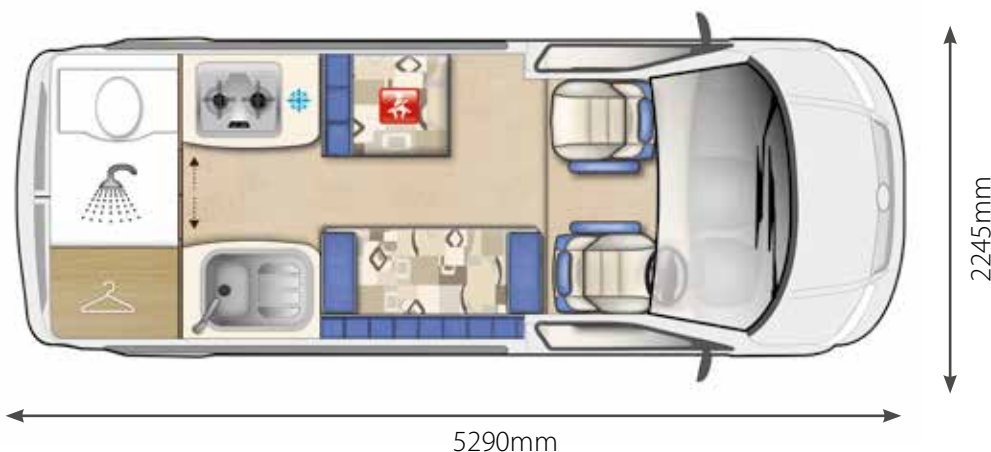

## Sleeping Options

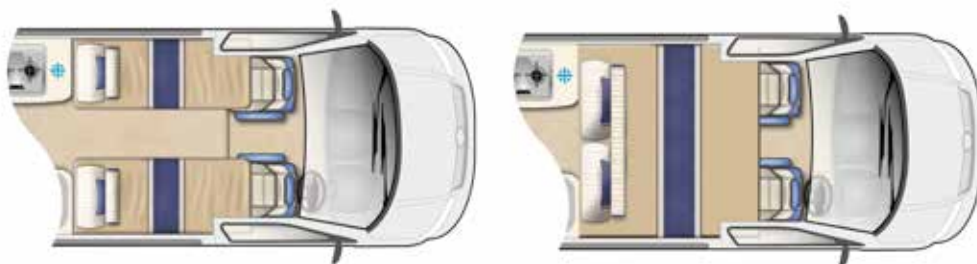

## Key Features

- Rear travel seat, single or double bed, rear washroom
- Optional DSG 7 speed automatic gearbox\*
- Cab air conditioning & cruise control
- 16" alloy wheels plus spare wheel & carrier
- Sliding power door with self-closing feature
- ABS brakes with electronic differential lock
- ASR traction control
- ESP electronic stability program & hill start assist
- 6 (5 metallic) paint colour options inc. front bumper & wing mirrors
- Athermic flush fitting & insulating privacy glass
- 2 burner hob & grill plus a 3 way 60 litre fridge
- Combined shower & toilet compartment with integrated basin
- USB ports
- Reversing sensors
- Swivelling cab seats



Rear travel seats



Manufactured in the UK



## Specification

- Vehicle Height (incl TV aerial) - 2675mm
- MTPLM - 3200kg
- MIRO - 2618kg/2643kg<sup>#</sup>
- Maximum User Payload - 582kg/557kg<sup>#</sup>
- Essential Habitation Equipment - 0kg
- Fresh Water Tank - 68ltrs
- Waste Water Tank - 57ltrs

<sup>#</sup>Optional

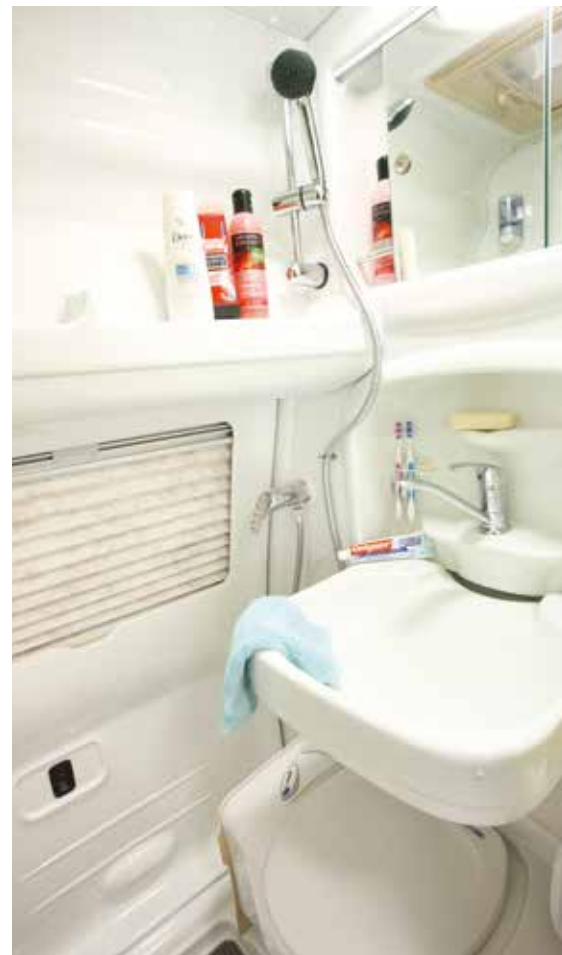

# Specification

The Topaz provides all of the features that you would expect to find on a larger campervan, including a rear bathroom with sink, shower and toilet, all neatly packaged and put to practical use in this stylish 2 berth campervan. The Volkswagen based Topaz is a high top campervan conversion based on the long wheel base T5 chassis. The metallic paintwork, colour-coded bumpers and distinctive graphics provide a striking appearance to this all-in-one lifestyle solution.

## Choice Of Colours

Volkswagen van conversions are available in a choice of 6 colours.

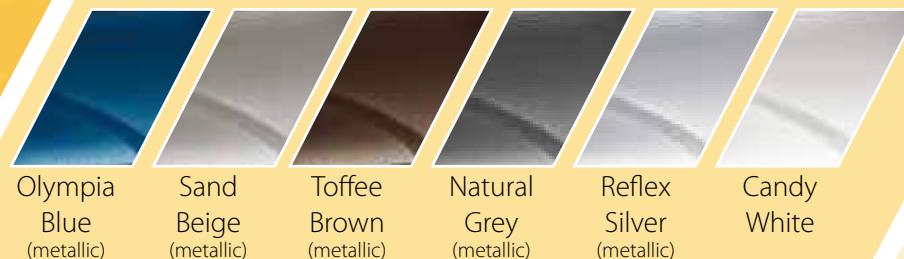

## VW and Auto-Sleeper a perfect combination

The Auto-Sleeper Topaz is built on VW's T5 Long Wheel base chassis offering The Transporter's famous build quality and refined driving experience. The 2015 edition engine include:

- Lower CO<sub>2</sub> emissions & more efficiency offering a return of over 600 miles to a single tank of fuel
- Improved torque providing a greater level of performance
- Euro V, 4 cylinder engines are quieter, cleaner and more fuel-efficient

Auto-Sleepers' relationship with Volkswagen has also been a long standing one, together we have built an award winning reputation for applying British craftsmanship alongside German engineering to produce an industry leading model range, copied by all, bettered by none.



Manufactured in England



## DSG Automatic Gearbox

The optional DSG dual-clutch gearbox has two clutches with electronically controlled gear selection. DSG gives you:

- Fast, smooth gear changes
- Lively handling with unbroken acceleration
- Safer driving with the power to get you out of tricky situations
- Improved fuel economy, even compared to a manual gearbox



# Base Vehicle Specification

- Turbo diesel 2.0 litre 140bhp Euro V engine
- Optional upgrade to DSG automatic gearbox#
- 16" alloy wheels
- Sliding power door with self-closing feature
- Cruise control
- Cab air conditioning
- ABS brakes with EDS electronic differential Lock
- ASR traction control
- ESP electronic stability program
- MSR engine torque regulator
- Hill start assist
- Stereo radio CD player
- Wood effect dash fascia
- Single key central locking for cab and habitation door
- Driver and passenger airbags
- Driver and passenger seat with twin armrests
- Power assisted steering
- Electrically heated and adjustable wing mirrors
- Electric cab windows
- Rear fog light
- Lockable glove box
- 12v socket
- UV filtering tinted glass
- Reversing sensors
- Removable cab carpet



## Interior General

- Luxurious furniture with chrome fixtures and fittings
- Blown air central heating system
- Panoramic opening roof-light
- Privacy blinds & flyscreen's to all opening windows
- Choice of five Belgium chenille fabrics providing luxurious interior soft furnishings
- High quality Reflex™ foam upholstery
- Colour co-ordinated scatter cushions.
- Removable interior carpets including the cab
- Under seat storage with drop down access door on the nearside swivel cab seats
- Over-cab storage compartment
- Spacious wardrobe
- Range of high & low level storage lockers.
- Tables with single leg
- Smoke and carbon monoxide alarms
- Fire extinguisher



## Exterior General

- Choice of 6 (5 metallic) paint colours
- Colour co-ordinated front bumper and wing mirrors to match
- Athermically treated privacy glass with concertina blinds & flyscreens
- Insulated cab window screens for privacy and insulation
- Gas locker for 2 x 4.5Kg gas bottles

## Kitchen

- 2 Burner hob and grill with electronic ignition grill
- 3 Way 60 litre refrigerator with freezer compartment
- Kitchen centre sink incorporating glass top with a recessed draining board
- Cutlery drawer
- Melamine crockery set, cooler bag and crystal wine glasses

## Electrics and Plumbing

- 12v control panel
- Split charged leisure battery
- 230v sockets & 12v sockets
- Electric mains hook up lead
- Blown air central heating system
- Submersible water pump
- 68 Litre fresh water tank
- 57 Litre waste tank
- Large bore waste pipe work for efficient drainage

## Bathroom

- Combined shower and toilet compartment with integrated washbasin
- Vanity cupboard/storage
- Electric flush cassette toilet
- Chrome fixtures and fittings
- Anti-slip shower mat
- 12v lighting
- Roof vent with flyscreen

#Optional

# Peugeot Van Conversions



Models

6

Min Berth



Max Berth



The flagship Auto-Sleeper Peugeot van range is undoubtedly the benchmark for every other panel van to be measured against. In the words of Peugeot, "it is all about Motion and Emotion" for the ultimate holidaying experience and no other manufacturer comes close to matching an Auto-Sleeper for luxury, specification and refinement.

# Peerless and Refined



Our Peugeot Van Conversions feature Grade III Classification for heating and thermal insulation.



## BRAND NEW FOR 2015

Optional Fiat Ducato 130bhp Comfort-matic gearbox available on all Auto-Sleeper 2015 Peugeot models.



- A. Peugeot 150bhp 6 speed manual engine
- B. Fiat Comfort-Matic 130bhp automatic engine\*
- C. Cab air conditioning, cruise control\*, digital DAB radio with touchscreen, Bluetooth® & Passenger air-bag

- D. Flush fitting, stylish and interior insulating athermically treated privacy glass
- E. Contrasting Verada Oak furniture
- F. TV aerial
- G. Longitudinal styling roof bars
- H. LED strip awning light

- I. Thule (Omnistor) awing\*
- J. En-suite washroom facilities
- K. Colour reversing camera\*
- L. External TV socket
- M. External BBQ point
- N. Spare wheel and carrier with a remote tyre pressure valve

- O. AL-KO Air Top suspension\*
- P. External underfloor mounted LPG gas tank
- Q. Fully featured kitchens
- R. Designer 'Moonstone' fabrics
- S. Alloy wheels
- T. LED daytime running lights

- U. Front Fog Lights\*
- V. Colour coded bumpers

**\*Premium Pack #Optional**

# Symbol - Compact Versatility

The iconic Auto-Sleeper Symbol is sleek, compact and offers full versatility of use, coping with aplomb in either daily use or for short and extended getaways alike. The MWB chassis is super-agile yet the Symbol suffers no compromise in user space thanks to its innovative space saving design.



## Vehicle Layout

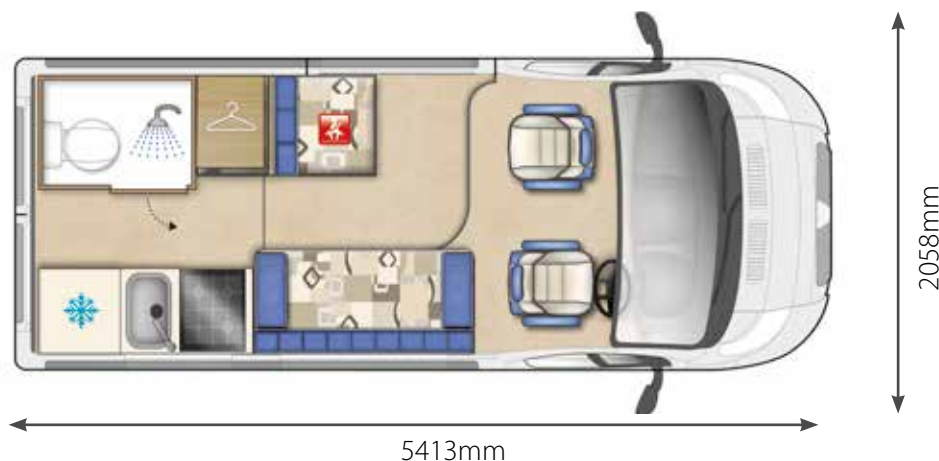

## Sleeping Options



## Key Features

- Smallest Peugeot model available with single beds option
- 20ltr liquid capacity underfloor LPG gas tank
- AL-KO Air-Top & Twin Leaf rear suspension\*
- Thule (Omnistor) canopy awning\*
- Full spectrum reversing camera with permanent feed\*
- Athermic flush fitting & insulating privacy glass
- Alloy wheels\* plus spare wheel & carrier
- 4 Colours including 3 metallic finishes
- Colour-coded front bumper
- LED daytime running lights
- External BBQ socket
- Fully featured kitchens with worktop extensions
- USB ports
- 150bhp Peugeot engine as standard
- Fiat Ducato 130bhp Comfort-Matic engine#



Rear travel seats



## Specification

- Vehicle Height (incl TV aerial) - 2640mm
- MTPLM - 3300kg
- MIRO - 2869kg
- Maximum User Payload - 431kg
- Essential Habitation Equipment - 0kg
- Fresh Water Tank - 69ltrs
- Waste Water Tank - 40ltrs

\* Premium Pack #Optional



# Warwick Duo - *The Couples Choice*

The Warwick Duo has been Auto-Sleepers' top selling 2-berth end lounge panel van. Thanks to the innovative and stylish design features incorporated by Auto-Sleeper, customers can relax in spacious comfort throughout the day and then take advantage of full size single beds or spread out on a luxuriously spacious double bed at night and with our best ever specification makes this the perfect couples Motorhome.



## Vehicle Layout

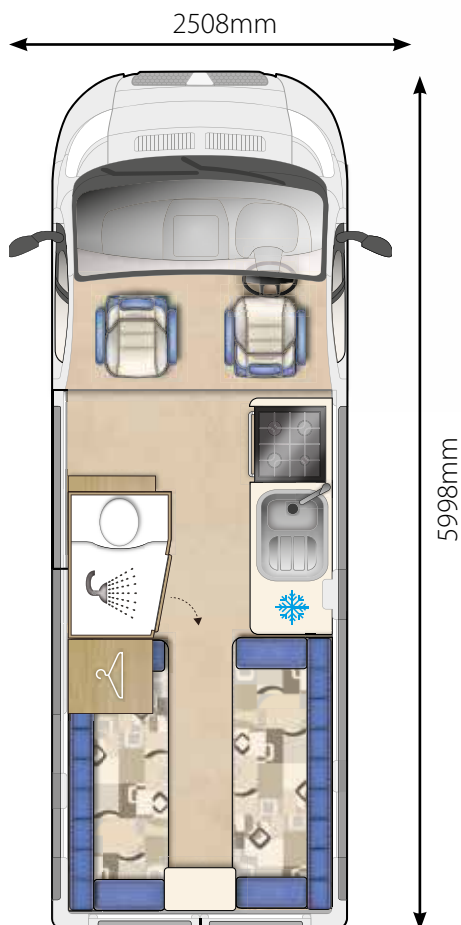

## Sleeping Options

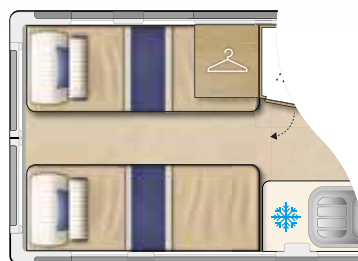

## Key Features

- Spacious lounge with full size single beds or double bed
- 20ltr liquid capacity underfloor LPG gas tank
- AL-KO Air-Top & Twin Leaf rear suspension\*
- Thule (Omnistor) canopy awning\*
- Full spectrum reversing camera with permanent feed\*
- Athermic flush fitting & insulating privacy glass
- Alloy wheels\* plus spare wheel & carrier
- 4 colours including 3 metallic finishes
- Colour-coded front bumper
- LED daytime running lights
- External BBQ socket
- Fully featured kitchens with worktop extensions
- USB ports
- 150bhp Peugeot engine as standard
- Fiat Ducato 130bhp Comfort-Matic engine#



## Specification

- Vehicle Height (incl TV aerial) - 2640mm
- MTPLM - 3500kg
- MIRO - 2938kg
- Maximum User Payload - 562kg
- Essential Habitation Equipment - 0kg
- Fresh Water Tank - 69ltrs
- Waste Water Tank - 40ltrs

\* Premium Pack #Optional



# Windrush - *The Perfect 2+2*

The award winning Windrush model is our family orientated model offering 4 berths with 2 spacious bunks across the rear and comes with 4 belted travelling seats to offer maximum flexibility in use for couples and families alike.



## Vehicle Layout

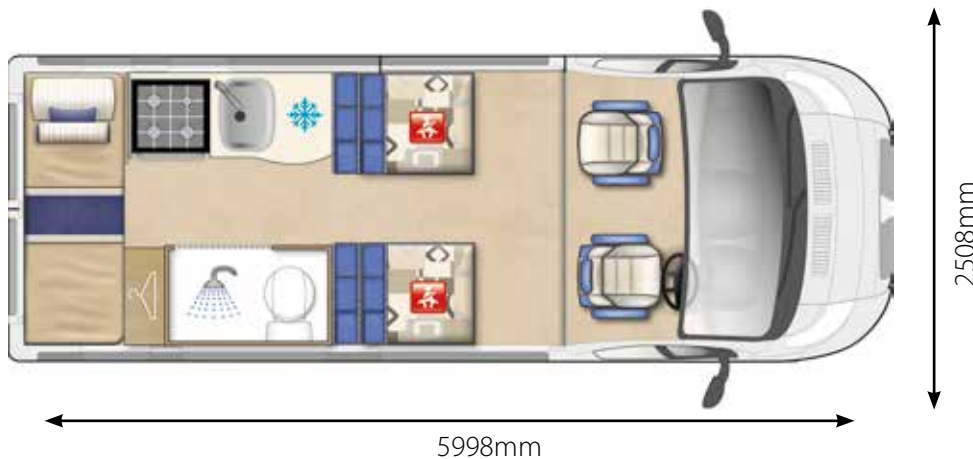

## Sleeping Options

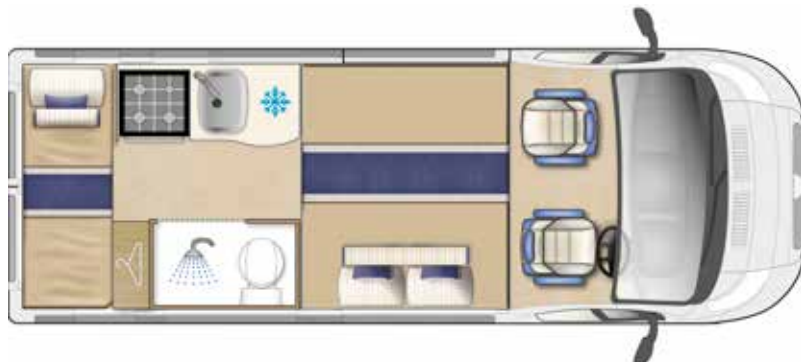

## Key Features

- 2 large single bunks and rear belted travelling seats
- 20ltr liquid capacity underfloor LPG gas tank
- AL-KO Air-Top & Twin Leaf rear suspension\*
- Thule (Omnistor) canopy awning\*
- Full spectrum reversing camera with permanent feed\*
- Athermic flush fitting & insulating privacy glass
- Alloy wheels\* plus spare wheel & carrier
- 4 colours including 3 metallic finishes
- Colour-coded front bumper
- LED daytime running lights
- External BBQ socket
- Fully featured kitchens with worktop extensions
- USB ports
- 150bhp Peugeot engine as standard
- Fiat Ducato 130bhp Comfort-Matic engine#



Rear travel seats



## Specification

- Vehicle Height (incl TV aerial) - 2700mm
- MTPLM - 3500kg
- MIRO - 3004kg
- Maximum User Payload - 496kg
- Essential Habitation Equipment - 0kg
- Fresh Water Tank - 69ltrs
- Waste Water Tank - 40ltrs

\* Premium Pack #Optional



# Kemerton XL - Classic Ensuite

**NEW  
FOR 2015**

Offering everything you could ever want in a van conversion and designed to offer you the very best in luxurious living, with a full width washroom boasting a separate shower, a fully featured kitchen and spacious lounge with an additional rear travelling seat plus a specification second to none...



## Vehicle Layout

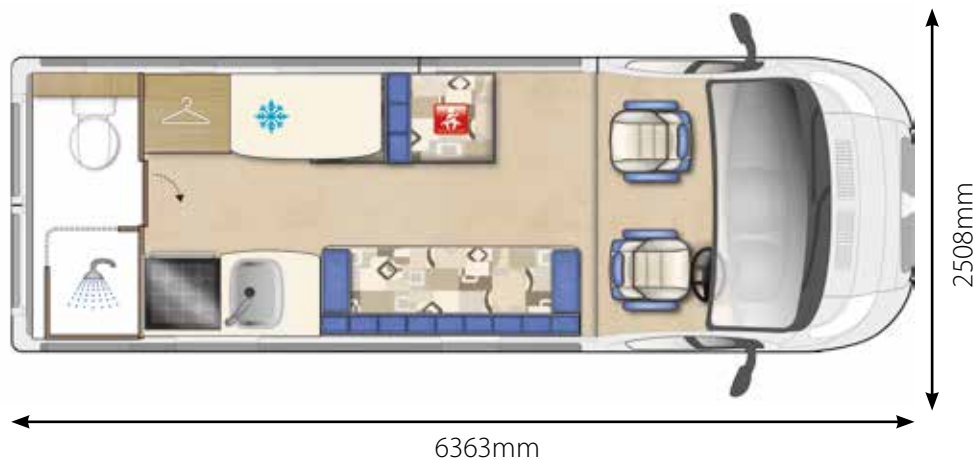

## Sleeping Options



## Key Features

- Full width washroom with separate shower
- 20ltr liquid capacity underfloor LPG gas tank
- AL-KO Air-Top & Twin Leaf rear suspension\*
- Thule (Omnistor) canopy awning\*
- Full spectrum reversing camera with permanent feed\*
- Athermic flush fitting & insulating privacy glass
- Alloy wheels\* plus spare wheel & carrier
- 4 colours including 3 metallic finishes
- Colour-coded front bumper
- LED daytime running lights
- External BBQ socket
- Fully featured kitchens with worktop extensions
- USB ports
- 150bhp Peugeot engine as standard
- Fiat Ducato 130bhp Comfort-Matic engine#



Rear travel seats



## Specification

- Vehicle Height (incl TV aerial) - 2640mm
- MTPLM - 3500kg
- MIRO - 3135kg
- Maximum User Payload - 365kg
- Essential Habitation Equipment - 15kg
- Fresh Water Tank - 69ltrs
- Waste Water Tank - 40ltrs

\* Premium Pack #Optional



# Kingham - *King of the Road*

The Kingham raises the bar to an all-new level, featuring a fixed French double bed that can slide back to lift the rear section to provide backrest support, pulls down flat for night time use and can lift up on gas struts for access to the large storage area beneath. A fully featured kitchen is on the nearside with bespoke sofa seating and swivelling cab seats at the front combining to make this a unique and exceptional proposition for luxury 2 berth accommodation



## Vehicle Layout



## Key Features

- Luxurious double fixed bed
- 20ltr liquid capacity underfloor LPG gas tank
- AL-KO Air-Top & Twin Leaf rear suspension\*
- Thule (Omnistor) canopy awning\*
- Full spectrum reversing camera with permanent feed\*
- Athermic flush fitting & insulating privacy glass
- Alloy wheels\* plus spare wheel & carrier
- 4 colours including 3 metallic finishes
- Colour-coded front bumper
- LED daytime running lights
- External BBQ socket
- Fully featured kitchens with worktop extensions
- USB ports
- 150bhp Peugeot engine as standard
- Fiat Ducato 130bhp Comfort-Matic engine#



## Specification

- Vehicle Height (incl TV aerial) - 2640mm
- MTPLM - 3500kg
- MIRO - 3148kg
- Maximum User Payload - 352kg
- Essential Habitation Equipment - 0kg
- Fresh Water Tank - 69ltrs
- Waste Water Tank - 40ltrs

\* Premium Pack #Optional



# Warwick XL - *Ergonomically Stunning*

The Warwick XL builds on the concept of the ever-popular Warwick Duo by providing the ergonomically comfortable rear lounge, which converts quickly into full-length single beds or a capacious double bed. In addition to this, it boasts a spacious bathroom featuring a fully separate shower and a large fully featured kitchen on the nearside to provide luxuriously open plan accommodation ideal for both short breaks and long term touring alike.



## Vehicle Layout

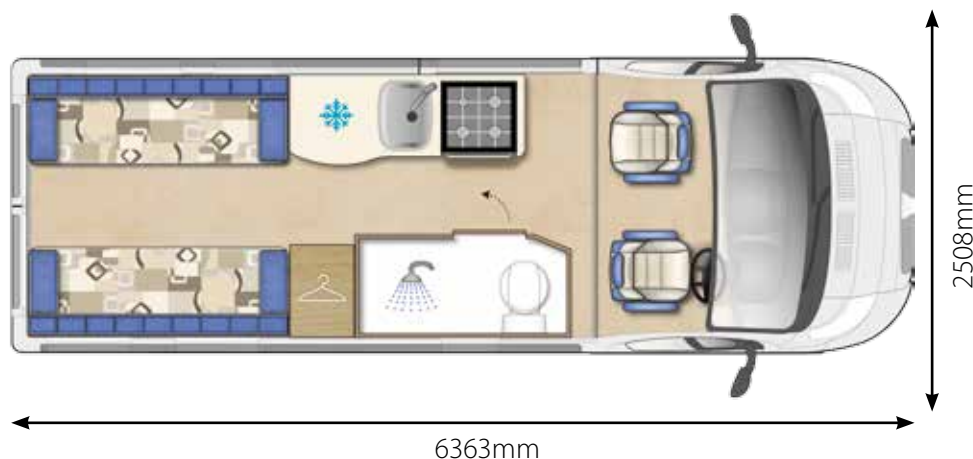

## Sleeping Options

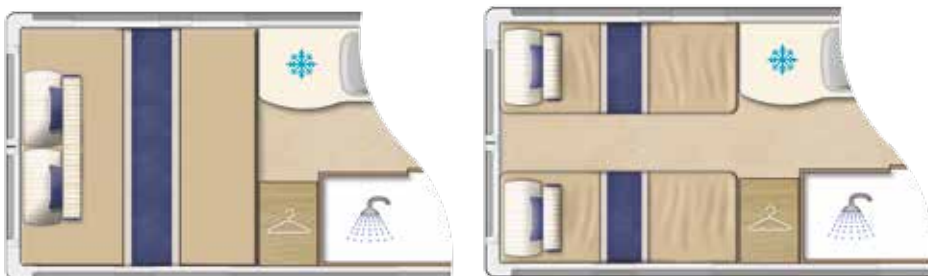

## Key Features

- Spacious lounge with full size single beds
- 20ltr liquid capacity underfloor LPG gas tank
- AL-KO Air-Top & Twin Leaf rear suspension\*
- Thule (Omnistor) canopy awning\*
- Full spectrum reversing camera with permanent feed\*
- Athermic flush fitting & insulating privacy glass
- Alloy wheels\* plus spare wheel & carrier
- 4 colours including 3 metallic finishes
- Colour-coded front bumper
- LED daytime running lights
- External BBQ socket
- Fully featured kitchens with worktop extensions
- USB ports
- 150bhp Peugeot engine as standard
- Fiat Ducato 130bhp Comfort-Matic engine#



## Specification

- Vehicle Height (incl TV aerial) - 2640mm
- MTPLM - 3500kg
- MIRO - 3112kg
- Maximum User Payload - 388kg
- Essential Habitation Equipment - 0kg
- Fresh Water Tank - 69ltrs
- Waste Water Tank - 40ltrs

\* Premium Pack #Optional



# Specification

The Peugeot Boxer incorporates a series of innovations, including a particle emissions filter, to reduce the CO<sub>2</sub> impact to the environment without reducing power or performance. HDi, the common rail injection system delivers lower emissions in line with current European legislation.

Standard safety features include ABS - Anti-lock Braking System, EBA - Emergency Braking Assistance, EBFD - Electronic Brake Force Distribution, disc brakes, passenger and driver's airbags, fuel supply safety cut off, driver's seat belt indicator and safety auto-reverse on drivers' door mirror.

## Choice Of Colours

Peugeot van conversions are available in a choice of 4 colours.

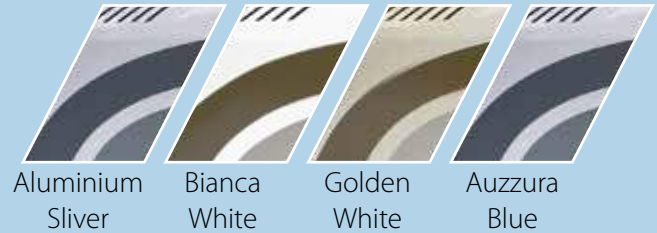

## Underfloor Mounted LPG Tank

For 2015 Auto-Sleepers have installed a 20 litre liquid capacity LPG gas tank across the entire range of Peugeot based Motorhomes, offering hassle free practicality with numerous benefits including -

- Readily available from 1000's of petrol stations throughout Great Britain and Europe.
- Convenience personified, refilling them is as easy as filling the fuel tank
- No heavy bottles to lift, carry or manhandle
- No middle of the night change overs required
- Economical to use at approximately half the cost of cylinders, cost per litre typically only 75p
- Interior space saving, the tank is externally mounted to the underside of the Motorhome
- Easy read LED tank gauge and an Auto-Stop feature to prevent any chance of overfilling
- Reliable and safety proven, extensively tested for peace of mind and fully approved under European whole vehicle type approval legislation.



## Athermic Windows

Auto-Sleepers' Peugeot van conversions feature factory bonded athermic windows, a stylish and practical solution that reflects heat in both directions, provides insulation for year round use, offers improved security and are tinted for maximum privacy.



AL-KO AIR-TOP SUSPENSION, ONCE EXPERIENCED, NEVER DRIVEN WITHOUT.

The AL-KO Air-Top system is fitted as a proven performance enhancing upgrade to Peugeots own twin leaf rear axle suspension.

The system increases roll and road holding stability and provides significantly improved driving comfort even under full load.

The dual circuit system is entirely maintenance free and can be used independently on each rear wheel to assist levelling out uneven loading whilst travelling and/or onsite when parking on uneven ground.



## Premium Pack Upgrades

- Alloy wheels
- Cab air conditioning
- Cruise control
- Thule (Omnistor) canopy awning
- Colour reversing camera
- AL-KO AirTop suspension
- Front fog lights

## Winter Pack

**TANKBLANKET™**

- Concertina cab blinds in lieu of cab curtains
- Fresh & waste water tank heater blanket
- Truma Combi heater upgrade
- Wheel arch insulation blankets

## Base Vehicle Specification

- Peugeot Twin Leaf rear suspension and AL-KO dual Air-Top suspension system installed\*
- Turbo Diesel 150bhp Euro V manual engine
- Optional Fiat Ducato 130bhp Comfort-Matic Engine#
- 15" alloy wheels\*
- Cruise control\*
- Cab air conditioning\*
- Bluetooth® Hands Free Connectivity
- Digital DAB radio with touchscreen/ CD player
- iPod multimedia connection socket
- ABS brakes with EBD
- Single key central locking for cab and habitation door
- Driver and passenger airbags
- Driver and passenger seat armrest
- Power assisted steering
- Electrically heated and adjustable door mirrors
- Electric cab windows
- Front\* & Rear fog lights
- Lockable glove box
- 12v socket
- UV filtering tinted glass
- Cab curtains and removable cab carpet
- Spare wheel on carrier with remote tyre pressure valve
- LED daytime running lights



### Interior General

- Luxurious Verada Oak furniture with chrome fixtures and fittings
- Panoramic opening rooflight
- Privacy blinds & flyscreen's to all opening windows
- Choice of five Belgium chenille fabrics providing luxurious interior soft furnishings
- High quality Reflex™ foam upholstery
- Memory foam mattress\*\*
- Scatter cushions
- Removable interior carpets including the cab
- LED spotlights and roof lighting with a power saving of up to 70%
- Gas strut assisted bed tops and drop down access door to under seat storage space
- Swivel cab seats on all front lounge models.
- Over-cab storage compartment
- Spacious wardrobe
- Range of high & low level storage lockers.
- Cocktail cabinet with crystal wine glasses
- Smoke and carbon monoxide alarms
- Fire extinguisher
- Freestanding and/or single leg tables
- Low level LED lighting in the elevated cab step fascia

### Exterior General

- Four body colours to choose from including 3 metallic paint colours
- Colour co-ordinated front bumper to match
- Athermically treated privacy glass with concertina blinds & flyscreen's
- Space saving 20 litre liquid under floor mounted LPG gas tank fitted with LED level gauge
- Thule (Omnistor) roof mounted canopy awning\*
- LED strip awning light
- External TV socket
- External gas BBQ point
- External 230v mains socket
- Multi directional TV aerial
- Styling longitudinal roof bars
- Electric slide-out entrance step with auto retract on engine start

### Electrics and Plumbing

- LCD control panel
- Split charged 105 amp hour Leisure battery
- Four 230v sockets & two 12v sockets
- Electric mains hook up lead
- Truma dual fuel Combi blown air central heating and water heater
- Whale blown air gas/electric heating
- Whale hot water heater
- Submersible water pump
- 69 litre fresh water tank
- 40 litre waste tank
- Large bore waste pipe work for efficient drainage

### Bathroom

- Combined shower and toilet compartment with integrated washbasin
- Vanity cupboard/storage
- Separate shower cubicle with extractor fan (Kemerton XL)
- Electric flush cassette toilet with separate header tank
- Chrome fixtures and fittings
- Storage cupboard
- Anti slip shower mat
- Ducted blown air outlet
- LED lighting
- Roof vent with flyscreen

### Kitchen

- Spacious and fully equipped with additional work surface
- Hob with 3 burner hob plus electronic ignition oven and grill
- 230v microwave oven
- 12 volt extractor fan with down-lighters
- 3 way large refrigerator with freezer compartment
- Kitchen centre sink incorporating draining board and cutlery drying rack
- Cutlery drawer
- Kitchen roll holder
- Melamine crockery set & cooler bag

**\*Premium pack \*\*Fixed bed Models only #Optional**

# Peugeot Coachbuilds



Models

6

Min Berth



Max Berth



Peugeot is a popular choice amongst Auto-Sleeper customers and our relationship with them is long standing, harking back to when some of our first ever models were based on the Commer chassis, now part of Peugeot. Auto-Sleeper offers both low profile and highline Coachbuilt models with a choice of Short, Medium and Long wheel base chassis all of which feature car like drivability.

# Peerless Refinement



Our Peugeot Coachbuilds feature Grade III Classification for heating and thermal insulation.



BRAND NEW FOR 2015

Optional Fiat Ducato 130bhp Comfort-matic gearbox available on all Auto-Sleeper 2015 Peugeot models.

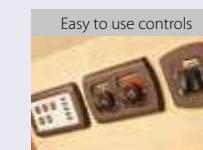

- |  |  |  |  |  |  |
|--|--|--|--|--|--|
| A. Turbo Diesel 150bhp Euro V engine   | D. Wing mirror aerial                                    | upgraded to 80W*   | L. Fully featured kitchens                                   | R. Rear mud flaps  | U. 20 litre liquid capacity under-floor mounted LPG gas tank |
| B. Fiat Comfort-Matic 130bhp automatic engine*   | E. Luxury Valencia furniture or Amarti furniture         | I. Thule (Omniistor) canopy awning                                       | M. Safe and fire extinguisher                                | S. Spacious en-suite washroom facilities                           | V. Alloy wheels*   |
| C. Cab air conditioning, cruise control*, digital DAB radio with touchscreen, Bluetooth* & passenger air-bag | F. Wind-up opening skyview window & panoramic roof-light | J. Full scratch and impact resistant GRP body with Platinum sides        | N. Crockery set & crystal glasses                            | T. Large skirt storage locker, underfloor mounted for space saving | W. Front fog lights  |
|  | G. Designer 'Moonstone' fabrics                          | K. Full spectrum reversing camera with permanent feed for rear view use* | O. External BBQ & 230v mains socket                          |  | X. Colour coded bumpers                                      |
|  | H. 30W solar panel* which can be                         |  | P. Rear corner steadies                                      |  |  |
|  |  |  | Q. Spare wheel and carrier with a remote tyre pressure valve |  |  |

**\* Premium Pack #Optional**

# Nuevo ES/EK - *Petite yet Spacious*

The most compact of motorhomes at 5.71m, which belies the space available inside this iconic model. The EK now boasts its best ever specification and with the inclusion of a space saving and economical LPG gas tank our designers have massively increased internal and external storage space to boot. Quite simply the best just got even better.



## Vehicle Layout

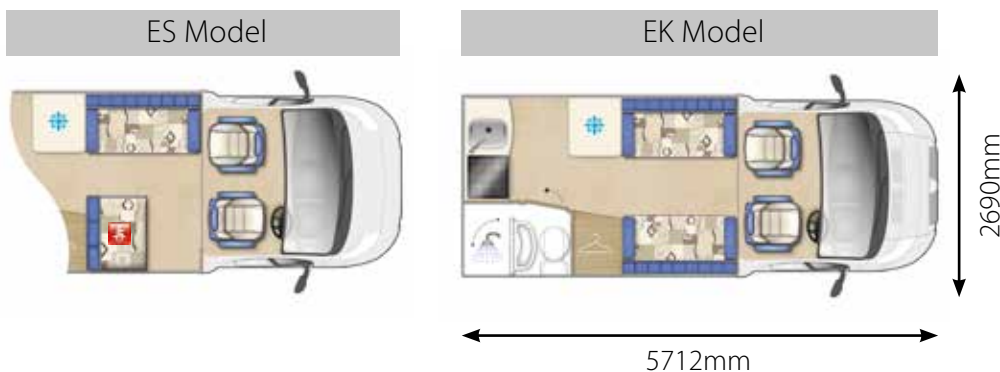

## Sleeping Options

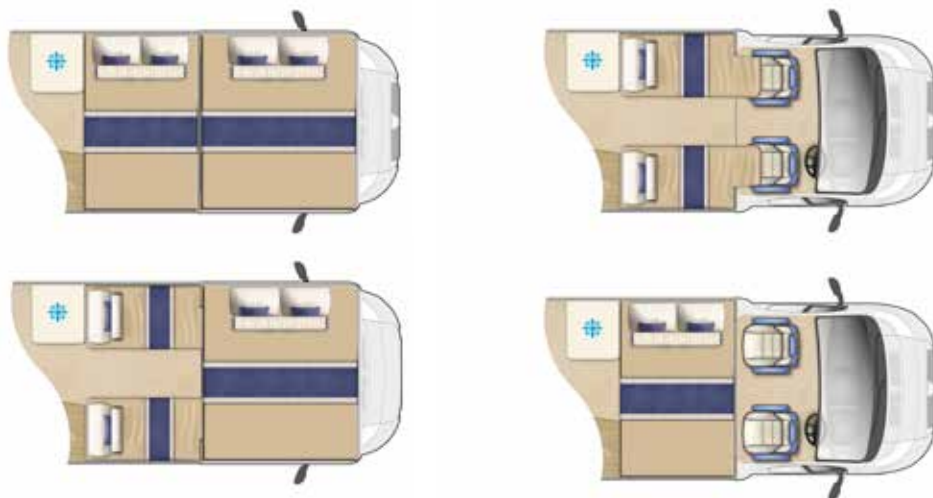

## Key Features

- Iconic model, under 6m, rear travel seats, single beds, end kitchen
- 20 litre liquid capacity LPG gas tank
- 30W solar panel\*
- External skirt storage locker
- GRP body with scratch & impact resistant platinum sides
- Opening skyview window (LP only)
- Panoramic wind-up roof-light
- Thule (Omnistor) canopy awning\*
- Full spectrum reversing camera with permanent feed\*
- Alloy wheels\* with spare wheel & carrier
- LED daytime running lights\*
- External BBQ & 230v mains sockets
- Safe, fire extinguisher, crockery set & crystal glasses
- USB ports
- Turbo diesel 150bhp Euro V engine
- Optional Fiat Ducato 130bhp Comfort-Matic Engine<sup>#</sup>

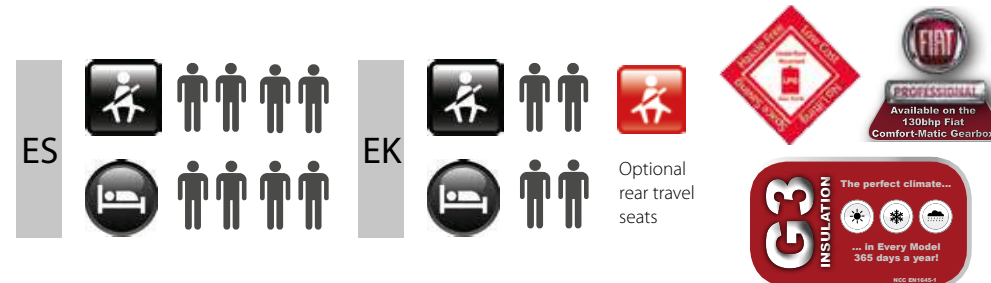

## Specification

- Vehicle Height - 3005mm / 2875mm\*\*
- MTPLM - 3500kg/3300kg\*\*
- MIRO - 3047kg/2935kg\*\*
- Maximum User Payload - 453kg/365kg\*\*
- Essential Habitation Equipment - 7kg
- Fresh Water Tank - 102ltrs
- Waste Water Tank - 71ltrs

\* Premium Pack <sup>#</sup>Optional



# Broadway EK - *Flexible Family Luxury*

The family friendly EK builds on the strengths of the EKTb LP, adding the flexibility of 2 travelling seats in the rear, allowing safe travel for up-to 4 in this ever-popular model. The bathroom offers ingenious space saving functionality; the fully featured kitchen accommodates your every dining need's and for 2015 now boasts its highest ever specification delivering true luxury touring capability.



## Vehicle Layout

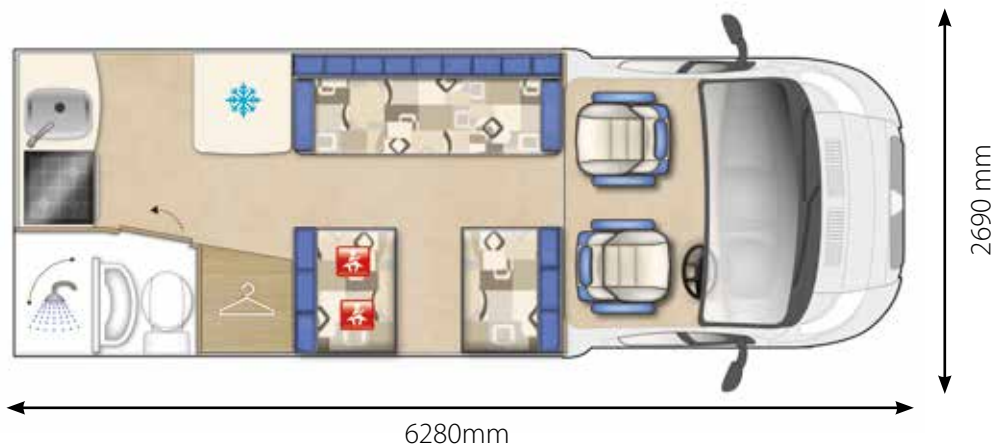

## Sleeping Options

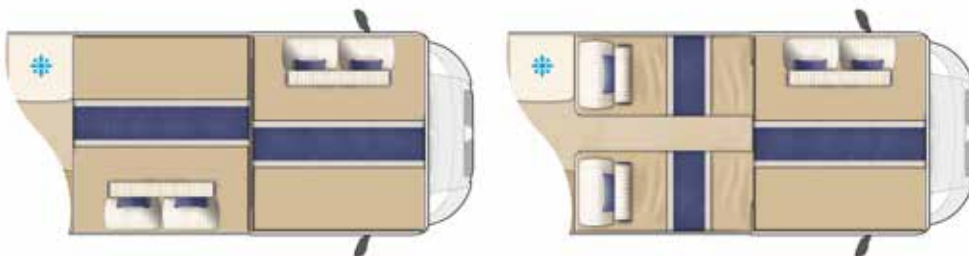

## Key Features

- Family friendly, 2 rear travel seats & beds for up to 4 people
- 20 litre liquid capacity LPG gas tank
- 30W solar panel\*
- External skirt storage locker
- GRP body with scratch & impact resistant platinum sides
- Opening skyview window (LP only)
- Panoramic wind-up roof-light
- Thule (Omnistor) canopy awning\*
- Full spectrum reversing camera with permanent feed\*
- Alloy wheels\* with spare wheel & carrier
- LED daytime running lights\*
- External BBQ & 230v mains sockets
- Safe, fire extinguisher, crockery set & crystal glasses
- USB ports
- Turbo diesel 150bhp Euro V engine
- Optional Fiat Ducato 130bhp Comfort-Matic Engine#



Rear travel seats



## Specification

- Vehicle Height - 3005mm
- MTPLM - 3500kg
- MIRO - 3126kg
- Maximum User Payload - 374kg
- Essential Habitation Equipment - 7kg
- Fresh Water Tank - 102ltrs
- Waste Water Tank - 71ltrs

\* Premium Pack #Optional



# Broadway EK TB LP - *Iconic Comfort for Two*

The EK TB LP builds on the popularity of the Nuevo EK to deliver a spacious no compromise front lounge end kitchen model, which delivers on every front, with a huge lounge, which converts quickly at night to provide a choice between full-length singles or a pandering double bed. The specification has been increased for 2015 to our highest ever levels to deliver full-featured luxury, befitting of Auto-Sleeper and evident in strong residual values for our customers.



## Vehicle Layout

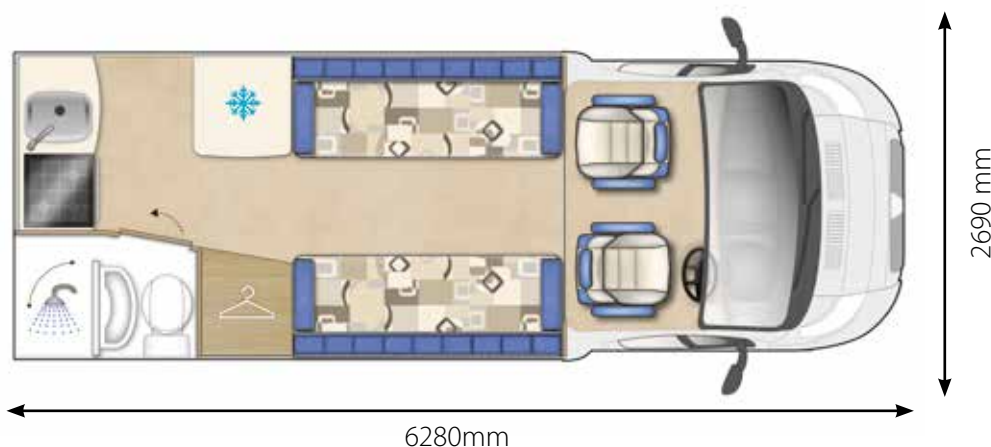

## Sleeping Options



## Key Features

- Full single beds, swingwall washroom, end kitchen
- 20 litre liquid capacity LPG gas tank
- 30W solar panel\*
- External skirt storage locker
- GRP body with scratch & impact resistant platinum sides
- Opening skyview window (LP only)
- Panoramic wind-up roof-light
- Thule (Omnistor) canopy awning\*
- Full spectrum reversing camera with permanent feed\*
- Alloy wheels\* with spare wheel & carrier
- LED daytime running lights\*
- External BBQ & 230v mains sockets
- Safe, fire extinguisher, crockery set & crystal glasses
- USB ports
- Turbo diesel 150bhp Euro V engine
- Optional Fiat Ducato 130bhp Comfort-Matic Engine#



Optional rear travel seats



## Specification

- Vehicle Height - 2970mm
- MTPLM - 3500kg
- MIRO - 3029kg
- Maximum User Payload - 471kg
- Essential Habitation Equipment - 7kg
- Fresh Water Tank - 102ltrs
- Waste Water Tank - 71ltrs

\* Premium Pack #Optional



# Broadway<sup>EB</sup> - *Prestigious comfort*

Epitomising pampered touring, the perfectly proportioned EB combines a superb feature washroom with a spacious lounge and kitchen whilst retaining the functionality and maneuverability of the medium wheel base chassis delivering total freedom to explore in total comfort. The EB also boasts a specification, which is second to none and befitting its pedigree as a luxury-touring vehicle.



## Vehicle Layout

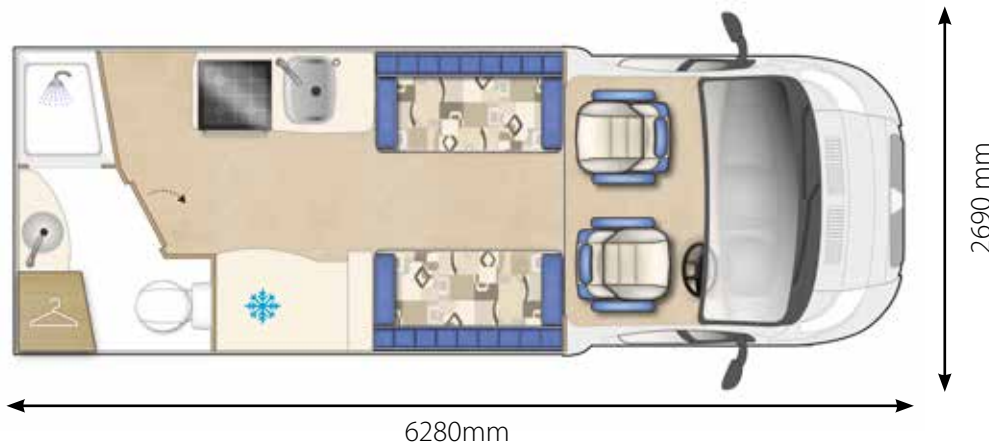

## Sleeping Options



## Key Features

- Front lounge, feature kitchen, luxury rear bathroom
- 20 litre liquid capacity LPG gas tank
- 30W solar panel\*
- External skirt storage locker
- GRP body with scratch & impact resistant platinum sides
- Opening skyview window (LP only)
- Panoramic wind-up roof-light
- Thule (Omnistor) canopy awning\*
- Full spectrum reversing camera with permanent feed\*
- Alloy wheels\* with spare wheel & carrier
- LED daytime running lights\*
- External BBQ & 230v mains sockets
- Safe, fire extinguisher, crockery set & crystal glasses
- USB ports
- Turbo diesel 150bhp Euro V engine
- Optional Fiat Ducato 130bhp Comfort-Matic Engine<sup>#</sup>



Optional rear travel seats



## Specification

- Vehicle Height - 2970mm
- MTPLM - 3500kg
- MIRO - 3095kg
- Maximum User Payload - 415kg
- Essential Habitation Equipment - 7kg
- Fresh Water Tank - 102ltrs
- Waste Water Tank - 71ltrs

\* Premium Pack <sup>#</sup>Optional



# Broadway EL Duo - *Best of British*

This luxury 2-berth model features our largest feature kitchen, a huge washroom with separate shower and a spacious 6'5' rear lounge which epitomises the best of British touring. Built on the LWB chassis and brimming with high value specification throughout the EL Duo delivers on every front, without compromise to comfort and unabashed luxury for the discerning buyer.



## Vehicle Layout

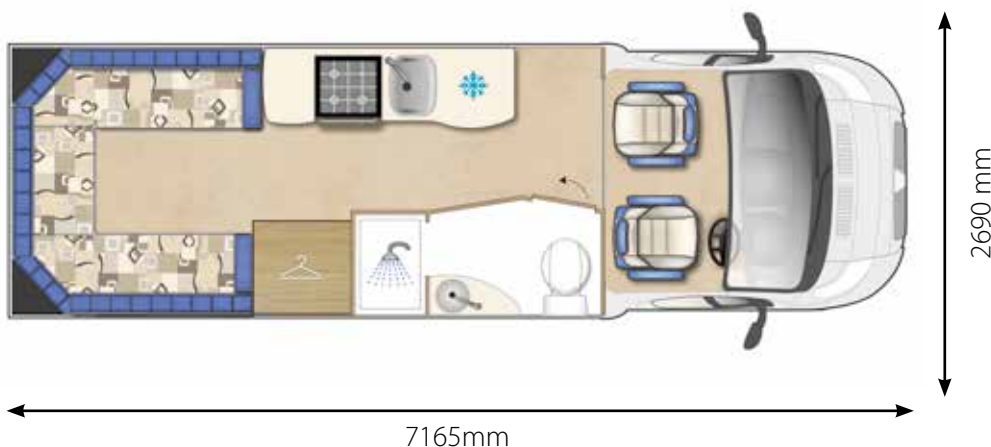

## Sleeping Options



## Key Features

- 6'5" rear lounge, large kitchen & separate shower
- 20 litre liquid capacity LPG gas tank
- 30W solar panel\*
- External skirt storage locker
- GRP body with scratch & impact resistant platinum sides
- Opening skyview window (LP only)
- Panoramic wind-up roof-light
- Thule (Omnistor) canopy awning\*
- Full spectrum reversing camera with permanent feed\*
- Alloy wheels\* with spare wheel & carrier
- LED daytime running lights\*
- External BBQ & 230v mains sockets
- Safe, fire extinguisher, crockery set & crystal glasses
- USB ports
- Turbo diesel 150bhp Euro V engine
- Optional Fiat Ducato 130bhp Comfort-Matic Engine<sup>#</sup>



## Specification

- Vehicle Height - 2930mm
- MTPLM - 3500kg
- MIRO - 3220kg
- Maximum User Payload - 280kg
- Essential Habitation Equipment - 15kg
- Fresh Water Tank - 102ltrs
- Waste Water Tank - 78ltrs

\* Premium Pack <sup>#</sup>Optional



# Broadway FB - *Classic French Bed*

For many years our customers have desired the introduction of a fixed French bed model on a 3500kg chassis whilst crucially retaining the absolute luxury Auto-Sleepers are renowned for. A generously proportioned front lounge blends through a fully featured kitchen into a luxurious feature bedroom with spacious side washroom which boasts a separate shower all delivered across a flat level floor for full practicality.



## Vehicle Layout

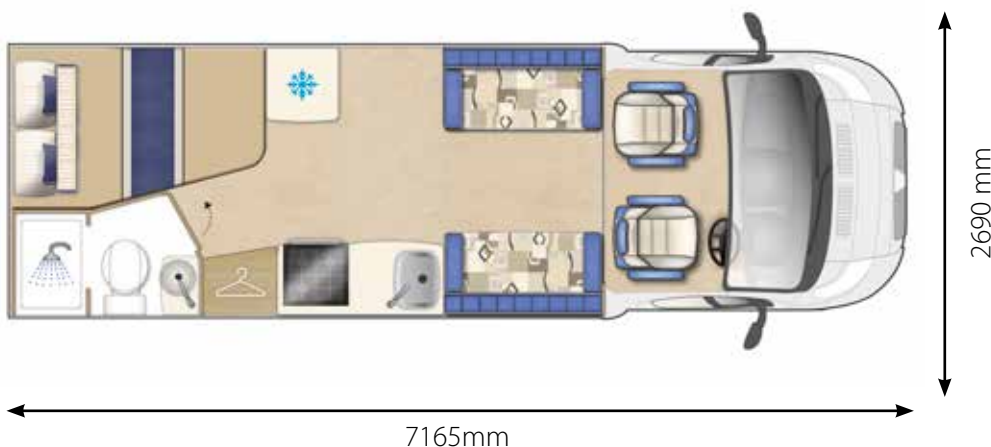

## Sleeping Options



## Key Features

- French bed, luxury kitchen and separate shower
- 20 litre liquid capacity LPG gas tank
- 30W solar panel\*
- External skirt storage locker
- GRP body with scratch & impact resistant platinum sides
- Opening skyview window (LP only)
- Panoramic wind-up roof-light
- Thule (Omnistor) canopy awning\*
- Full spectrum reversing camera with permanent feed\*
- Alloy wheels\* with spare wheel & carrier
- LED daytime running lights\*
- External BBQ & 230v mains sockets
- Safe, fire extinguisher, crockery set & crystal glasses
- USB ports
- Turbo diesel 150bhp Euro V engine
- Optional Fiat Ducato 130bhp Comfort-Matic Engine<sup>#</sup>



Optional rear travel seats



## Specification

- Vehicle Height - 2930mm
- MTPLM - 3500kg
- MIRO - 3195kg
- Maximum User Payload - 305kg
- Essential Habitation Equipment - 15kg
- Fresh Water Tank - 102ltrs
- Waste Water Tank - 91ltrs

\* Premium Pack <sup>#</sup>Optional



# Specification

The Peugeot Boxer incorporates a series of innovations, including a particle emissions filter, to reduce the CO2 impact to the environment without reducing power or performance. HDi, the common rail injection system delivers lower emissions in line with current European legislation.

Standard safety features include ABS - Anti-lock Braking System, EBA - Emergency Braking Assistance, EBFD - Electronic Brake Force Distribution, disc brakes, passenger and driver's airbags, fuel supply safety cut off, driver's seat belt indicator and safety auto-reverse on drivers' door mirror.

## Base Vehicle Specification

- Turbo diesel 150bhp Euro V engine
- Optional Fiat Ducato 130bhp Comfort-Matic Engine<sup>#</sup>
- 15" Alloy wheels\* plus spare wheel & carrier
- Cruise control\*
- Cab air conditioning\*
- Bluetooth® connectivity & steering wheel controls
- Digital DAB radio with touchscreen/ CD player
- Ipod multimedia connection socket
- ABS brakes with EBD

## Cab Features



Bluetooth Connectivity & Steering Wheel Controls



Cruise Control



Cab Air Conditioning



CD/Radio including Bluetooth Connection



6 Speed Manual Gearbox

## Underfloor Mounted LPG Tank

For 2015 Auto-Sleepers have installed a 20 litre liquid capacity LPG gas tank across the entire range of Peugeot based motorhomes, offering hassle free practicality with numerous benefits including -

- Readily available from 1000's of petrol stations throughout Great Britain and Europe.
- Convenience personified, refilling them is as easy as filling the fuel tank
- No heavy bottles to lift, carry or manhandle
- No middle of the night change overs required
- Economical to use at approximately half the cost of cylinders, cost per litre typically only 75p
- Interior space saving, the tank is externally mounted to the underside of the motorhome
- Easy read LED tank gauge and an Auto-Stop feature to prevent any chance of overfilling
- Reliable and safety proven, extensively tested for peace of mind and fully approved under European whole vehicle type approval legislation.



LPG Filling Point



LPG Gas Tank

## Upgrades

### Premium Pack

- Alloy wheels
- Cab air conditioning
- Cruise control
- Thule (Omnistor) canopy awning
- Colour reversing camera
- 30w solar panel
- LED daytime running lights

### Winter Pack

- Concertina cab blinds in lieu of cab curtains
- Fresh & waste water tank heater blanket
- Truma Combi heater upgrade
- Wheel arch insulation blankets

**TANKBLANKET**

### Interior General

- Luxurious Valencia or Amarti furniture with chrome fixtures and fittings
- Panoramic wind-up opening rooflight
- Privacy blinds & flyscreens to all opening windows
- Choice of five Belgium chenille fabrics providing luxurious interior soft furnishings
- High quality Reflex™ foam upholstery
- Colour co-ordinated habitation curtains with tiebacks and scatter cushions.
- Removable interior carpets
- LED spotlights and roof lighting with a power saving of up to 70%
- Over locker LED mood lighting
- Seat tops on gas struts and drop down access door to the under seat storage space
- Swivel cab seats on all front lounge models.
- Over-cab storage compartments
- Spacious wardrobe
- Range of high & low-level storage lockers.
- Cocktail cabinet with crystal wine glasses
- Freestanding table
- Foot-well entry step with as logo light
- Smoke and carbon monoxide alarms
- Fire extinguisher

### Exterior General

- Space saving under-floor 20 litre liquid capacity LPG gas tank with LED level indicator
- GRP sidewalls in scratch and impact resistant platinum or white
- Opening wind-up sky-view window\*\*
- Aluminium skirts
- Large external skirt locker (space saving under-floor mounted)
- Drop down access door to nearside seating
- 30w solar panel\*
- Optional upgrade to 80w solar panel†
- Thule (Omnistor) roof mounted canopy awning\*
- LED strip awning light
- LED daytime running lights\*
- Colour co-ordinated external TV socket
- Colour co-ordinated external gas BBQ point
- Colour co-ordinated external 230v mains socket
- Hartal exterior door with central locking
- Double-glazed opening windows with concertina blinds & flyscreens
- Multi directional status TV aerial
- Electric slide-out entrance step with auto retract on engine start
- Rear mud-flaps
- Rear corner steadies

### Electrics and Plumbing

- LCD control panel
- Split charged 105 amp leisure battery
- Four 230v sockets
- Two 12v sockets
- Electric hook up lead
- 4kW Truma dual fuel combi blown air central heating and water heater
- Submersible water pump
- 102 Litre fresh water tank
- 78 Litre waste water tank
- Large bore waste pipework for efficient drainage
- Whale auto-fill & manual filler for fresh water tank

### Kitchen

- Spacious and fully equipped with large slide out additional work surface
- Dual fuel hob with 3 gas burners and an electric hot plate plus separate oven and grill
- Dual level microwave oven
- 12v extractor fan with down-lighters
- Large refrigerator with freezer compartment

### Bathroom

- Combined shower and toilet compartment
- Swing wall showers with integrated washbasin
- Vanity cupboard with mirrors
- Separate shower cubicle (Broadway EB FB and EL Duo)
- Electric flush cassette toilet with separate header tank
- Chrome fixtures and fittings
- Storage cupboard
- Anti-slip shower mat
- Ducted blown air heating outlet
- LED lighting
- Retractable clothes line (model specific)
- Roof vent with flyscreen

*\*Premium Pack \*\*Low Profile roof only †Optional*

# Mercedes Coachbuilts



Models

6

Min Berth



Max Berth



Mercedes is justly held in high regard around the world for its engineering pedigree and the Mercedes chassis has been designed for motorhomes, making Mercedes the perfect partner to form the foundation of our flagship motorhome range. The Auto-Sleeper Mercedes range comes as standard with a vast array of electronic driving aids, all of which work in the background to make the journey as effortless and pleasurable as the destination and as the option of the best fully automatic gearbox available on a motorhome.

# Peerless Refinement



Our Mercedes Coachbuilds feature Grade III Classification for heating and thermal insulation.



- A. Full Mercedes-Benz electrics package: ESP with Active Skid Control & ABS with EBD
- B. Fully automatic 7-speed gearbox\*
- C. Cab air conditioning & cruise control\*
- D. Luxury Amarti furniture
- E. Wind-up opening skyview window & panoramic roof-light
- F. 30w solar panel which can be upgraded to 80W\*
- G. Designer 'Moonstone' fabrics
- H. Thule (Omnistor) canopy awning (up to 5m)\*
- I. Full scratch and impact resistant GRP body with platinum sides
- J. Full spectrum reversing camera with permanent feed for rear view use\*
- K. Spacious en-suite washroom facilities
- L. External BBQ & 230v mains socket
- M. Rear corner steadies
- N. Spare wheel and carrier with a remote tyre pressure valve^
- O. Rear mud flaps
- P. Fully featured kitchens
- Q. Large skirt storage locker, underfloor mounted for space saving
- R. 20 litre liquid capacity under-floor mounted LPG gas tank
- S. Safe, fire extinguisher
- T. Crockery set & crystal glasses
- U. Alloy wheels\*
- V. Colour coded bumpers

**\* Premium Pack \*\* Excludes Stanton**

# Stanton - *Powerful and Compact*

The Stanton is our most compact model built on the Mercedes rear wheel drive chassis and at 5.94m belies the living space available inside and the flagship specification levels including an optional fully Automatic gearbox. The Stanton truly is the king of all Compact Motorhomes, offering everything you could ever need and more whilst the Mercedes offers unprecedented driving comfort and is feature packed to make even the longest journey a breeze.



## Vehicle Layout

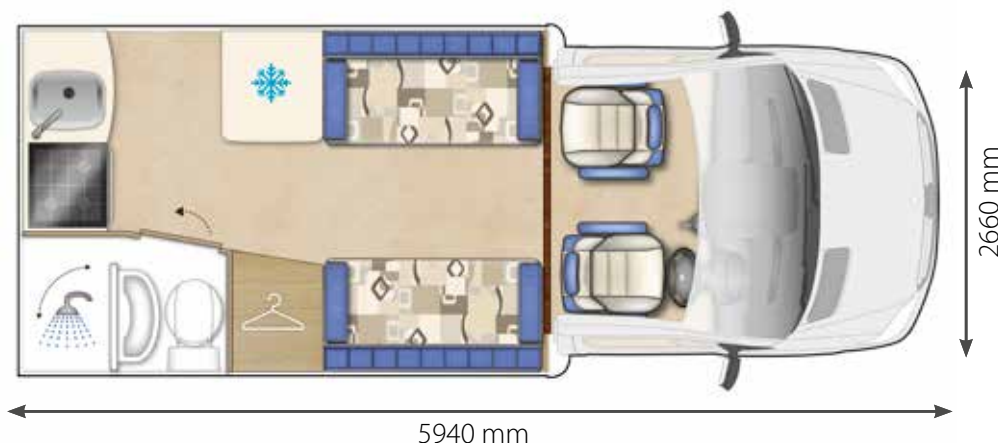

## Sleeping Options



## Key Features

- Iconic model under 6m with single beds and end kitchen
- Optional 7 speed (163bhp) fully automatic gearbox<sup>#</sup>
- Full Mercedes electrics package: ESP with active skid control & ABS with EBD
- 30W solar panel\*
- External skirt storage locker
- GRP body with scratch & impact resistant platinum sides
- Opening wind-up skyview window
- Panoramic wind-up roof-light
- Thule (Omnistor) canopy awning\*
- Full spectrum reversing camera with permanent feed\*
- Alloy wheels\* plus spare wheel & carrier
- External BBQ & 230v mains sockets
- Safe, fire extinguisher, crockery set & crystal glasses
- USB ports
- 20 litre liquid capacity under floor mounted LPG gas tank



## Specification

- Vehicle Height - 2850mm
- MTPLM - 3200kg
- MIRO - 2985kg
- Maximum User Payload - 215kg
- Essential Habitation Equipment - 7kg
- Fresh Water Tank - 71ltrs
- Waste Water Tank - 53ltrs

*\* Premium Pack <sup>#</sup>Optional*



# Bourton - *Quintessential Luxury*

The Bourton builds on the popularity of the Stanton to deliver a spacious no compromise front lounge end kitchen model, which delivers on every front. Its huge lounge quickly converts at night to provide a choice between full-length singles or a decadent double bed whilst the Mercedes chassis is renowned for its driving comfort and the optional fully automatic gearbox makes it the perfect base vehicle for a luxuriously specified flagship range.



## Vehicle Layout

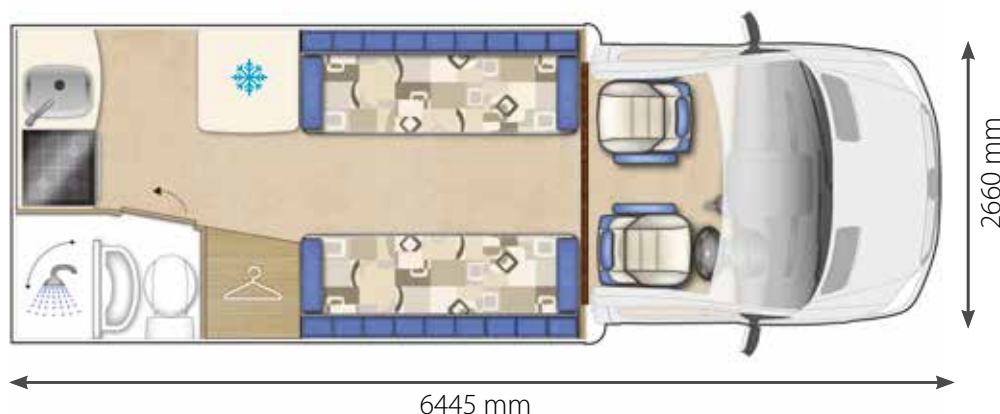

## Sleeping Options

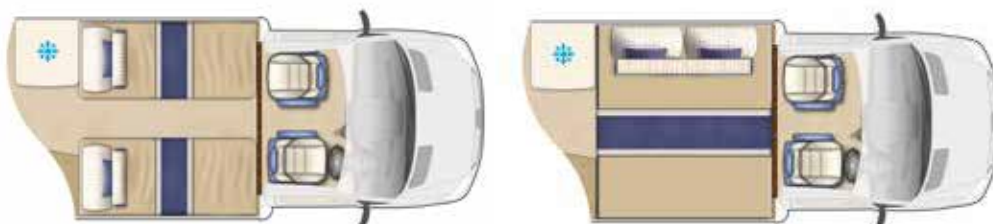

## Key Features

- Full single beds, swingwall washroom, end kitchen
- Optional 7 speed (163bhp) fully automatic gearbox<sup>#</sup>
- Full Mercedes electrics package: ESP with active skid control & ABS with EBD
- 30W solar panel\*
- External skirt storage locker
- GRP body with scratch & impact resistant platinum sides
- Opening wind-up skyview window
- Panoramic wind-up roof-light
- Thule (Omnistor) canopy awning\*
- Full spectrum reversing camera with permanent feed\*
- Alloy wheels\* plus spare wheel & carrier
- External BBQ & 230v mains sockets
- Safe, fire extinguisher, crockery set & crystal glasses
- USB ports
- 20 litre liquid capacity under floor mounted LPG gas tank



Optional rear travel seats



## Specification

- Vehicle Height - 2860mm
- MTPLM - 3500kg
- MIRO - 3108kg
- Maximum User Payload - 392kg
- Essential Habitation Equipment - 7kg
- Fresh Water Tank - 71ltrs
- Waste Water Tank - 53ltrs

*\* Premium Pack <sup>#</sup>Optional*



# Winchcombe - Award Winning Classic

Luxury personified befits the Winchcombe which delivers the perfectly proportioned 2-berth motorhome with its capacious front lounge, top of the range centre kitchen and luxurious end washroom boasting a double shower to deliver full home from home comfort wherever you venture. With a specification second to none, befitting its flagship status, the Mercedes chassis is the final piece-de-resistance for unparalleled luxury touring at its very best.



## Vehicle Layout

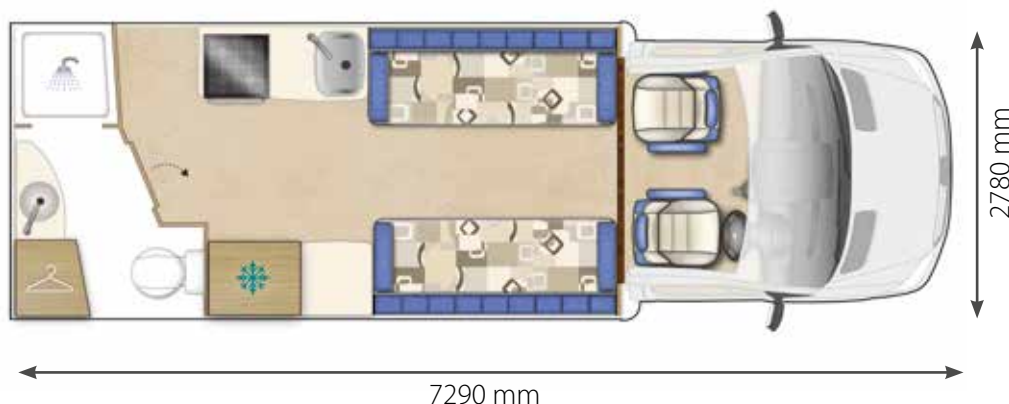

## Sleeping Options

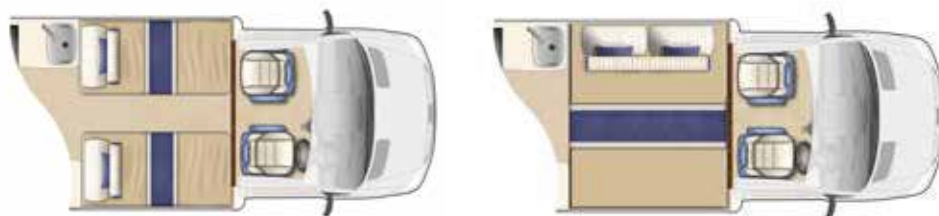

## Key Features

- Superb end washroom and feature kitchen
- Optional 7 speed (163bhp) fully automatic gearbox<sup>#</sup>
- Full Mercedes electrics package: ESP with active skid control & ABS with EBD
- 30W solar panel\*
- External skirt storage locker
- GRP body with scratch & impact resistant platinum sides
- Opening wind-up skyview window
- Panoramic wind-up roof-light
- Thule (Omnistor) canopy awning\*
- Full spectrum reversing camera with permanent feed\*
- Alloy wheels\* plus spare wheel & carrier
- External BBQ & 230v mains sockets
- Safe, fire extinguisher, crockery set & crystal glasses
- USB ports
- 20 litre liquid capacity under floor mounted LPG gas tank



Optional rear travel seats



## Specification

- Vehicle Height - 2860mm
- MTPLM - 3880kg
- MIRO - 3372kg
- Maximum User Payload - 508kg
- Essential Habitation Equipment - 7kg
- Fresh Water Tank - 91ltrs
- Waste Water Tank - 79ltrs

\* Premium Pack <sup>#</sup>Optional



# Malvern - Traditional French Bed

**NEW  
FOR 2015**

The Malvern offers the absolute comfort of a fixed French bed and the stylish luxury Auto-Sleepers are renowned for on a 3500kg chassis. Delivered across a flat level floor, the vans practical layout combines a liberally proportioned front lounge and fully equipped kitchen that is perfect for entertaining at night and can be converted into a large double bed. The pièce de résistance is a luxurious bedroom that with spacious side washroom which boasts a separate shower.



## Vehicle Layout

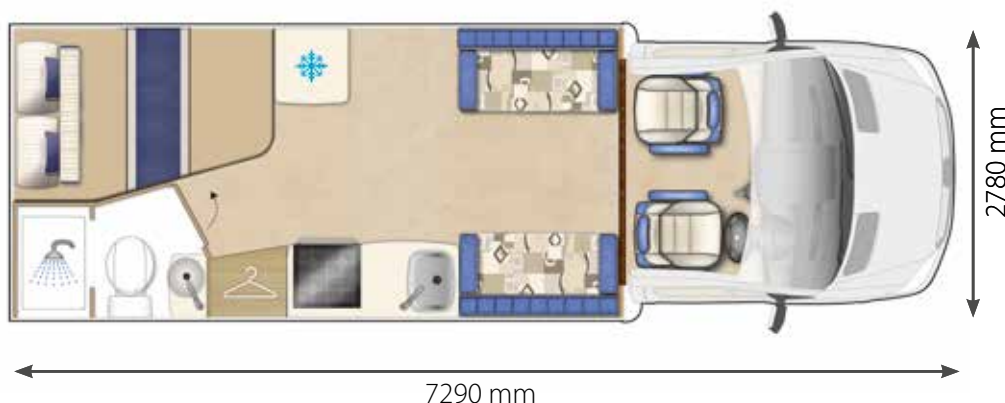

## Sleeping Options



## Key Features

- French bed, luxury kitchen and separate shower
- Optional 7 speed (163bhp) fully automatic gearbox<sup>#</sup>
- Full Mercedes electrics package: ESP with active skid control & ABS with EBD
- 30W solar panel\*
- External skirt storage locker
- GRP body with scratch & impact resistant platinum sides
- Opening wind-up skyview window
- Panoramic wind-up roof-light
- Thule (Omnistor) canopy awning\*
- Full spectrum reversing camera with permanent feed\*
- Alloy wheels\* plus spare wheel & carrier
- External BBQ & 230v mains sockets
- Safe, fire extinguisher, crockery set & crystal glasses
- USB ports
- 20 litre liquid capacity under floor mounted LPG gas tank



Optional  
rear travel  
seats



## Specification

- Vehicle Height - 2860mm
- MTPLM - 3880kg
- MIRO - 3332kg
- Maximum User Payload - 548kg
- Essential Habitation Equipment - 7kg
- Fresh Water Tank - 91ltrs
- Waste Water Tank - 91ltrs

*\* Premium Pack <sup>#</sup>Optional*



# Burford - Fixed Bed Ensuite

The Burford offers aspirational decadence for the discerning owner looking for the space and comfort normally associated with a tag axle Motorhome but crucially on an economically lighter rear wheel drive single axle Mercedes chassis. The front provides a spacious lounge with a fully featured kitchen leading into a true flagship of a rear bedroom with a full width en-suite washroom whilst the Mercedes offers unprecedented driving comfort and is feature packed with computerised driving aids ensuring even the longest journey is a pleasure.



## Vehicle Layout



## Sleeping Options



## Key Features

- Single axle, french bed with large rear washroom
- Optional 7 speed (163bhp) fully automatic gearbox<sup>#</sup>
- Full Mercedes electrics package: ESP with active skid control & ABS with EBD
- 30W solar panel\*
- External skirt storage locker
- GRP body with scratch & impact resistant platinum sides
- Opening wind-up skyview window
- Panoramic wind-up roof-light
- Thule (Omnistor) canopy awning\*
- Full spectrum reversing camera with permanent feed\*
- Alloy wheels\* plus spare wheel & carrier
- External BBQ & 230v mains sockets
- Safe, fire extinguisher, crockery set & crystal glasses
- USB ports
- 20 litre liquid capacity under floor mounted LPG gas tank

## Specification

- Vehicle Height - 2860mm
- MTPLM - 3880/4000kg
- MIRO - 3543kg
- Maximum User Payload - 337/457kg
- Essential Habitation Equipment - 7kg
- Fresh Water Tank - 91ltrs
- Waste Water Tank - 71ltrs



\* Premium Pack <sup>#</sup>Optional



# Burford Duo - *Twin Bed Ensuite*

The Burford Duo offers aspirational decadence for the discerning owner looking for the space and comfort normally associated with a tag axle Motorhome but crucially on an economically lighter rear wheel drive single axle Mercedes chassis. The front provides a spacious lounge with a fully featured kitchen leading into a true flagship of a rear bedroom with spacious single beds and a full width en-suite washroom whilst the Mercedes offers unprecedented driving comfort and is feature packed with computerised driving aids ensuring even the longest journey is a pleasure.



## Vehicle Layout



## Sleeping Options



## Key Features

- Two fixed single beds with large rear washroom
- Optional 7 speed (163bhp) fully automatic gearbox<sup>#</sup>
- Full Mercedes electrics package: ESP with active skid control & ABS with EBD
- 30W solar panel\*
- External skirt storage locker
- GRP body with scratch & impact resistant platinum sides
- Opening wind-up skyview window
- Panoramic wind-up roof-light
- Thule (Omnistor) canopy awning\*
- Full spectrum reversing camera with permanent feed\*
- Alloy wheels\* plus spare wheel & carrier
- External BBQ & 230v mains sockets
- Safe, fire extinguisher, crockery set & crystal glasses
- USB ports
- 20 litre liquid capacity under floor mounted LPG gas tank



## Specification

- Vehicle Height - 2860mm
- MTPLM - 3880/4000kg
- MIRO - 3493kg
- Maximum User Payload - 387/507kg
- Essential Habitation Equipment - 7kg
- Fresh Water Tank - 91ltrs
- Waste Water Tank - 71ltrs

*\* Premium Pack <sup>#</sup>Optional*



# Specification

The Auto-Sleepers Mercedes range offers you a choice of powerful, economical and technically advanced four-cylinder CDI Euro V diesel engines. All CDI diesel engines include a manual transmission as standard. Automatic 7-speed transmission is an option for an even more relaxed drive.

## Leaner

- Reduced fuel consumption
- New generation ignition key with improved functionality

## Meaner

- Engine performance and torque enhancements
- 316CDI 163bhp engine

## Greener

- Improved CO<sup>2</sup> exhaust emissions to 214g/km (163bhp)
- Environmentally friendly diesel particulate filter exhaust systems

## Base Vehicle Specification

- Turbo diesel 163bhp Euro V engine
- Optional upgrade to V6 190bhp Euro V engine<sup>#</sup>
- Optional 7 speed fully automatic gearbox<sup>#</sup>
- Alloy wheels\*
- Cruise control\*
- Cab air conditioning\*
- Adaptive ESP with acceleration skid control
- ABS brakes with EBD

## Safety Features As Standard

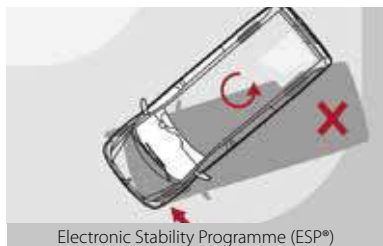

ESP helps the driver stabilise the motorhome in crucial situations - when there is a risk of skidding, for example. The ESP computer compares your intended direction with its actual course. If there is a discrepancy between the driver's instructions and the vehicle's reactions, the system takes corrective action instantly, either by reducing the engine power or by selectively braking one or more wheels.

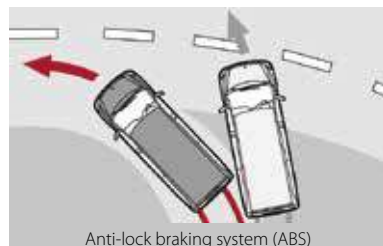

The anti-lock braking system that comes as standard with the Mercedes Sprinter chassis features the latest in advanced technology. When the speed sensors detect that a wheel is on the point of locking up, the brake pressure at the wheel is immediately reduced, keeping the motorhome steerable even during emergency braking.

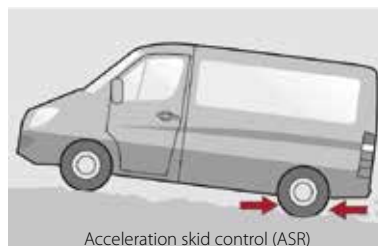

ASR ensures smooth start-off and acceleration, without wheel spin. As soon as one of the drive wheels starts to spin, ASR intervenes to reduce the engine power, and also by gently applying the brake to that wheel, to prevent a loss of traction. The result is improved traction - and safety - especially on slippery surfaces.

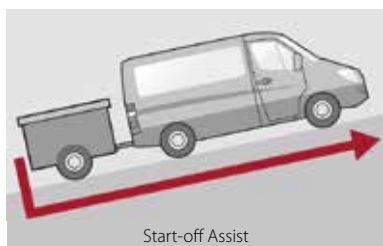

Start-off Assist is fitted as standard to manual transmission models and means you don't have to juggle brake, clutch and handbrake when moving off on uphill or downhill slopes. Once the brake pedal has been released, the brake pressure is maintained for approximately two seconds, allowing you to move off without the vehicle rolling backwards.

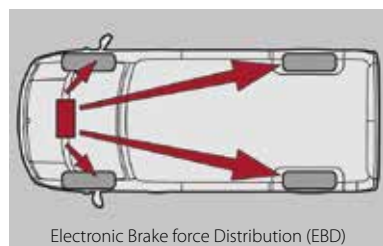

Electronic brake force distribution (EBD) divides up the braking force between the front and rear wheels of the motorhome as required, optimising braking efficiency in all driving situations. In this way the system prevents "overbraking" of the rear wheels, which could cause the vehicle to fishtail. EBD also puts less stress on the front brakes, which reduces the risk of fading due to overheating.

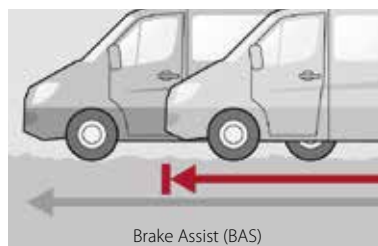

Road and accident research has established even in an emergency, most drivers don't use the full power of the vehicle's brakes. This discovery led Mercedes-Benz to develop the Brake Assist system. By reacting to the speed at which the brake pedal is applied, Brake Assist can detect a situation where emergency braking is required. When that happens the system automatically increases braking power, aided by the anti-lock braking system (ABS) which prevents the wheels from locking up.

## Underfloor Mounted LPG Tank

For 2015 Auto-Sleepers have installed a 20 litre liquid capacity LPG gas tank across the entire range of Mercedes based motorhomes, offering hassle free practicality with numerous benefits including -

- Readily available from 1000's of petrol stations throughout Great Britain and Europe.
- Convenience personified, refilling them is as easy as filling the fuel tank
- No heavy bottles to lift, carry or manhandle
- No middle of the night change overs required
- Economical to use at approximately half the cost of cylinders, cost per litre typically only 75p
- Interior space saving, the tank is externally mounted to the underside of the Motorhome
- Easy read LED tank gauge and an Auto-Stop feature to prevent any chance of overfilling
- Reliable and safety proven, extensively tested for peace of mind and fully approved under European whole vehicle type approval legislation.



LPG Filling Point



LPG Gas Tank

## Upgrades

### Premium Pack

- 7 Speed fully automatic gearbox
- Alloy wheels
- Cab air conditioning
- Cruise control
- Thule Omnistor canopy awning
- Colour reversing camera
- 30W solar panel

### Winter Pack

- Concertina cab blinds in lieu of cab curtains
- Fresh & waste water tank heater blanket
- Truma Combi heater upgrade
- Wheel arch insulation blankets

**TANKBLANKET™**

### Interior General

- Luxurious Amarti furniture with chrome fixtures and fittings
- Panoramic wind-up opening rooflight
- Privacy blinds & flyscreens to all opening windows
- Choice of five Belgium chenille fabrics providing luxurious interior soft furnishings
- High quality Reflex™ foam upholstery
- Colour co-ordinated habitation curtains with tiebacks and scatter cushions
- Removable interior carpets
- LED spotlights and roof lighting with a power saving of up to 70%
- Over locker LED mood lighting
- Seat tops on gas struts and drop down access door to under-seat storage space
- Swivel cab seats on all front lounge models
- Over-cab storage compartments
- Spacious wardrobe
- Range of high & low-level storage lockers.
- Cocktail cabinet with crystal wine glasses
- Freestanding table
- Foot-well entry step with as logo light
- Smoke and carbon monoxide alarms
- Fire extinguisher

### Exterior General

- Full GRP body including roof and rear panel
- Scratch and impact resistant GRP sidewalls available in platinum or white
- Skyview wind up opening rooflight\*\*
- Aluminium skirts
- Large external skirt locker (under-floor mounted)
- Dropdown access door to nearside seating
- 30W solar panel\*
- Optional upgrade to 80W solar panel
- Thule (omnistor) roof mounted canopy awning\*
- LED strip awning light
- Colour co-ordinated external TV socket
- Colour co-ordinated external gas BBQ point
- Colour co-ordinated external 230v mains socket
- Hartal exterior door with central locking
- 20 Litre liquid capacity LPG gas tank
- Double-glazed opening windows with concertina blinds & flyscreens
- Multi directional status tv aerial
- Electric slide-out entrance step with auto retract on engine start
- Rear mud-flaps
- Rear corner steadies

### Electrics and Plumbing

- LCD control panel
- Split charged 105 amp leisure battery
- Four 230v sockets
- Two 12v sockets
- Electric hook up lead
- Truma dual fuel combi blown air central heating and water heater
- Submersible water pump
- 71 Litre fresh water tank
- 53 Litre waste water tank
- Large bore waste pipework for efficient drainage
- Whale auto-fill & manual filler for fresh water tank

### Kitchen

- Spacious and fully equipped with large slide out additional work surface
- Dual fuel hob with 3 gas burners and an electric hot plate plus
- Separate oven and grill
- Dual level microwave oven
- 12v extractor fan with down-lighters
- Large refrigerator with freezer compartment

### Bathroom

- Combined shower and toilet compartment
- Swing wall showers with integrated washbasin
- Vanity cupboard with mirrors
- Separate shower cubicle (Winchcombe, Burford and Burford duo)
- Electric flush cassette toilet with separate header tank
- Chrome fixtures and fittings
- Storage cupboard
- Anti slip shower mat
- Ducted blown air outlet
- LED lighting
- Retractable clothesline (model specific)
- Roof vent with flyscreen

*\*Premium pack \*\*Low Profile roof only #Optional*

# Coachbuilt Personalisation

## Roof Options

Peugeot and Mercedes-Benz coachbuilt models are available with a choice of two roof options, available at no extra cost.

### Luton

The overcab luton offers additional sleeping accommodation for two people



### Low Profile

The lowline roof is available with either a large opening skyview rooflight or additional locker storage.



## Fabric Options

Every Auto-Sleeper comes with a choice of colourways from the latest range of handpicked Belgian 'Moonstone' fabrics, providing a luxurious finish for that added personal touch.

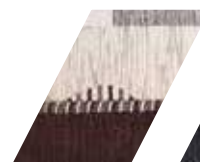

Moonstone  
Berry



Moonstone  
Blue



Moonstone  
Mocha



Moonstone  
Forest



Moonstone  
Caramel

## Seating Options

Selected Coachbuilt models\* are available with the option of two rear seating configurations. Choose from either twin benches, creating a spacious lounge or additional rear travelling seats\*\*, which allow for extra passengers to be transported in the rear safely.



Twin Bench Lounge



Additional Rear Travelling Seats

\* Excluding Broadway EL Duo \*\* Additional cost option

## Seat Belt Safety

Seat belts for the front cab seats in motorhomes have always been installed by the base vehicle manufacturer since the law required them to do so and wearing them is a legal requirement whenever the vehicle is being driven.

Seat belts in the rear of a motorhomes however is more complicated; where a designated travelling seat is available it must be used, however, where there isn't one it's not illegal to travel in the rear without wearing one at present, although this could well change in the future.

In the interests of everyone's safety and peace of mind, Auto-Sleepers always recommend when travelling in the rear of a motorhome, it should be in a designated travelling seat with the three point seat-belts in use.

Look out for the red seat-belt symbol next to the layout to indicate the availability of designated rear travel seats which have been tested and approved as fully compliant with european whole vehicle type approval for your total safety and peace of mind.



Situation	Front Seat	Rear Seat	Responsibility
Driver	Seat belt must be worn if fitted	-	Driver
Child under 3 years of age	Seat belt must be worn if fitted	Correct child restraint must be used	Driver
Child from 3rd birthday up to 135cm in height or 12th birthday, whichever they reach first.	Correct child restraint must be used	Correct child restraint must be used where seatbelts are fitted. Must use adult belt in rear seat if correct child restraint is not available.	Driver
Child 12 or 13 years of age or over 135cm in height	Seat belt must be worn if fitted	Seat belt must be worn if fitted	Driver
Adult passengers	Seat belt must be worn if fitted	Seat belt must be worn if fitted	Passenger



# Grade 3 Insulation



Auto-Sleepers have received a major boost for its new 2015 motorhome range with news their range of prestigious award winning van conversion models successfully achieved the Grade III classification for heating and thermal insulation. This means that every model from the Cotswold manufacturer excels in any environment to deliver luxurious year round touring comfort.

The classification was achieved after completing rigorous testing inside Truma's state of the art Cold Chamber facility in Derby. Here the vehicles were subjected to extreme temperatures of -15°C, which is extremely challenging for an all steel body to overcome as it absorbs the cold and fights the heating system.

In order to achieve Grade III status, the centre of the interior must achieve a minimum temperature of +20°C within a 4 hour period despite the freezing temperatures surrounding the vehicle throughout the test. Auto-Sleepers new tank heater blankets, which form part of the new winter pack, allow for free flowing water meaning Auto-Sleeper will excel in any environment for true motorhoming freedom.



## Tomorrows Paint Protection - Today

G-3 Glasscoat is a complex formula, ceramic hardened glass finish, that bonds to your motorhome's paint surface. It's ceramic technology ensures that the product also demonstrates some self cleaning properties. G-3 Glasscoat repels liquids and is extremely resilient to all kinds of damage. Damage caused by acid rain, pollution, solvents and road salt are no longer an issue. It possesses an exceptional ability to resist the effects of car washes, solvents, animal and vegetable deposits.

## No Maintenance Means Peace Of Mind

In our opinion, products requiring conservers, topups, polishing or general maintenance are inadequate and unsuitable for their purpose, and do not provide consumers with value for money.

G-3 Glasscoat is upto 4 times thicker than existing flouro polymer type protectors, and is 10 times more durable than most other products. This unsurpassable and consistent performance means that only G-3 Glasscoat comes with a standard 5 year guarantee. No conservers or polish wax maintenance are required.

## Advanced Technology

The Gen-3 Glasscoat protection system utilises technology so advanced NASA used it for their space program. It delivers exceptional potection in extreme temperatures and the very harshest of environments.

PROTECTION FROM	G-3 GLASSCOAT GENERATION 3
HOT WATER	★★★★★
COLD WATER / FROST	★★★★★
ACID / ACID RAIN	★★★★★
ANIMAL & VEGETABLE DEPOSITS	★★★★★
HYDROCARBONS	★★★★★
ENVIRONMENTALLY FRIENDLY	★★★★★
SOLVENTS	★★★★★

## Exceptional protection inside too

As well as providing market leading protection, for your paint, glass & alloy wheels, the G-3 Protection Collection comes complete with world class stain proofing, to ensure that your interior stays as good as new too.

For more information on having your Auto-Sleepers motorhome protected with Gen-3 Glasscoat contact Paintseal Direct on 01283 703777 or visit: [www.paintsealdirect.com/auto-sleepers](http://www.paintsealdirect.com/auto-sleepers)



Gen-3 Glasscoat from Paintseal Direct is the only protection recommended by Auto-Sleeper to provide the ultimate protection on your new Motorhome, ask for it by name to avoid imitations

# No ordinary company. No ordinary motorhomes.

Auto-Sleepers has over 53 years experience in meeting the needs of customers who are looking for the best in British-built motorhomes. Based at Willersey in the Cotswolds, we still take great pride in our hand craftsmanship and design expertise. Great time, care and effort go into the making of an Auto-Sleepers motorhomes and it shows. The furniture, fittings and fitments are all of the highest quality, modern and stylish coupled with quality and innovation, all hand built to offer many years of pleasure. And because our designers use and live with our motorhomes, they know from experience what works and how to make the best use of every cubic centimetre of interior space. That's why so many of our customers keep coming back to us.



## BRAND NEW FOR 2015

**Optional Fiat Ducato 130bhp Comfort-Matic Gearbox on all Auto-Sleeper 2015 Peugeot Models**

Comfort-Matic, the gearbox that ensures an easy, fuel-efficient drive and respects the environment.

The robotic gearbox works for you, offering the strength and precision of a manual gearbox, with the comfort and ease of an automatic gearbox.

The Comfort-Matic also comes with a number of special features designed specifically for motorhomes.

With the Comfort-matic installed all that is left to do is ...

## Enjoy!

## Owners' Club

The Auto-Sleepers Owners' Club was formed in 1989 and now has a membership exceeding 5,000. Closely allied with the Company, membership of the Club is open to all Auto-Sleepers owners. Benefits include a monthly newsletter and rallies throughout the year, both at home and abroad. Enquiry forms are available through the Company or by visiting the club website.



[www.asoc.uk.com](http://www.asoc.uk.com)

For full specification on the Comfort-Matic please visit: [https://www.fiatcamper.com/product/comfort\\_matic](https://www.fiatcamper.com/product/comfort_matic)

# Warranty



*“You can be confident about owning an Auto-Sleepers, because we are confident about the way we build them”*

## Auto-Sleepers Conversion Warranty

---

You can be confident about owning an Auto-Sleepers, because we are confident about the way in which we build them. The conversion work of every Auto-Sleepers is covered by our own two year warranty scheme. The cover is not restricted to mileage and protects all aspects of the conversion. Terms and conditions apply, please refer to your handbook for further information.

## Mercedes-Benz Warranty

---

The base of your motorhome is covered by Mercedes-Benz. You are covered by a 3 year, unlimited mileage warranty (terms and conditions apply, please refer to the chassis manufacturers handbook for details). Because your new Mercedes-Benz is one of the most advanced chassis on the market today, we go to great lengths to provide an equally superior warranty. For these reasons alone, Mercedes-Benz chassis warranties really do go further. Under our cover, your van is safe and secure. With over 100 dealers in the UK and 3,000 more in 29 countries around Europe, the benefits of MobilityGo are always close by.

MobilityGo covers you in two main areas; starting problems or mechanical breakdown out on the road.

If either of the above situations occur, MobilityGo entitles you to speedy roadside assistance, and if the problem cannot be quickly resolved, recovery to the nearest Mercedes-Benz dealer. From here - and depending upon your requirements - the dealer may offer you:

- Use of a taxi, or public transport up to the value of £55 inc. VAT
- Vehicle collection and delivery, within a 25 mile radius
- Provision of alternative transport, within 25 miles of the dealership
- A replacement vehicle for up to five days (Subject to availability)

## Peugeot Warranty

---

All motorhomes first registered in the UK and purchased from a UK Peugeot Approved Manufacturer benefit from a Peugeot 3 Year unlimited mileage warranty and an 8 year paint guarantee provided by the Peugeot Dealer Network in the UK. This additional warranty carries a mileage limit of 100,000 miles from first registration and is dependent upon the manufacturer's recommended servicing being carried out at the specified time or distance intervals. For full terms and conditions, please consult your Peugeot Dealer in the UK.

All new Peugeot motorhomes come with 12 months' Peugeot Assistance - breakdown assistance service. Peugeot Assistance includes European cover, homestart, roadside assistance, vehicle recovery and a free replacement car or hotel accommodation if required. For this service call 0800 294 0294

## Volkswagen 3 Year Whole Warranty

---

Consisting of a two year unlimited mileage manufacturer's warranty and one year Van Centre warranty. In the third year the warranty continues until a maximum of 100,000 miles. Third year is only available on vehicles purchased and registered in the UK through an approved Volkswagen "Specialist Converter", an approved Volkswagen motorhome dealer or a Volkswagen Van Centre. Warranty excludes non-durable parts such as brakes and clutch.

In the unlikely event of a breakdown, your vehicle is covered by a comprehensive roadside assistance package. Anyone driving the vehicle, with your permission, is also covered. The service operates 24 hours a day, 365 days a year. Three year UK roadside assistance provided by Volkswagen Emergency Assistance is subject to terms and conditions. Further details are available on request from your nearest Volkswagen Van Centre.

# Service

Open: Monday - Friday, 7:30am - 5pm

## Auto-Sleepers Aftercare & Service Centre

The Auto-Sleepers Service Centre caters specifically for the needs of the motorhome and caravan owner. Located on site at the Auto-Sleepers factory in Willersey, Worcestershire, we offer mechanical and conversion servicing, accident and insurance repairs, annual habitation checks, MOT testing, accessory fittings, modifications and refurbishments.



The Service Centre is manned by experienced, fully trained staff most of whom have completed many years service with the company. Although specialising in Auto-Sleepers models, work can be carried out on any type of vehicle or caravan irrespective of make but please note we are unable to undertake warranty work on other manufacturers vehicles.

Our most popular services offer two levels of mechanical servicing on motorhomes and the annual habitation checks. The Silver service for vehicles covering less than 10,000 miles per year and the Gold service for vehicles covering a higher mileage. Each option provides thorough inspection and maintenance of the vehicle including tyre and brake fluid checks, oil and filter changes and road testing (motorhomes). The habitation checks cover the rest of the motorhomes/caravan chassis, body, fixtures, fittings and includes full gas and electric system checks.

We offer modifications to customers' motorhome requirements, for example changing of seating configuration from dinette to bench seat and visa versa, additional water tanks, Side access hatches, additional work surfaces and bespoke tables and cabinets. In addition we can convert many 2 berth models to 4 berths or the reverse if required and we also offer upgrades to water and heating systems.

Service Department +44 (0) 1386 853511

## Auto-Sleepers Parts Department

The Auto-Sleepers Parts Department aims to provide parts for Auto-Sleepers old and new. When contacting this Department, customers should have to hand the Auto-Sleepers production number of their vehicle. We endeavour to provide parts for older vehicles, but are unable to guarantee to supply parts that are no longer manufactured by our suppliers.

Parts Department +44 (0) 1386 842630



# Weights & Dimensions

Weights & Dimensions	VAN CONVERSIONS									
	Volkswagen TOPAZ		Mercedes-Benz		Peugeot					
			WAVE	WAVE HL	SYMBOL	WINDRUSH	WARWICK DUO	KEMERTON XL	KINGHAM	WARWICK XL
Engine	140bhp Manual	140bhp Auto	136PS	136PS	150bhp	150bhp	150bhp	150bhp	150bhp	150bhp
Roof profile (low or overcab)	-		Pop Top	High Top	-	-	-	-	-	-
Designated Passenger Seats (excl. driver)	2		3	3	2	3	1	2	1	1
Berths (sleeping positions)	2		4	2	2	4	2	2	2	2
Overall Length in mm	5290mm 17'4"		5008mm 16'5"	5008mm 16'5"	5413mm 17'9"	5998mm 19'8"	5998mm 19'8"	6363mm 20' 11"	6363mm 20' 11"	6363mm 20' 11"
Overall Width (mirrors folded)	2045mm 6'9"		2025mm 6'8"	2025mm 6'8"	2260mm 7'5"	2260mm 7'5"	2260mm 7'5"	2260mm 7'5"	2260mm 7'5"	2260mm 7'5"
Overall Width (mirrors extended)	2245mm 7'4"		2265mm 7'5"	2265mm 7'5"	2508mm 8'3"	2508mm 8'3"	2508mm 8'3"	2508mm 8'3"	2508mm 8'3"	2508mm 8'3"
Overall Height (incl TV aerial, except WAVE models)	2675mm 8'9"		2000mm 6'7"	2535mm 8'4"	2640mm 8'8"	2700mm 8'10"	2640mm 8'8"	2640mm 8'8"	2640mm 8'8"	2640mm 8'8"
Internal Height (max)	1900mm 6'3"		2270mm 7'5"	1880mm 6'2"	1900mm 6'3"	1900mm 6'3"	1900mm 6'3"	1900mm 6'3"	1900mm 6'3"	1900mm 6'3"
Maximum Permissible Laden Mass (a) in kg	3200	3200	3000	3050	3300	3500	3500	3500	3500	3500
Mass in Running Order (b) in kg*	2618	2643	2547	2596	2896	3004	2938	3135	3148	3112
Maximum User Payload (c) (c=a-b) in kg**	582	557	453	454	404	496	562	365	352	388
Essential Habitation Equipment (d) in kg	0	0	0	0	0	0	15	15	0	0
Fresh Water Tank Size/Waste Water Tank Size	68 litres/ 57 litres		32 litres / 28 litres	32 litres / 28 litres	69 litres/ 40 litres	69 litres/ 40 litres	69 litres/ 40 litres	69 litres/ 40 litres	69 litres/ 40 litres	69 litres/ 40 litres
Bed Sizes										
Front Double	1740 x 1620mm 5'9" x 5'4"		-	-	1860 x 1460mm 6'1" x 4'9"	1880 x 1470mm 6'2" x 4'10"	-	1980 x 1880mm 6'6" x 6'2"	-	-
Rear Double	-		-	-	-	-	1870 x 1850mm 6'2" x 6'1"	-	1900 x 1200mm 6'3" x 4'0"	1870 x 1920mm 6'2" x 6'4"
Nearside Single	1770 x 600mm 5'10" x 2'0"		1890 x 600mm 6'2" x 2'0"	1890 x 600mm 6'2" x 2'0"	1940 x 630mm 6'4" x 2'1"	-	1850 x 680mm 6'1" x 2'3"	1980 x 680mm 6'6" x 2'3"	-	1920 x 700 6'4" x 2'4"
Offside Single	1740 x 600mm 5'9" x 2'0"		1780 x 600mm 5'10" x 2'0"	1780 x 600mm 5'10" x 2'0"	1715 x 700mm 5'8" x 2'4"	-	1850 x 680mm 6'1" x 2'3"	2050 x 700 6'9" x 2'4"	-	1920 x 700mm 6'4" x 2'4"
Twin Rear bunk beds	-		-	-	-	1800 x 600mm 5'11" x 2'0"	-	-	-	-
Roof Bed	-		1775 x 1070mm 5'10" x 3'6"	-	-	-	-	-	-	-
	*The Mass In Running Order is the mass of the unladen vehicle including a 75kg allowance for the driver plus engine coolants and 90% of the fuel, gas and water tanks capacity.									

## COACHBUILTS

	Peugeot							Mercedes-Benz								
	NUEVO EK	NUEVO ES	BROADWAY EK	BROADWAY EK TB LP	BROADWAY FB	BROADWAY EL DUO	BROADWAY EB	STANTON		BOURTON	WINCHCOMBE	MALVERN	BURFORD		BURFORD DUO	
	150bhp	150bhp	150bhp	150bhp	150bhp	150bhp	150bhp	163bhp Auto	163bhp Auto Weight upgrade	163bhp Auto	163bhp Auto	163bhp Auto	163bhp Auto	163bhp Auto Weight upgrade	163bhp Auto	163bhp Auto Weight upgrade
	Low	Overcab	Overcab	Low	Low	Low	Low	Low		Low	Low	Low	Low		Low	
	1	3	3	1	1	1	1	1		1	1	1	1		1	
	2	4	4	2	4	2	2	2		2	2	4	4		4	
	5712mm 18'9"	5712mm 18'9"	6280mm 20'7"	6280mm 20'7"	7165mm 23'6"	7165mm 23'6"	6280mm 20'7"	5940mm 19'6"		6445mm 21'2"	7290mm 23'11"	7290mm 23'11"		7880mm 25'10"		7880mm 25'10"
	2320mm 7'7"	2320mm 7'7"	2320mm 7'7"	2320mm 7'7"	2320mm 7'7"	2320mm 7'7"	2320mm 7'7"	2260mm 7'5"		2260mm 7'5"	2350mm 7'9"	2350mm 7'9"		2350mm 7'9"		2350mm 7'9"
	2690mm 8'10"	2690mm 8'10"	2690mm 8'10"	2690mm 8'10"	2690mm 8'10"	2690mm 8'10"	2690mm 8'10"	2660mm 8'9"		2660mm 8'9"	2780mm 9'1"	2780mm 9'1"		2780mm 9'1"		2780mm 9'1"
	2875mm 9'5"	3005mm 9'10"	3005mm 9'10"	2970mm 9'9"	2930mm 9'7"	2930mm 9'7"	2970mm 9'9"	2850mm 9'4"		2860mm 9'5"	2880mm 9'6"	2860mm 9'5"		2880mm 9'6"		2880mm 9'6"
	1960mm 6'5"	1960mm 6'5"	1960mm 6'5"	1960mm 6'5"	1960mm 6'5"	1960mm 6'5"	1960mm 6'5"	1960mm 6'5"		1960mm 6'5"	1960mm 6'5"	1960mm 6'5"		1960mm 6'5"		1960mm 6'5"
	3300	3500	3500	3500	3500	3500	3500	3200	3500	3500	3880	3880	3880	4000	3880	4000
	2935	3047	3126	3080	3223	3222	3101	2941		3082	3293	3332	3543	3543	3493	3493
	365	453	374	420	277	278	399	259	559	418	587	548	337	457	387	507
	7	7	7	7	15	15	7	7		7	15	7	7		7	
	102 litres/ 71 litres	102 litres/ 71 litres	102 litres/ 71 litres	102 litres/ 71 litres	102 litres/ 91 litres	102 litres/ 78 litres	102 litres/ 71 litres	71 litres/53 litres		62 litres/ 53 litres	91 litres/ 71 litres	91 litres/ 78 litres	91 litres/ 91 litres		91 litres/ 91 litres	
	2100 x 1380mm 6'11" x 4'6"	2100 x 1380mm 6'11" x 4'6"	2100 x 1840 6'11" x 6'0"	2100 x 1930mm 6'11" x 6'4"	2100 x 1220mm 6'11" x 4'0"	-	2100 x 1350mm 6'11" x 4'5"	2100 x 1400mm 6'11" x 4'7"		2100 x 1920mm 6'11" x 6'4"	2200 x 1900mm 7'3" x 6'3"	2210 x 1220mm 7'3" x 4'0"	2210 x 1220mm 7'3" x 4'0"		2210 x 1220mm 7'3" x 4'0"	
	-	-	-	-	1940 x 1250mm 6'11" x 4'1"	2100 x 1250mm 6'11" x 4'1"	-	-		-	-	1980 x 1370mm 6'6" x 4'6"	1980 x 1370mm 6'6" x 4'6"		-	
	1900 x 700mm 6'3" x 2'4"	1900 x 700mm 6'3" x 2'4"	1930 x 680mm 6'4" x 2'3"	1930 x 700mm 6'4" x 2'4"	-	2000 x 700mm 6'7" x 2'4"	1930 x 700mm 6'4" x 2'4"	1930 x 700 6'4" x 2'4"		1920 x 730mm 6'4" x 2'5"	1940 x 700mm 6'4" x 2'4"		-		1920 x 730mm 6'4" x 2'5"	
	1880 x 700mm 6'2" x 2'4"	1800 x 900mm 5'11" x 2'11"	1840 x 930mm 6'0" x 3'1"	1860 x 700mm 6'1" x 2'4"	-	1880 x 700mm 6'2" x 2'4"	1930 x 700mm 6'4" x 2'4"	1930 x 700 6'4" x 2'4"		1920 x 730mm 6'4" x 2'5"	1900 x 700mm 6'3" x 2'4"				1840 x 780mm 6'0 x 2'7"	
	-	-	-	-	-	-	-	-		-	-	-	-		-	
	-	1940 x 1280 6'4" x 4'2"	1940 x 1280 6'4" x 4'2"	-	-	-	-	-		-	-	-	-		-	

\*\*The Maximum User Payload includes:

- Conventional load, is the allowance for passengers
- Essential habitation equipment includes items and/or fluids required for safe and proper functioning of the habitation equipment.

- Optional equipment is items available from the manufacturer over and above the standard specification.
- Personal effects, items not effected by the above.